

General Notes

- The Contractor is to be responsible for verifying all dimensions and levels on site before commencing work.
 - All figured dimensions are to be taken in preference to any scaled dimensions.
 - Any discrepancies are to be reported to Matthew D Jones Architectural Services before proceeding with the work.
 - All works are to comply fully with current Building Regulations, Codes of Practice, British Standards and the principals of protection and prevention in line with the requirements of the CDM 2015 Regulations.
 - All specialist details are to be checked and approved by Building Control, prior to commencement of such work.
- The Construction (Design and Management) Regulations 2015:-
- In compliance with the CDM Regulations, the Designer has a statutory responsibility to inform the Client of their necessary obligations.
 - It is the client's statutory responsibility to appoint a Principal Designer and a Principal Contractor for the project when the regulations apply.
 - The client should contact Matthew D Jones Architectural Services to ascertain whether the regulations are applicable for this project.
 - The CDM Regulations are a statutory requirement.
- The Party Wall etc. Act 1996:-
- If you intend to carry out building work which involves one of the following categories:-
 - * work on an existing wall or structure shared with another property.
 - * building a free standing wall or a wall of a building, up to or astride the boundary with a neighbouring property.
 - * excavating near a neighbouring building.
- It is essential you seek professional advice at an early stage of the project, to identify whether the work falls within the scope of the Act. If the Act applies it is the law that you must notify all affected neighbours.
- If you start works without having first given notice in the proper way, adjoining owners may seek to stop your work through a court injunction or seek other legal redress.
- Copyright:-
- The copyright of this drawing remains with Matthew D Jones Architectural Services. No reproduction of information (in part or in whole) without prior permission from Matthew D Jones Architectural Services is permitted.

| No. | Revision | Date |
|-----|-------------------|-------|
| F | Client amendments | 11/23 |
| E | Client amendments | 05/23 |
| D | Section Added | 04/23 |
| C | Client Amendments | 01/23 |
| B | Client Amendments | 12/22 |
| A | Client Amendments | 11/22 |

Client
Mr & Mrs Newman

Project
**Proposed Dwelling
Adjacent
Windy Ridge
Bouldnor Road
Yarmouth
Isle of Wight**

Drawing Title
Planning Proposals

**MATTHEW D. JONES
ARCHITECTURAL SERVICES**

01983 612700
admin@mdjarchitecturalservices.co.uk
mdjarchitecturalservices.co.uk

Fortis House, Cothey Way, Ryde, Isle of Wight, PO33 1QT

| | |
|-------------|----------------|
| Scale | 1 / 50 1 / 100 |
| Date | Sept 2022 |
| Drawing No. | 23 - 930 - 01 |
| Rev. | F |



General Notes

1. The Contractor is to be responsible for verifying all dimensions and levels on site before commencing work.
2. All figured dimensions are to be taken in preference to any scaled dimensions.
3. Any discrepancies are to be reported to Matthew D Jones Architectural Services before proceeding with the work.
4. All works are to comply fully with current Building Regulations, Codes of Practice, British Standards and the principals of protection and prevention in line with the requirements of the CDM 2015 Regulations.
5. All specialist details are to be checked and approved by Building Control, prior to commencement of such work.

The Construction (Design and Management) Regulations 2015:-

1. In compliance with the CDM Regulations, the Designer has a statutory responsibility to inform the Client of their necessary obligations.
2. It is the client's statutory responsibility to appoint a Principal Designer and a Principal Contractor for the project when the regulations apply.
3. The client should contact Matthew D Jones Architectural Services to ascertain whether the regulations are applicable for this project.
4. The CDM Regulations are a statutory requirement.

The Party Wall etc. Act 1996:-

1. If you intend to carry out building work which involves one of the following categories:-

- * work on an existing wall or structure shared with another property.
- * building a free standing wall or a wall of a building, up to or astride the boundary with a neighbouring property.
- * excavating near a neighbouring building.

It is essential you seek professional advice at an early stage of the project, to identify whether the work falls within the scope of the Act. If the Act applies it is the law that you must notify all affected neighbours.

2. If you start works without having first given notice in the proper way, adjoining owners may seek to stop your work through a court injunction or seek other legal redress.

Copyright:-

The copyright of this drawing remains with Matthew D Jones Architectural Services. No reproduction of information (in part or in whole) without prior permission from Matthew D Jones Architectural Services is permitted.

| No. | Revision | Date |
|-----|-------------------|-------|
| B | Client amendments | 11/23 |
| A | Client amendments | 05/23 |

Client
Mr & Mrs Newman

Project
**Proposed Dwelling
Adjacent
Windy Ridge
Bouldnor Road
Yarmouth
Isle of Wight**

Drawing Title
Illustrative Perspectives



01983 612700
admin@mdjarchitecturalservices.co.uk
mdjarchitecturalservices.co.uk
Fortis House, Cothey Way, Ryde, Isle of Wight, PO33 1QT

| | | | |
|-------------|---------------|------|---|
| Scale | NTS | | |
| Date | Jan 23 | | |
| Drawing No. | 23 - 930 - 03 | Rev. | B |



WINDY RIDGE



PROPOSED DWELLING

Proposed Street Scene 1 / 100

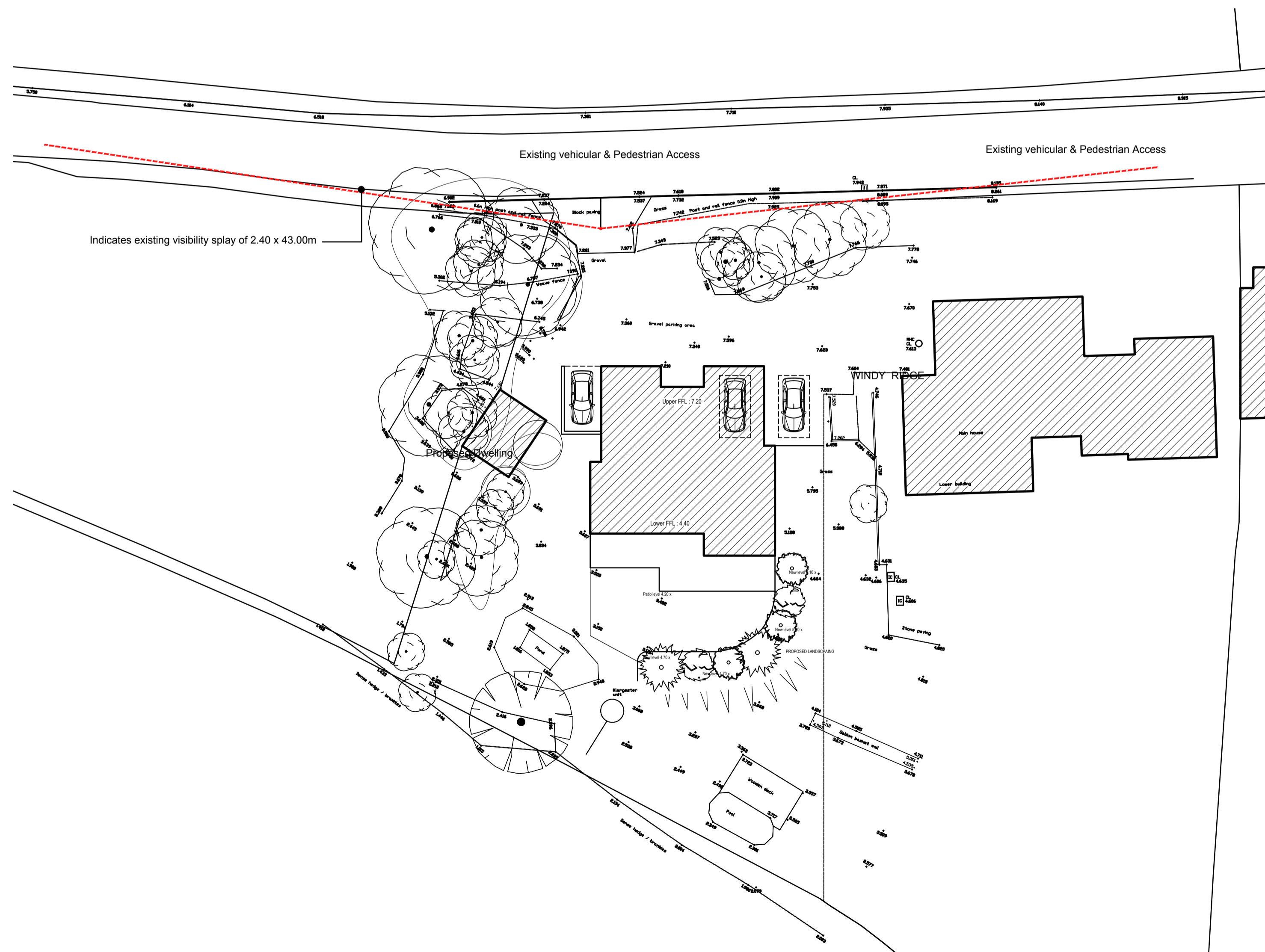

Proposed Site Plan 1 / 250

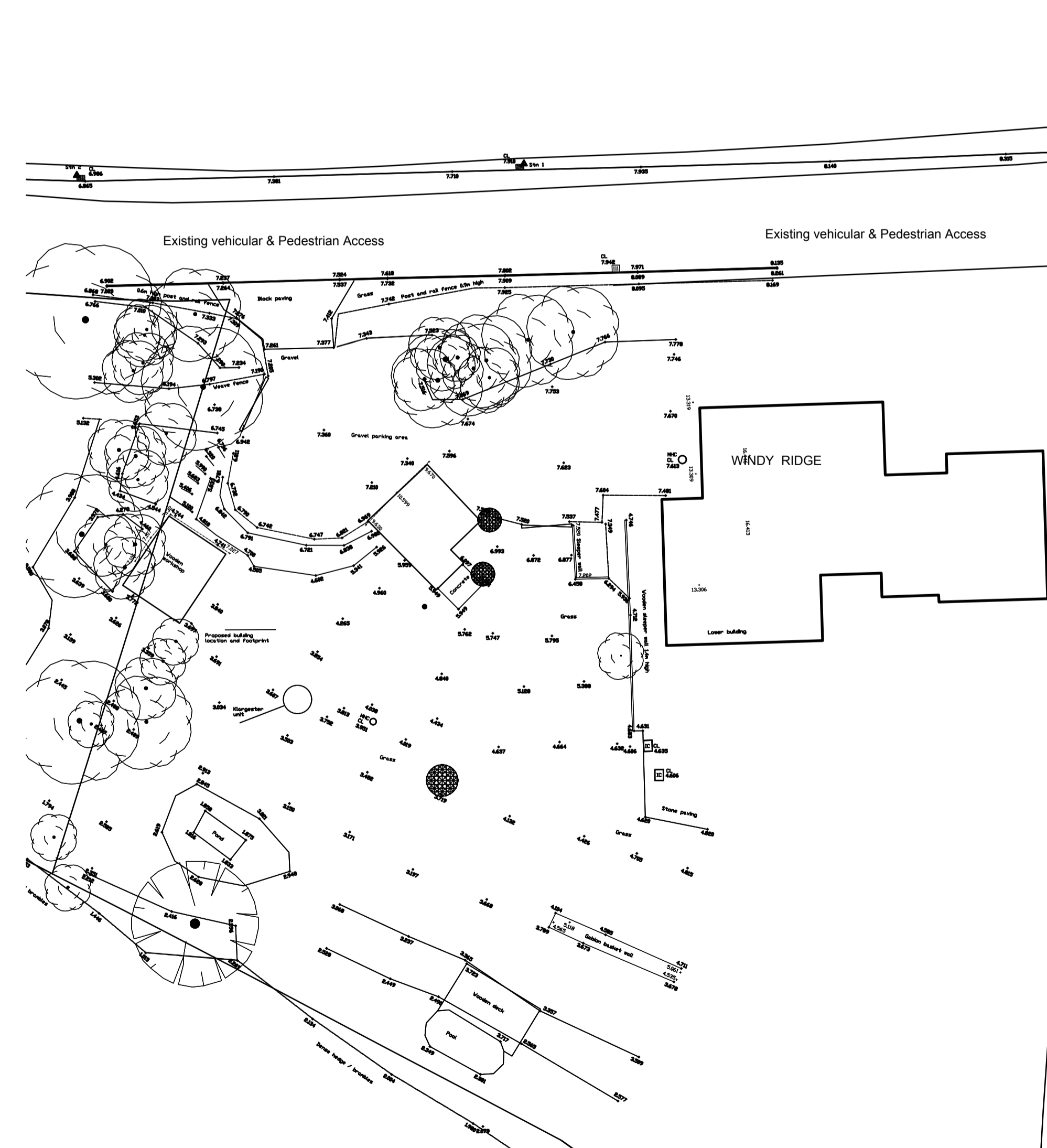

Existing Site Plan 1 / 250

General Notes

1. The Contractor is to be responsible for verifying all dimensions and levels on site before commencing work.
2. All figured dimensions are to be taken in preference to any scaled dimensions.
3. Any discrepancies are to be reported to Matthew D Jones Architectural Services before proceeding with the work.
4. All works are to comply fully with current Building Regulations, Codes of Practice, British Standards and the principals of protection and prevention in line with the requirements of the CDM 2015 Regulations.
5. All specialist details are to be checked and approved by Building Control, prior to commencement of such work.

The Construction (Design and Management) Regulations 2015:-

1. In compliance with the CDM Regulations, the Designer has a statutory responsibility to inform the Client of their necessary obligations.
2. It is the client's statutory responsibility to appoint a Principal Designer and a Principal Contractor for the project when the regulations apply.
3. The client should contact Matthew D Jones Architectural Services to ascertain whether the regulations are applicable for this project.
4. The CDM Regulations are a statutory requirement.

The Party Wall etc. Act 1996:-

1. If you intend to carry out building work which involves one of the following categories:-

- * work on an existing wall or structure shared with another property.
- * building a free standing wall or a wall of a building, up to or astride the boundary with a neighbouring property.
- * excavating near a neighbouring building.

It is essential you seek professional advice at an early stage of the project, to identify whether the work falls within the scope of the Act. If the Act applies it is the law that you must notify all affected neighbours.

2. If you start works without having first given notice in the proper way, adjoining owners may seek to stop your work through a court injunction or seek other legal redress.

Copyright:-

The copyright of this drawing remains with Matthew D Jones Architectural Services. No reproduction of information (in part or in whole) without prior permission from Matthew D Jones Architectural Services is permitted.

| No. | Revision | Date |
|-----|------------------------|-------|
| B | Visibility Splay added | 12/23 |
| A | Client amendments | 05/23 |

Client
Mr & Mrs Newman

Project
**Proposed Dwelling
Adjacent
Windy Ridge
Bouldnor Road
Yarmouth
Isle of Wight**

Drawing Title
Site Plans & Street Scene



MATTHEW D. JONES
ARCHITECTURAL SERVICES
01983 612700
admin@mdjarchitecturalservices.co.uk
mdjarchitecturalservices.co.uk
Fortis House, Cothey Way, Ryde, Isle of Wight, PO33 1QT

| | |
|-------------|-----------------|
| Scale | 1 / 250 1 / 100 |
| Date | Jan 23 |
| Drawing No. | 23 - 930 - 02 |
| Rev. | B |

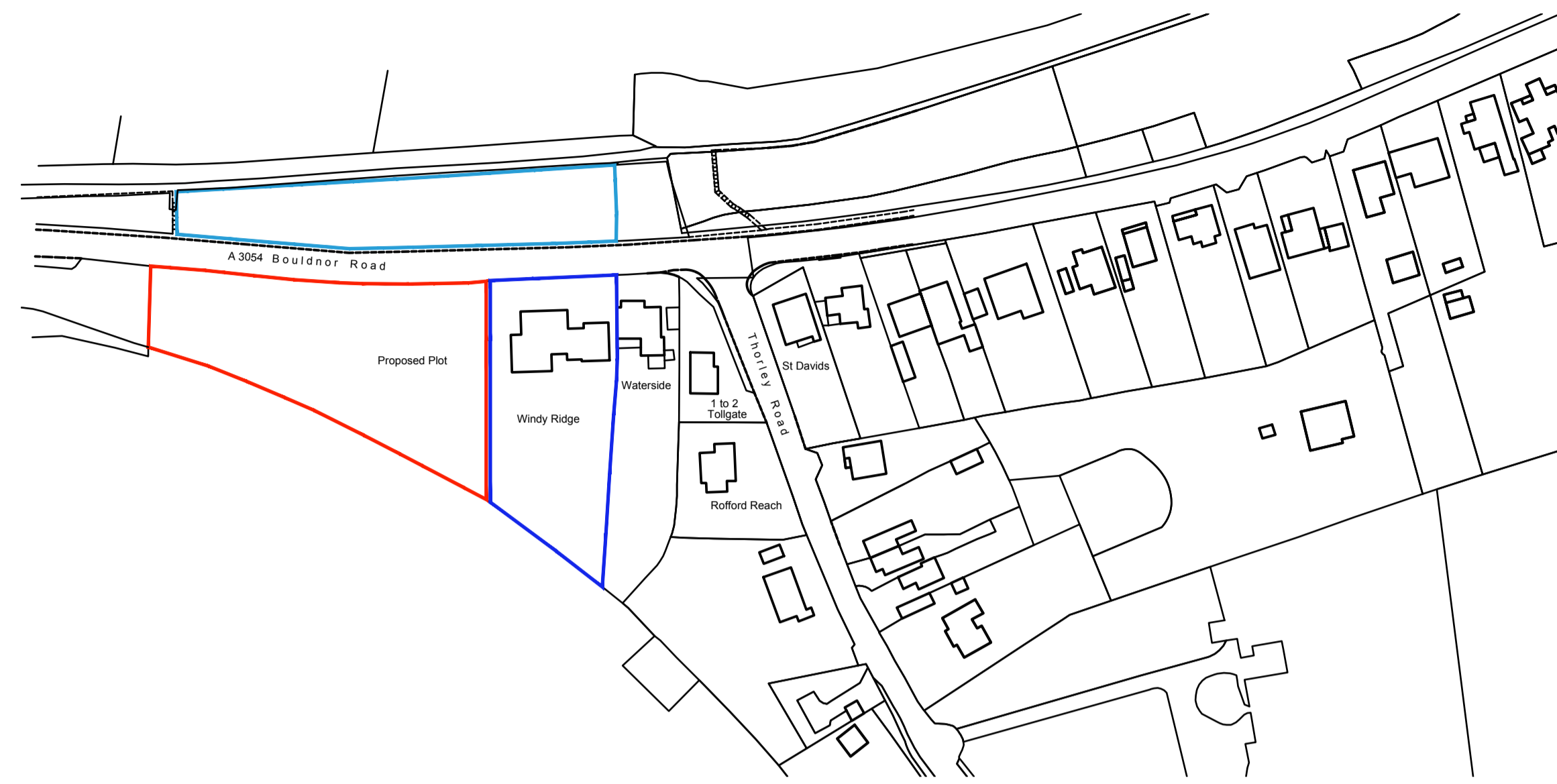

Site Location Plan 1 / 1250

Ordnance Survey (c) Crown Copyright. All rights reserved. Licence number 100022432

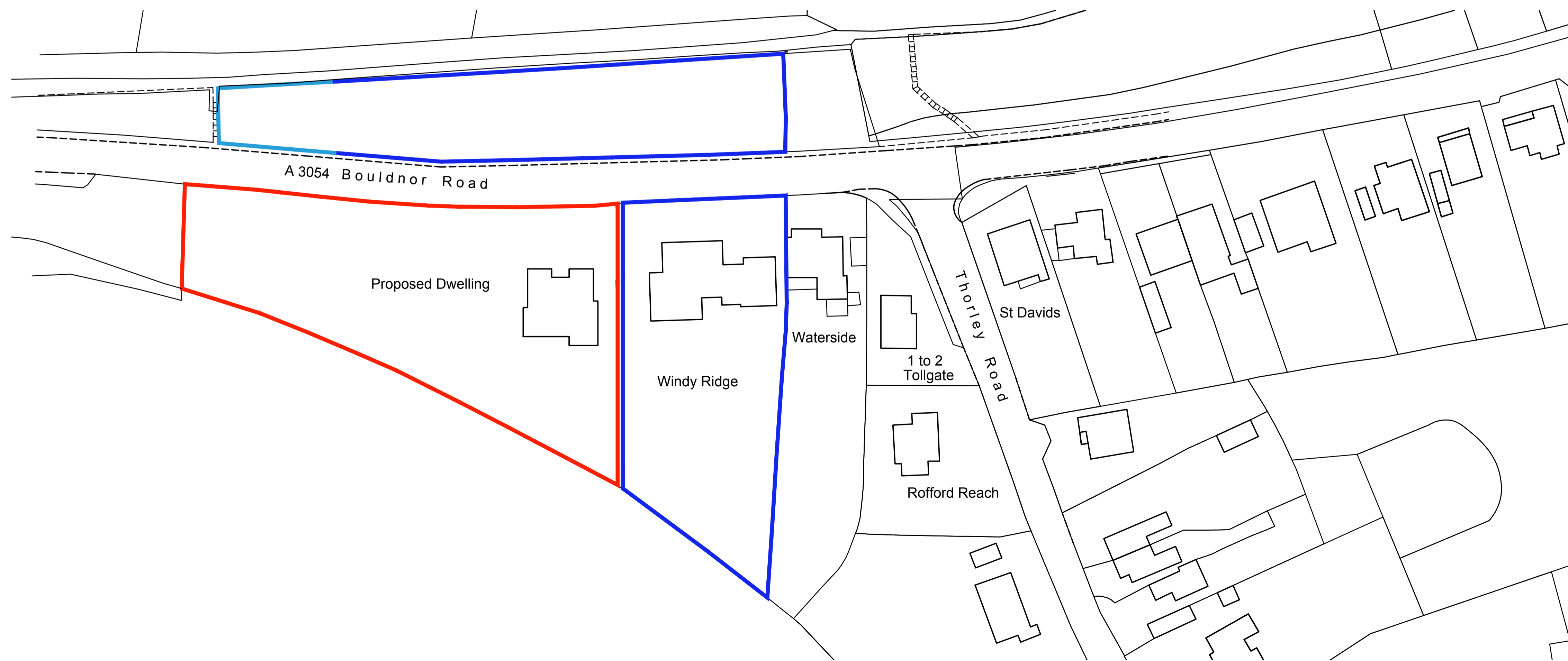

Proposed Block Plan 1/500

General Notes

1. The Contractor is to be responsible for verifying all dimensions and levels on site before commencing work.
2. All figured dimensions are to be taken in preference to any scaled dimensions.
3. Any discrepancies are to be reported to Matthew D Jones Architectural Services before proceeding with the work.
4. All works are to comply fully with current Building Regulations, Codes of Practice, British Standards and the principals of protection and prevention in line with the requirements of the CDM 2015 Regulations.
5. All specialist details are to be checked and approved by Building Control, prior to commencement of such work.

The Construction (Design and Management) Regulations 2015:-

1. In compliance with the CDM Regulations, the Designer has a statutory responsibility to inform the Client of their necessary obligations.
2. It is the client's statutory responsibility to appoint a Principal Designer and a Principal Contractor for the project when the regulations apply.
3. The client should contact Matthew D Jones Architectural Services to ascertain whether the regulations are applicable for this project.
4. The CDM Regulations are a statutory requirement.

The Party Wall etc. Act 1996:-

1. If you intend to carry out building work which involves one of the following categories:-

- * work on an existing wall or structure shared with another property.
- * building a free standing wall or a wall of a building, up to or astride the boundary with a neighbouring property.
- * excavating near a neighbouring building.

It is essential you seek professional advice at an early stage of the project, to identify whether the work falls within the scope of the Act. If the Act applies it is the law that you must notify all affected neighbours.

2. If you start works without having first given notice in the proper way, adjoining owners may seek to stop your work through a court injunction or seek other legal redress.

Copyright:-

The copyright of this drawing remains with Matthew D Jones Architectural Services. No reproduction of information (in part or in whole) without prior permission from Matthew D Jones Architectural Services is permitted.

| No. | Revision | Date |
|-----|-------------------|-------|
| A | Client amendments | 05/23 |

Client
Mr & Mrs Newman

Project
**Proposed Dwelling
Adjacent
Windy Ridge
Bouldnor Road
Yarmouth
Isle of Wight**

Drawing Title
Location & Block Plans



MATTHEW D. JONES
ARCHITECTURAL SERVICES
01983 612700
admin@mdjarchitecturalservices.co.uk
mdjarchitecturalservices.co.uk
Fortis House, Cothey Way, Ryde, Isle of Wight, PO33 1QT

| | |
|-------------|------------------|
| Scale | 1 / 1250 1 / 500 |
| Date | Dec 23 |
| Drawing No. | 23 - 930 - 04 |
| Rev. | |

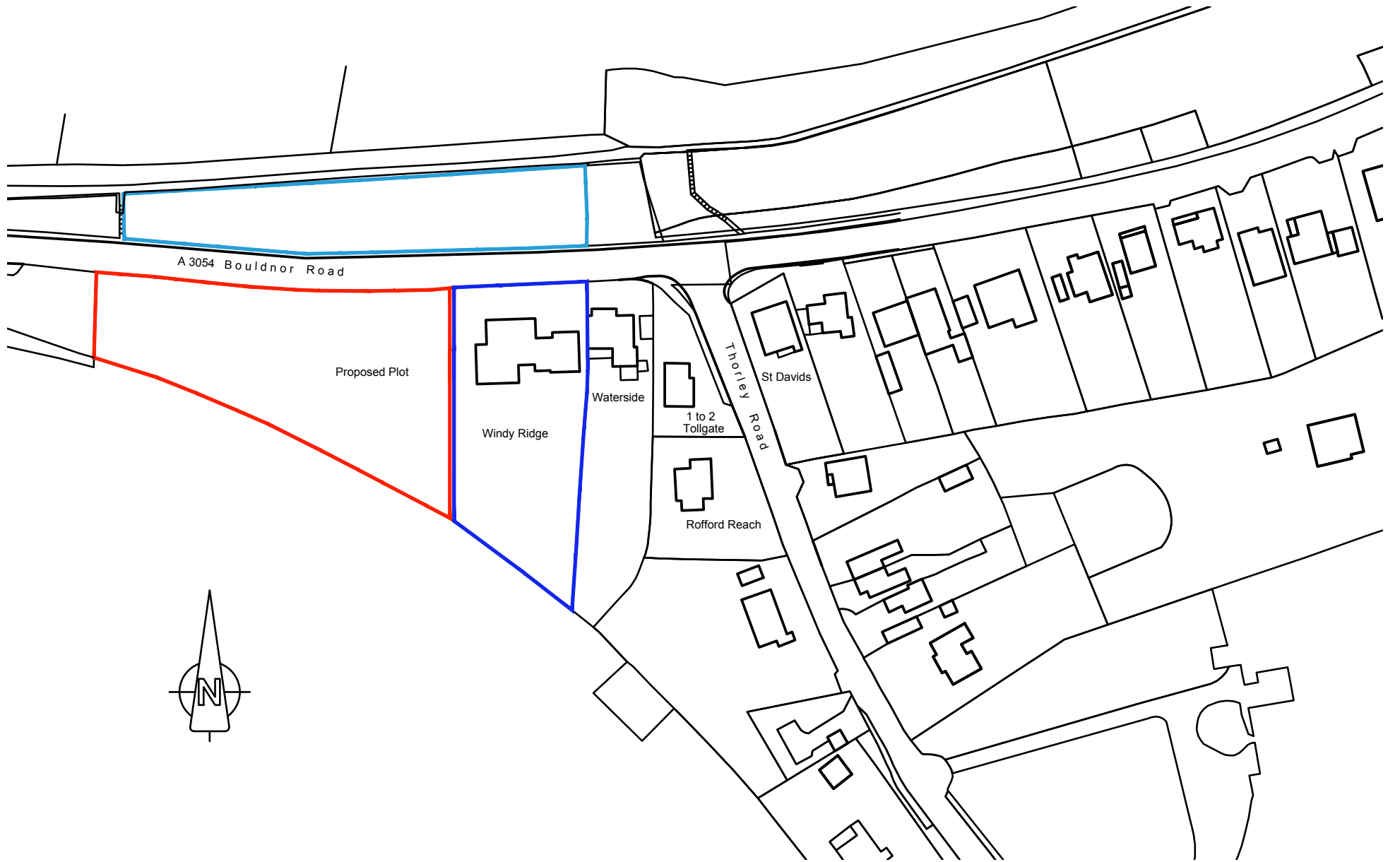

Site Location Plan 1 / 1250