

This drawing is copyright.
Contractors must check all dimensions on site.
Only figured dimensions are to be worked from.
Discrepancies must be reported immediately to the engineer before proceeding.
Preliminary drawings must not be used for construction purposes.

NOTES

- THIS DRAWING IS TO BE USED FOR EXTERNAL WORKS AND BELOW GROUND DRAINAGE ONLY. FOR SETTING OUT OF BUILDINGS AND EXTERNALS REFER TO THE RELEVANT ARCHITECT'S DRAWINGS.
- ABOVE GROUND DRAINAGE INCLUDING STACK PIPE POSITIONS & SPECIFICATION SHALL BE TAKEN FROM ARCHITECT'S DRAWINGS.
- RWPP'S ARE SHOWN INDICATIVELY ONLY. THE POSITION & SIZES OF ALL RWPP'S ARE TO BE PROVIDED & CONFIRMED BY THE ARCHITECT.
- ALL STACK PIPES TO HAVE RODDING ACCESS POINTS AT NO HIGHER THAN 1.5M ABOVE FFL.
- VENTILATION TO BE PROVIDED AT THE HEAD OF EACH FOUL DRAINAGE RUN IN ACCORDANCE WITH BUILDING REGULATIONS.
- FOOTPATHS GENERALLY TO HAVE NOMINAL CROSS FALLS TO SOFT LANDSCAPED VERGES UNLESS SHOWN OTHERWISE.
- ALL MANHOLES POSITIONED IN THE CARRIAGEWAY TO BE AT LEAST 1M FROM THE KERB LINE. THE OUTSIDE OF MANHOLES SHOULD BE AT LEAST 0.5M FROM THE KERB LINE.
- GULLY POSITIONS ARE SHOWN TO THE BEST INTERPRETATION OF THE PROPOSED LEVELS. ADJUSTMENTS MAY HAVE TO BE MADE ON SITE WHEN THE EXACT LOW POINTS IN THE HARD SURFACING ARE DETERMINED.
- THE CONTRACTOR IS REQUIRED TO MAKE AN APPLICATION TO SWW TO MAKE NEW CONNECTIONS TO THE EXISTING PUBLIC SEWER MANHOLE AT EXMH. THIS WORK WILL HAVE TO BE INSPECTED AND APPROVED BY THE SWW INSPECTOR.
- TO CARRY OUT WORK ON THE PUBLIC HIGHWAY THE CONTRACTOR WILL BE REQUIRED TO APPLY FOR A ROAD OPENING PERMIT.
- LEVELS OF EXISTING MANHOLES TO BE CONFIRMED ON SITE PRIOR TO COMMENCEMENT OF DRAINAGE WORKS.
- EXTERNAL SURFACES TO FALL FROM ALL ENTRANCES. RETAINING WALLS TO BE CONFIRMED.
- COORDINATION WITH BUILD SEQUENCE, CRANE BASES, ATTENUATION SYSTEMS TBC TO SUIT CONSTRUCTION AND SERVICE LIFE LOADINGS.
- DETAIL FOR DRAINAGE ROUTES THROUGH RETAINING WALLS TO BE CONFIRMED.

PLEASE REFER TO DRAWING 11400 - C100 FOR EXTENDED NOTES

REFERENCE SHOULD BE MADE TO THE SITE INVESTIGATION REPORT FOR GROUNDWATER LEVELS, MADE GROUND, STABILITY OF EXCAVATIONS AND CONTAMINATION TESTING RESULTS/RECOMMENDATIONS PRIOR TO ANY WORKS TAKING PLACE

THE CONTRACTOR SHALL CARRY OUT ALL NECESSARY PRECAUTIONS TO DETERMINE POSITIONS OF ANY SERVICES PRIOR TO CARRYING OUT EXCAVATIONS

LEGEND

- APPLICATION BOUNDARY
- - - SITE BOUNDARY
- PROPOSED SWD
- PROPOSED FWD
- ▨ PROPOSED ATTENUATION
- LINEAR DRAIN
- RAINWATER PIPE
- SOIL PIPE

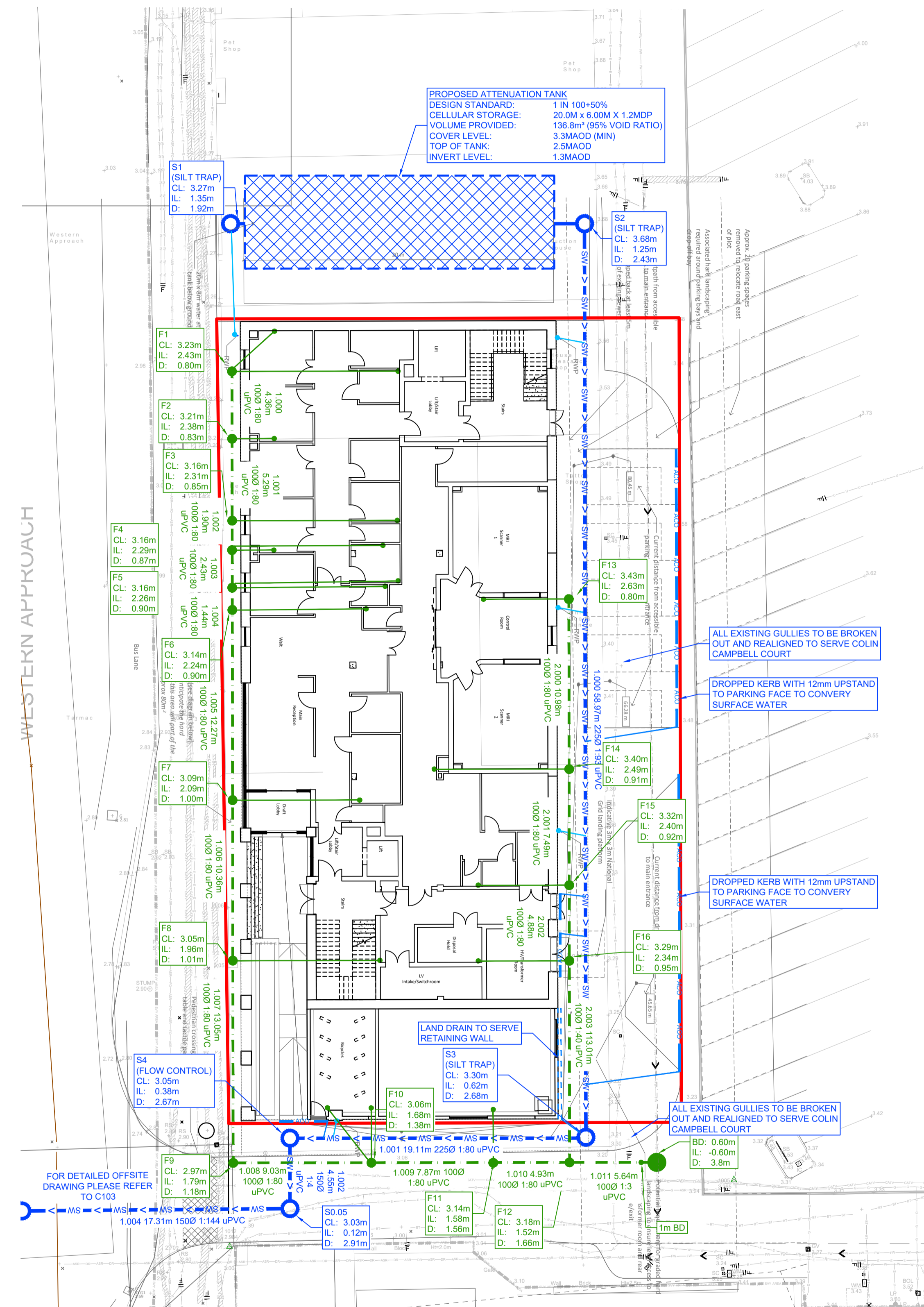

P2	08.12.23	STAGE 3 ISSUE	HB	JCF
P1	22.08.23	STAGE 2 ISSUE	CN	JCF
REV.	DATE	NOTE	BY	CHK.

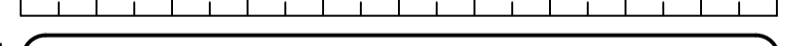

PRELIMINARY NOT FOR CONSTRUCTION

AIREY & COLES
 CONSULTING ENGINEERS
 1st FLOOR, ASHLEIGH COURT
 ASHLEIGH WAY
 LANGAGE BUSINESS PARK
 PLYMPTON
 PL7 5JX
 Tel: 01752 229119
 Fax: 01752 222115
 admin@aireyandcoles.co.uk

PROJECT
COMMUNITY DIAGNOSTICS CENTRE, PLYMOUTH

DRAWING TITLE
GENERAL LAYOUT SWD, FWD & EXTG COMBINED

SCALE	DATE	DRAWN BY	CHECKED
1:200	AUG 2023	HB	JCF

INTERNAL REFERENCE	REVISION	
11409 - C100	P2	

PROJ-VOLUME-LEVEL-ROLE-ORIG-FILETYPE-CLASSIFICATION-NUMBER
11409-A&C-01-EX-DR-C-C100