

NOTE - THIS PLAN TO BE  
READ IN CONJUNCTION WITH  
OVERALL LAYOUT OF WHOLE  
BUILDING

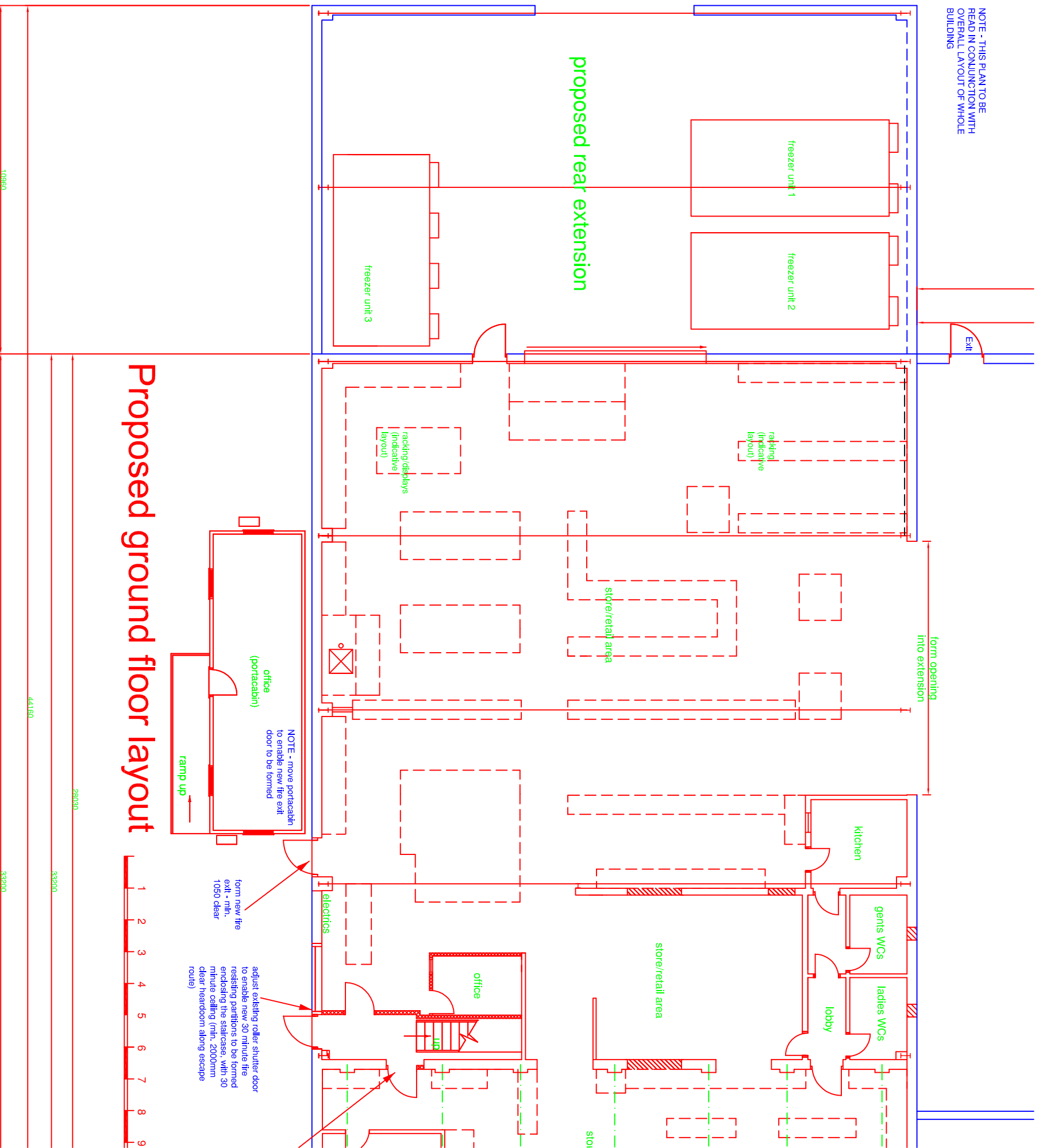

# Proposed ground floor layout

NOTE - move portacabin  
to enable new fire exit  
door to be formed

office  
(portacabin)

ramp up

form new fire  
exit - min.  
1050 clear

adjust existing roller shutter door  
to enable new 30 minute fire  
resisting partition to be formed  
encasing the staircase, with 30  
minute ceiling (min. 2000mm  
clear headroom along escape  
route)



Proposed extension & alterations to:  
TFM Country Store  
Thorpe Road  
Whisby  
Lincoln

Proposed ground floor plan  
Rear extension



218 Burgh Road, Skegness  
Lincolnshire PE25 2LQ Tel: 07887 950292

Date: April 2023  
Drawn by: BK  
Checked by: BK

Scale: 1:100 @A3

Drawing no: 4535-09

DO NOT SCALE. ALL DIMENSIONS TO BE CHECKED.  
ON SITE & DIMENSIONS MUST BE ENFORCED.  
FIELD OF VIEW FROM EXISTING AND PROPOSED LOCATIONS  
AND FROM THE CORNER OF EACH PROPOSED PLANT AND STRUCTURE MUST BE MAINTAINED.