



STREET SCENE B-B (Part 1)  
Woodland Ridge  
1:100



STREET SCENE B-B (Part 2)  
Woodland Ridge  
1:100



STREET SCENE B-B (Part 3)  
Woodland Ridge  
1:100

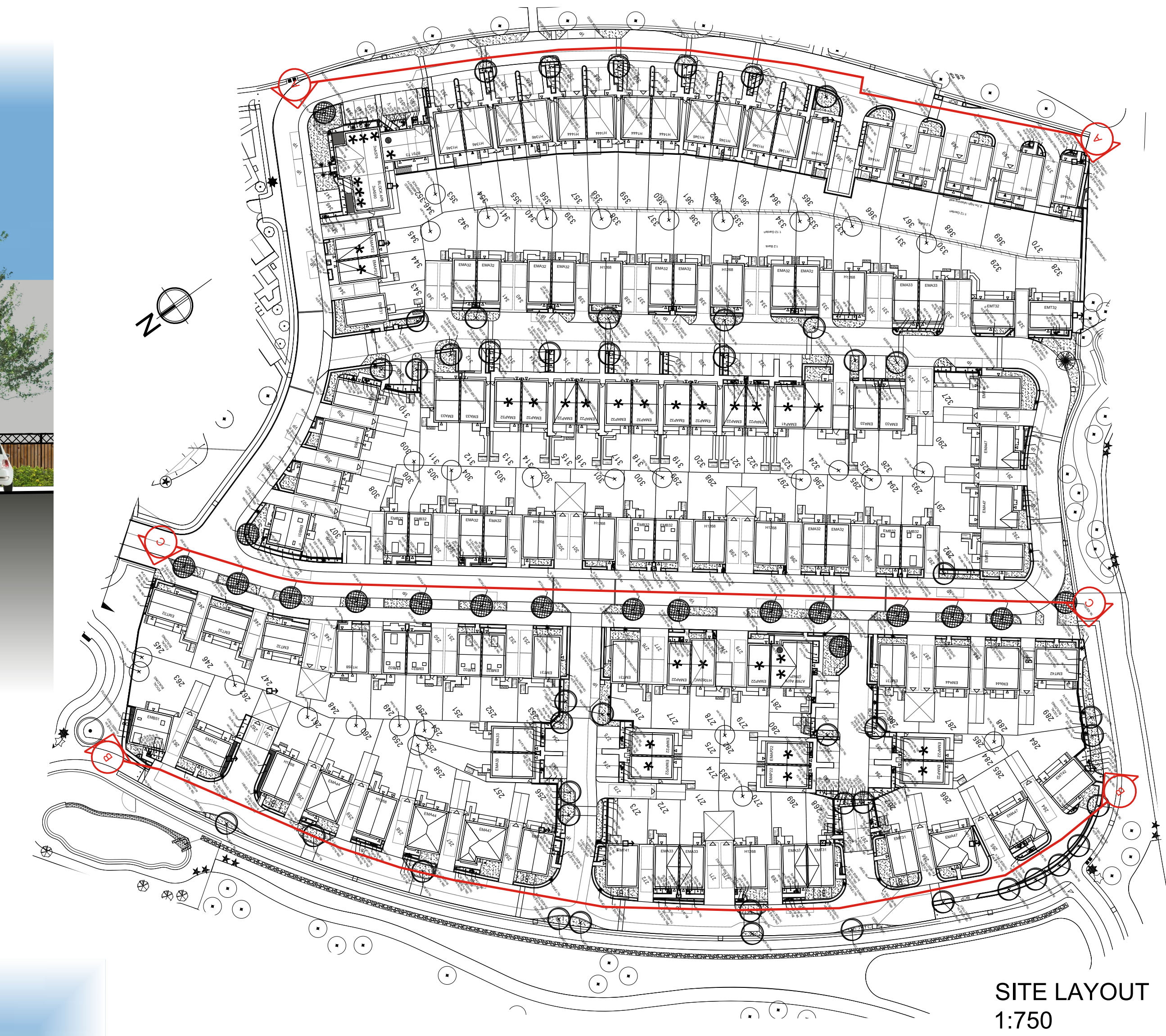

SITE LAYOUT  
1:750

NOTE: Materials colour may vary, please refers to Materials Plan.

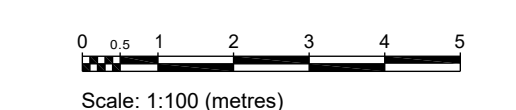

REV	DATE	DESCRIPTION	DRAWN
B	30.11.23	Updated to latest Site Layout & house types.	ksl
A	17.07.23	Updated in line with latest Site Layout	ksl
PROJECT PARCELS 5,6 & 7 (PHASE 2) BERWICK GREEN, CRIBBS CAUSEWAY			
TITLE STREET SCENE BB SITE LAYOUT			
<b>Taylor Wimpey Bristol</b> 602 Park Avenue Aztec West Almondsbury Bristol BS32 4SD T 01454 828400 F 01454 628401 DX 124894 Almondsbury 3 www.taylorwimpey.com NHBC REG No 76463			
DRN	CDS	SCALE 1:100	DRAWING NUMBER
DATE	17.05.23	@A0	22016.202
			REV B

