

# EXISTING BAY WINDOW AND DOOR VERTICAL SECTIONS

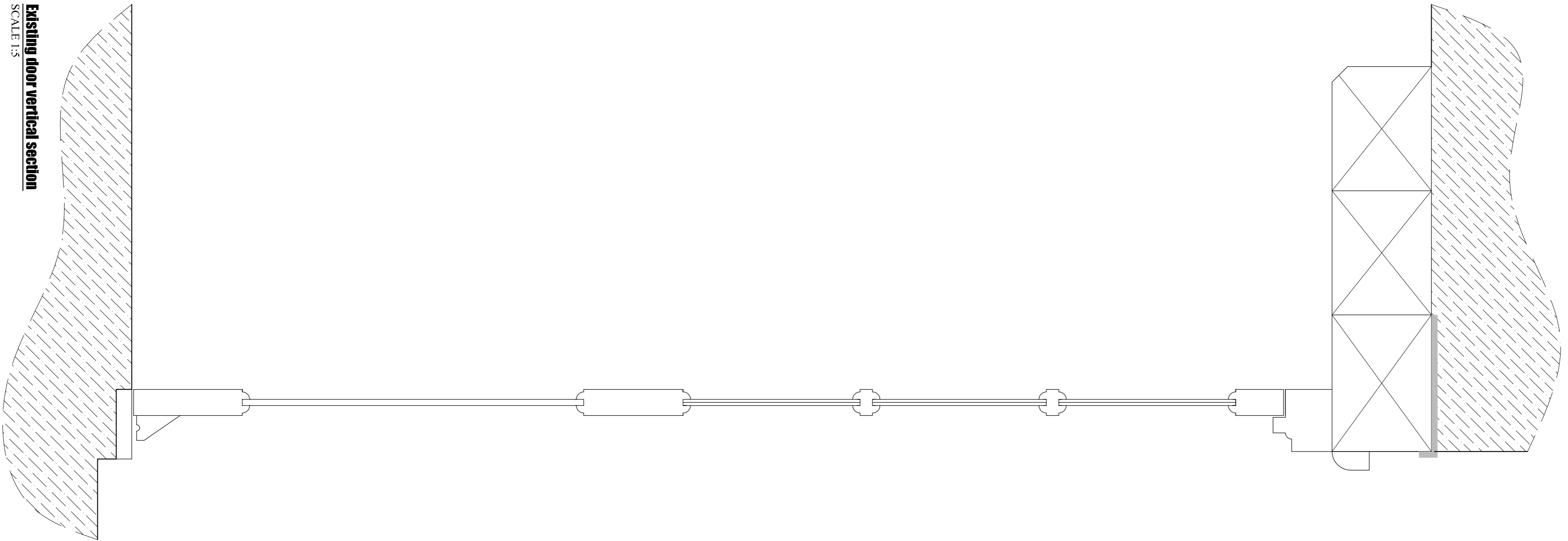

**Existing door vertical section**  
SCALE 1:5

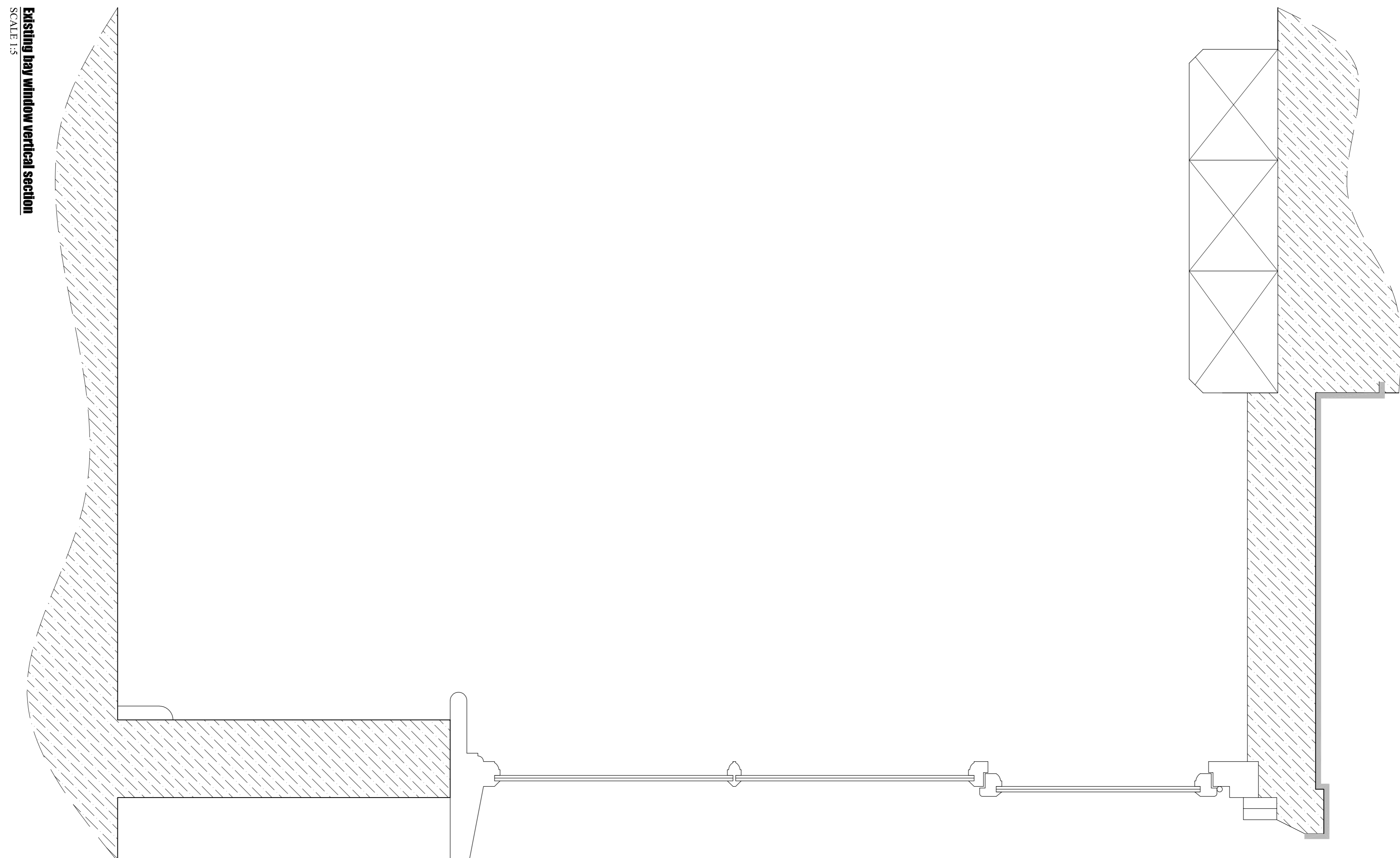

**Existing bay window vertical section**  
SCALE 1:5

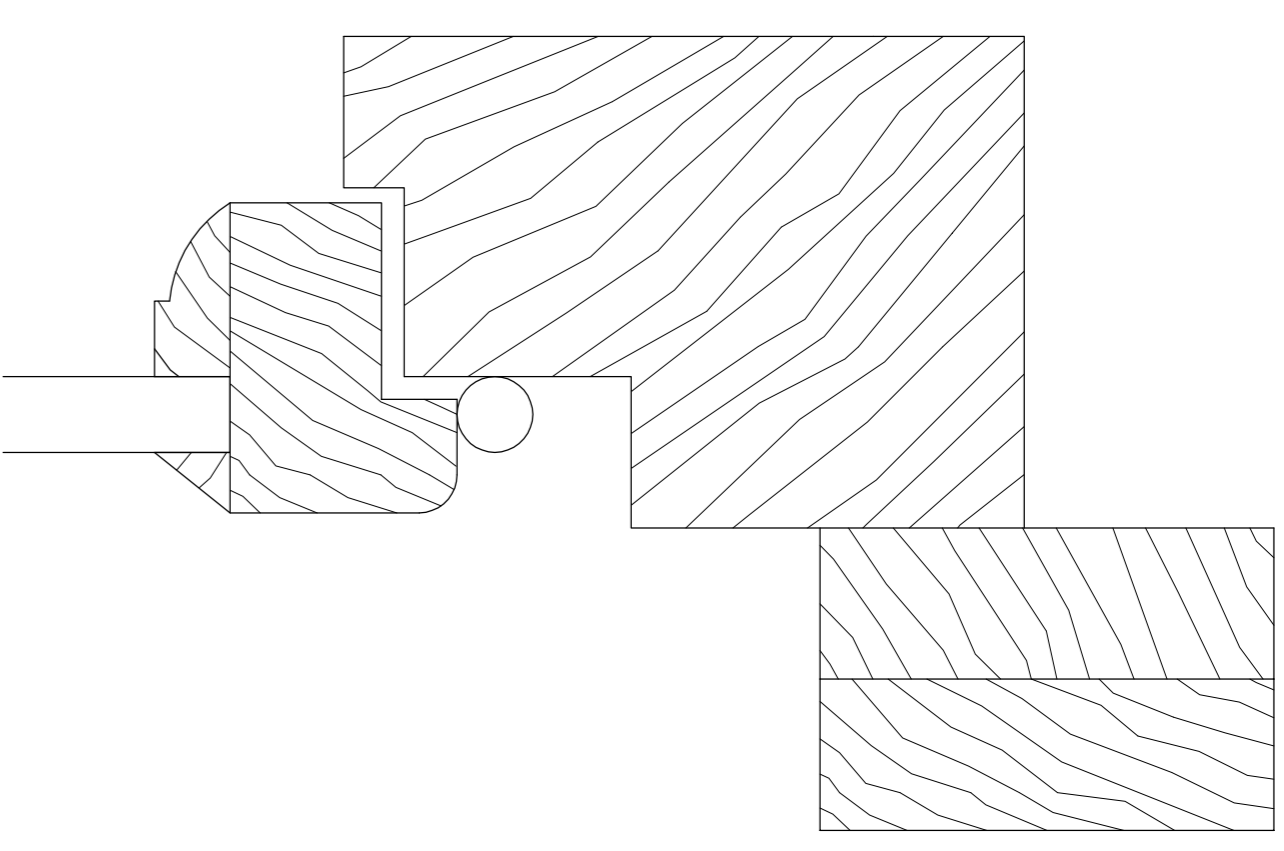

**Existing bay window frame opening casement head section**  
SCALE 1:1

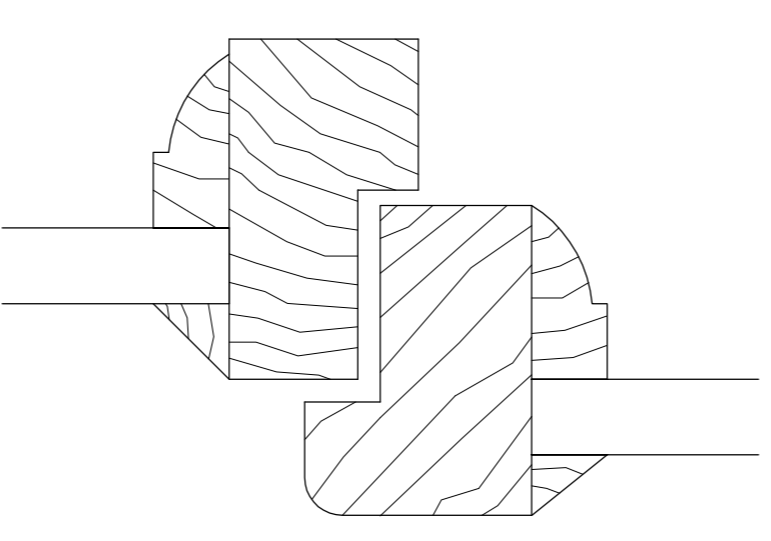

**Existing bay window frame opening casement section**  
SCALE 1:1

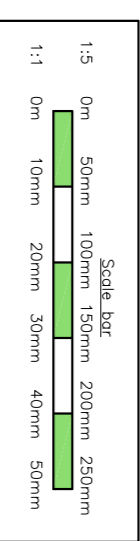

## Ian S Ford Building Surveying and Planning Ltd

Proprietors: Ian S Ford BSc (Hons) MRICS, & G A Ford Ltd.  
 15 Ford Road, Clifton, Bristol, BS2 9DQ  
 Phone: 01752 462033 or 07796191272 Email: info@iandford.co.uk or iand@iandford.co.uk

Client: Mr & Mrs Wilmshere  
 15 High Street  
 Clifton, Bristol  
 South Gloucestershire  
 BS37 6BA

Job title: Listed Building Application for works to fenestrations serving principal (southern) elevation to:  
 Clipping Sashway  
 South Gloucestershire  
 BS37 6BA

Scale: 1:5 @ A1  
 Drawn by: JF  
 Checked by: JF  
 Date: 11/23

Revision:  
 Ref: A Date: 12/23 Final amendments prior to submission

Comments Note:  
 1. All work must be completed by suitably skilled operatives who have the appropriate training, experience, tools and access for the job.  
 2. Written construction phase plan required.  
 3. While completing the work the builder/contractor should comply with all applicable regulations and standards.  
 4. Provisionary bodies for listed services in the vicinity. Then when on site signs should be made prior to start.  
 5. Access provided and safety procedures in place. All scaffolding to have a scaffolding certificate that the scaffolding has been designed and erected in accordance with the relevant standards.  
 6. Care should be taken to ensure the site is appropriately enclosed at all times to both the occupants of the dwelling and the general public.  
 7. On all parties to the project. This includes Principal Designers, Contractor, Builder, and Client (including domestic clients). For further information please refer to the relevant legislation.  
 http://www.bca.gov.uk/construction/2015/domestic-client.htm or http://www.bca.gov.uk/construction/2015/contractor-client.htm

Notes:  
 1. This drawing contains the property of the applicant.  
 2. Unauthorised reproduction is prohibited.  
 3. Unauthorised reproduction is prohibited.  
 4. Unauthorised reproduction is prohibited.

Proj No: **2081-23-003 rev A**