

EXISTING BAY WINDOW AND DOOR HORIZONTAL SECTIONS

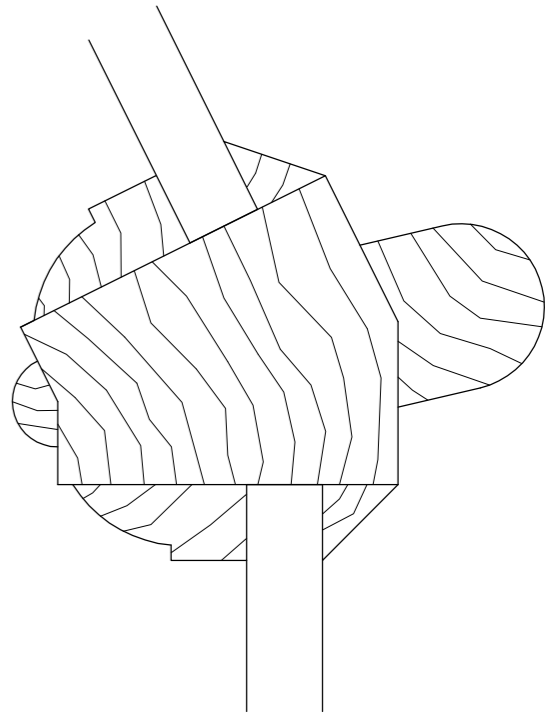

Existing Bay Window Frame section
SCALE 1:1

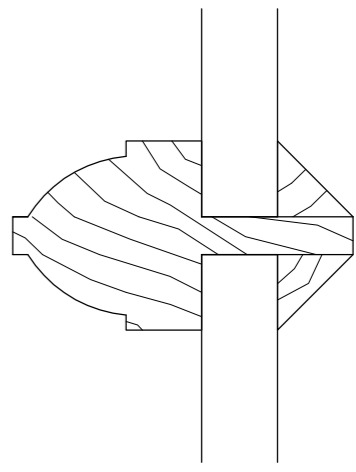

Existing glazing bar section
SCALE 1:1

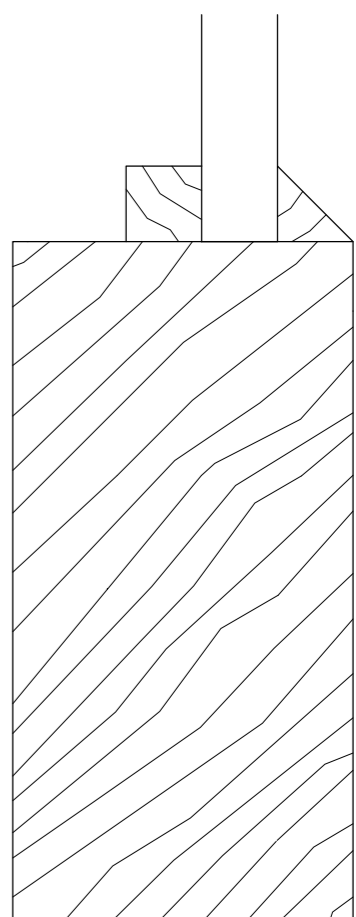

Existing bay window frame section
SCALE 1:1

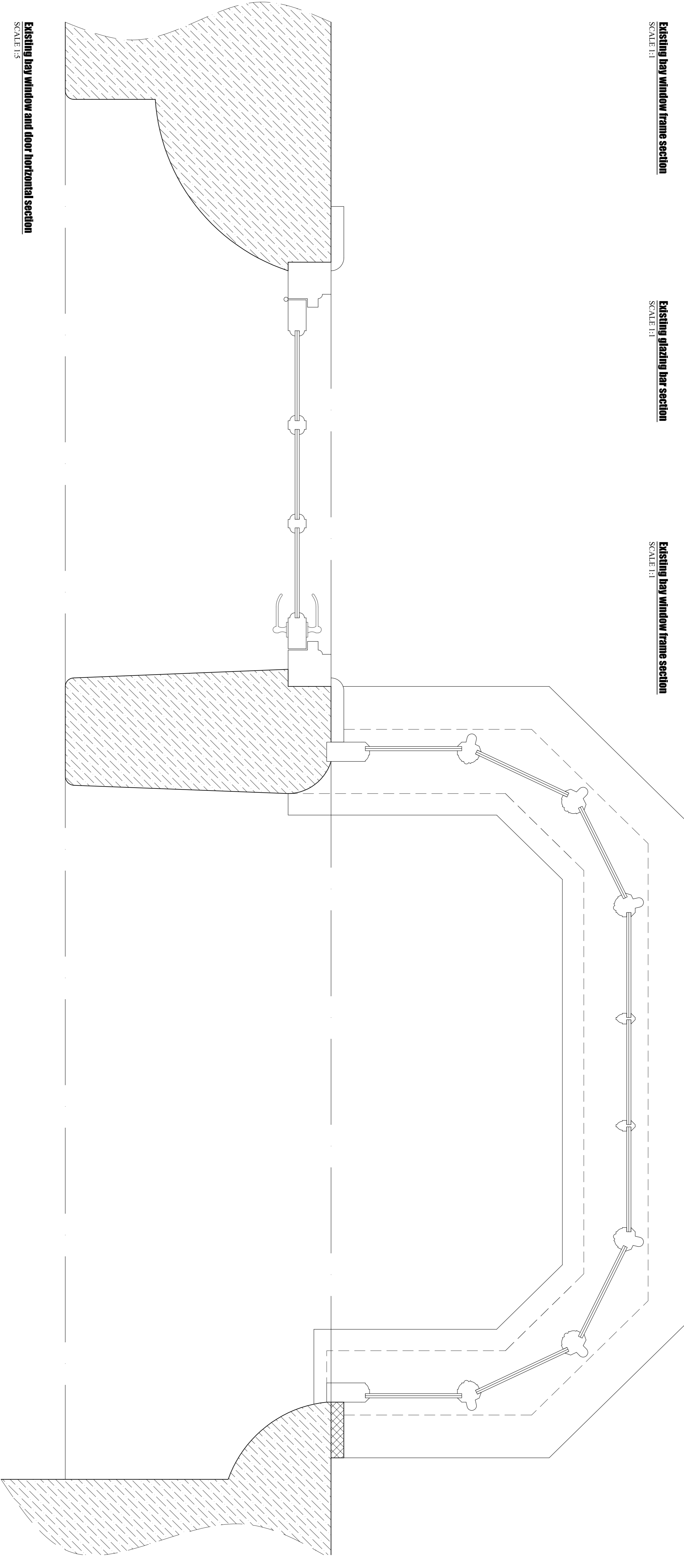

Existing Bay window and door horizontal section
SCALE 1:5

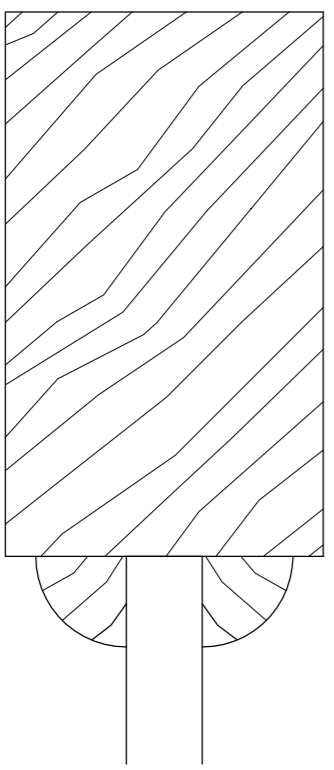

Existing door frame section
SCALE 1:1

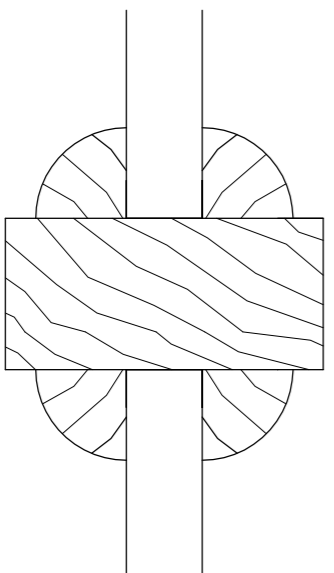

Existing door glazing bar section
SCALE 1:1

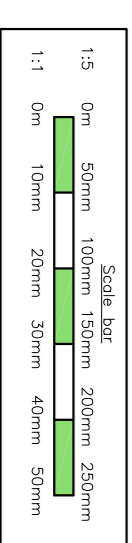

Ian S Ford Building Surveying and Planning Ltd

Proprietary: Ian S Ford BSc, C. Eng, MRSA, MRICS, & G A Ford MA, MRSA, MRICS, MRIO, NCFE
 01793 462013 or 01779619127
 Email: ian@iansford.co.uk or info@iansford.co.uk

Client: Mr & Mrs Wilmore
Address: 13 High Street
 Clipping Sodbury
 South Gloucestershire
 BS37 6BA

Job title: Listed Building Application for works to fenestrations serving principal (southern) elevation to:

13 High Street
 Clipping Sodbury
 South Gloucestershire
 BS37 6BA

Drawn by: LF
Checked by: HF

Day title: Existing bay window and door horizontal sections
Rev No: **2081-23-002 rev A**

Notes:
 1. This drawing remains the property of the applicant
 2. commencement of works. Any discrepancies should be reported immediately.
 3. See signed dimensions for main window reference used)

Revisions:	Date:	Revised:
A	12/23	Final amendments prior to submission

Comments/Notes:

- All work must be completed by suitably skilled operatives who have the appropriate training, experience, tools and access for the job.
- written construction phase plan prepared.
- Whilst completing the work the builder/contractor should comply with all associated services which is to then be given to the homeowner on completion.
- provisionary notices for listed services in the vicinity. These when on site scans should be made prior to start.
- access provided and safety provisions in place. All scaffolding to have a written confirmation that the scaffolding has been designed and erected in accordance with the relevant standards.
- Care should be taken to ensure the site is appropriately enclosed at all times to both the occupants of the dwelling and the general public.
- Contractor, Builder, and Client (including domestic clients). For all parties on the project. This includes Principal Designers.
- <http://www.listed.gov.uk/construction-clm2015> (connect-to-client.htm or <http://www.listed.gov.uk/construction-clm2015>)