



View of fence from the North



View of fence from the South

NOTES:

Timber fencing to be finished as follows:

- Posts: To be painted black
- Gravel boards: To be painted black
- Timber fence panels: To be painted white

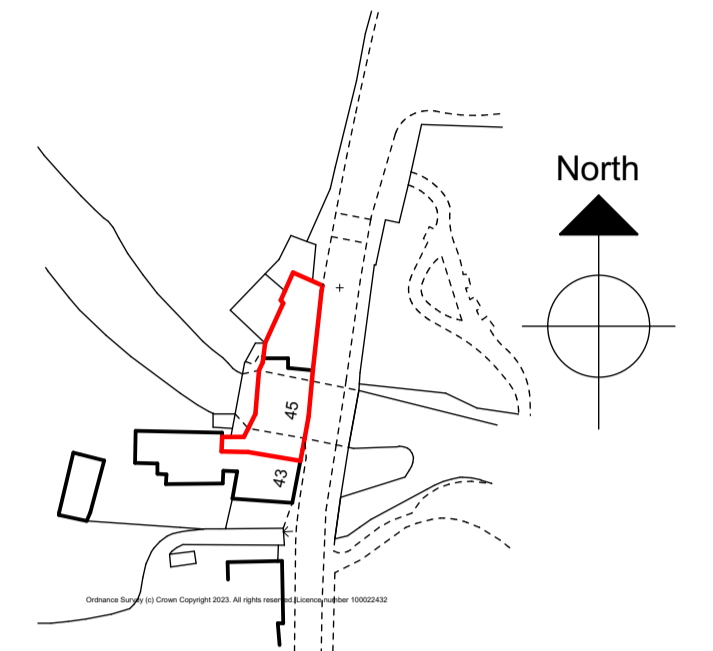

Location plan 1:1250

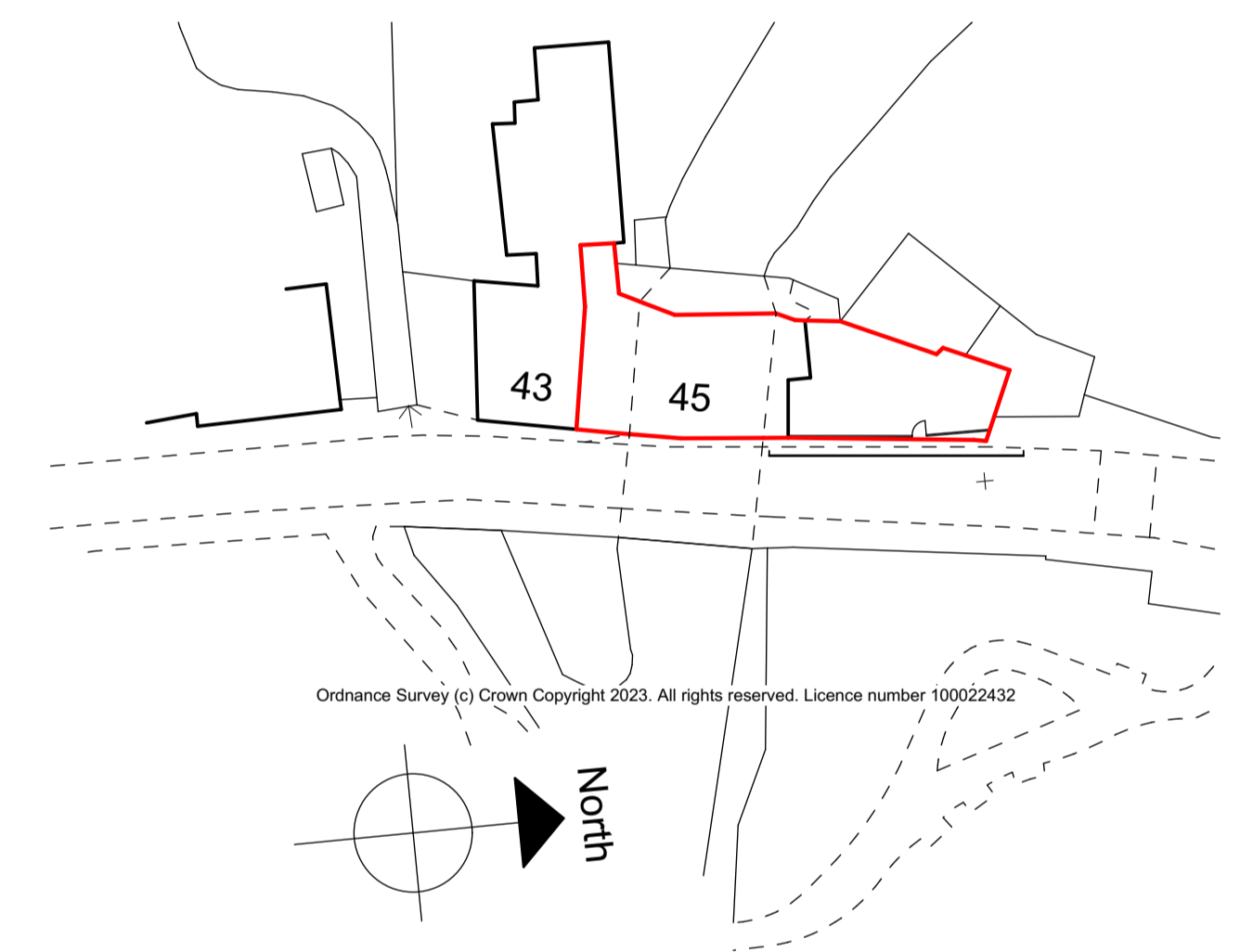

Site plan 1:500

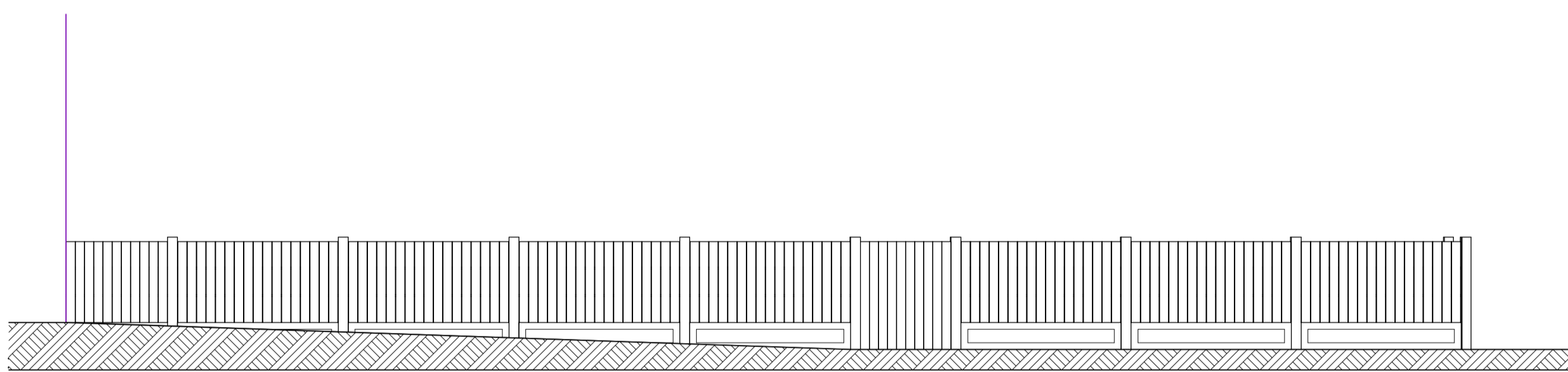

Street elevation

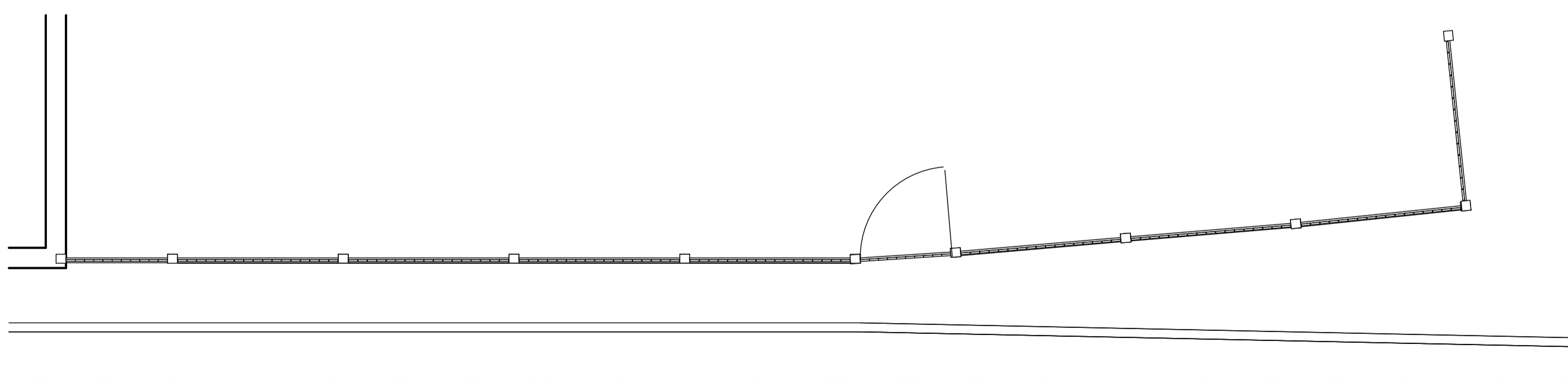

Plan



New fencing

B	18.12.23	Red line revised
A	18.12.23	Site and location plans added
NO.	DATE	REVISION

John Jenkins

architectural designs limited
 Company no. 6003278

CLIENT [Mr P. Kitson](#)

JOB [45A Bridge Street, Loddon, NR146NA](#)

TITLE Retrospective application for new close boarded fencing

DATE 14.12.23 REV B

DRAWING NO. **1617/01**

Scale: 1:50 @ A1

Telephone 01508 558935
 Mobile 07919 854438
 Fax 01508 558935
 email jj.architecturaldesigns@btopenworld.com

The Thatch Seething Fen Seething
 Norwich Norfolk NR15 1DG