

APPROVED BLOCK PLAN 1:500

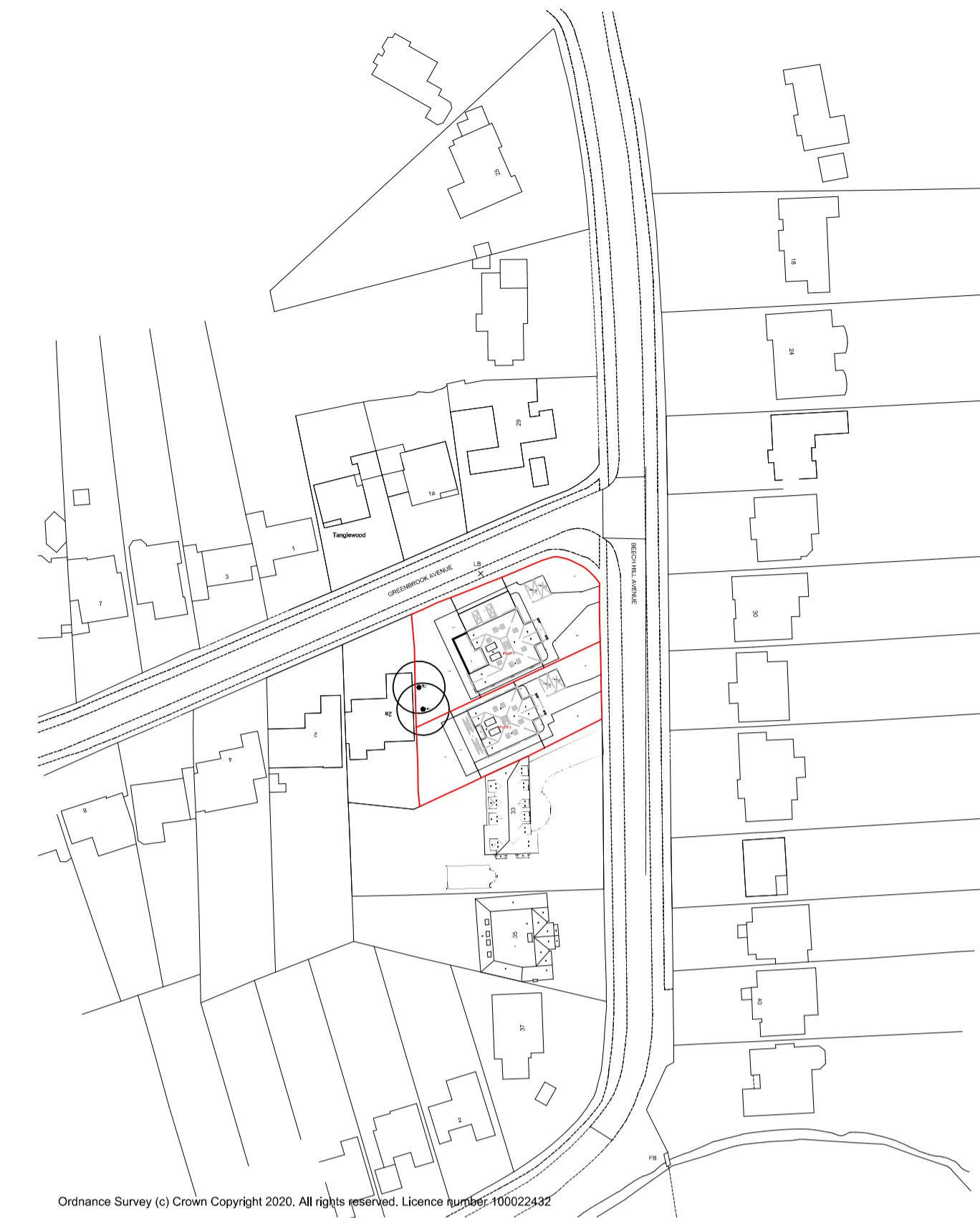
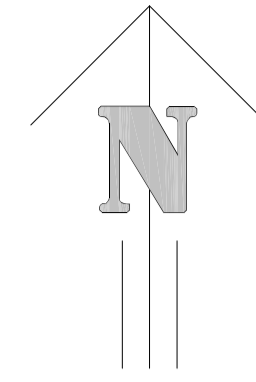

APPROVED LOCATION PLAN 1:1250

Ordnance Survey (c) Crown Copyright 2020. All rights reserved. Licence number: 100022432

APPROVED APPLICATION REF. NO. 21/00552/FUL

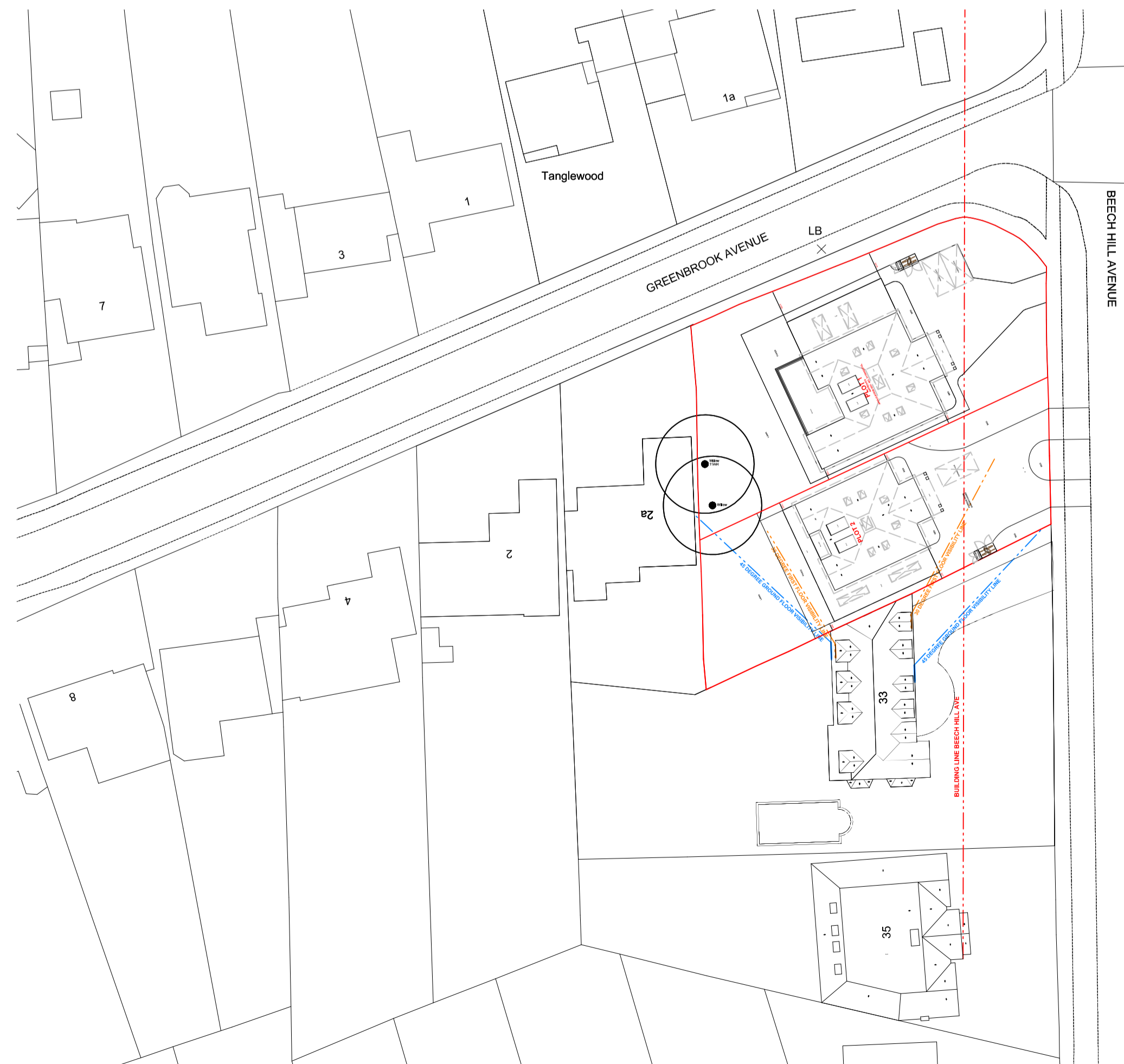

PROPOSED BLOCK PLAN 1:500

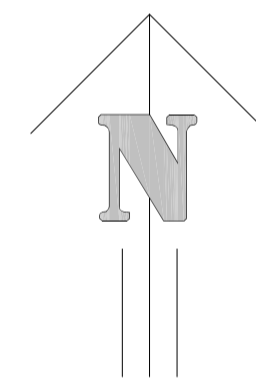

PROPOSED LOCATION PLAN 1:1250

Ordnance Survey (c) Crown Copyright 2020. All rights reserved. Licence number: 100022432

NEW APPLICATION

Revision	Description	Date

TOWN AND COUNTRY PLANNING LTD
 (020) 8441 4947
 13 Evelyn Road, Cockfosters, Hertfordshire EN4 9JT
 e-mail: martin@tcp ltd.net

Project
 31 Beech Hill Ave
 Hadley Wood
 Herts
 EN4

Client
 Mr & Mrs N. Christofi

Approved & Proposed Block / Location Plans

Drawing No.
 2022/1562/5

Scale 1:500 1:1250 **Drawn By:** M.P.M

Sheet Size A1 **Date** 28 Jun 2023

IMPORTANT NOTICE
 © Copyright. Drawing to be used in conjunction with specification and structural engineers notes. All dimensions to be checked on site prior to commencement of work, differences between drawings, and between drawings and specification or structural engineers details to be referred immediately to Town and Country Planning Ltd. Work should only be undertaken from local authority approved drawings. Commencement of any work on site prior to gaining the necessary planning and/or building control approvals is entirely at the client's own risk. We strongly recommend you agree the boundary lines of the property before any work commences on site it is the responsibility of the builder and the property owner to be in agreement with the definition of these lines.