

Paving		
Ref	Description	Detail
P1	Clay paving	215x52x70mm; buff colour; stretcher bond
P2	Resin bound gravel parking bays	Buff colour
P3	Granite sett to parking edge	100x100x100mm granite sett paving paving; dark grey; laid in 3 rows dishd to from drainage feature; 10mm sand joints
P4	Clay paving	215x52x70mm; brown/red colour; stretcher bond
P5	Gravel finish	Staffordshire Pink Gravel
P6	Stepping stones	600x300x50mm natural stone slabs with bonded aggregate joints
P7	Terrace decking	Terrace decking laid herringbone; final colour and specification agreed post planning

Edging		
Ref	Description	Detail
K1	Textured concrete kerb	145x255x915mm silver grey colour kerb
K2	Textured concrete edging	63x150x915mm silver grey colour edging

Boundaries		
Ref	Description	Detail
B1	Boundary railings, where planters do not provide enclosure	1.1m high flatbar railings and gate. Colour to match architectural metal work, TBC

Street Furniture		
Ref	Description	Detail
F1	Eco stack	Log piles 1 - 1.5m long taken from felled trees
F2	Cycle stand	Stainless steel
F3	Seat	Timber slatted seat with back and arm rest
F4	Pergola	40mm profile post with tensile cable extending down and between posts to form pergola. Pergola height to be 100mm above window lintel/header position
F5	Eco stack	450mm high timber clad stepping seats
F6	Steel planter	1.1m high roll top powder coated steel planter edge, colour to match architectural metal work
F7	Play house	Timber with painted 'address' reference
F8	Bug hotel	To include information sign
F9	Bird box	Timber post mounted bird box
F10	Water butt	Black water butt with connection to RWP is possible
F11	Bib tap	Connected to grey water storage if possible

Notes	
1	Alternatives acceptable and must be agreed with client and approved by relevant consultants
2	Sub-bases, electrical and mechanical elements, and structural elements must be specified by the respective engineer, civil, M&E and structural

Trees		
Ref	Description	Detail
T1	Amelanchier lamarckii	
T2	Prunus avium 'Plena'	

Planting Palette		
Ref	Description	
M1	Shrubs:	
	<ul style="list-style-type: none"> • Berberis thunbergii 'Autropurea Nana' • Cornus sanguinea 'midwinter fire' • Hebe 'Beverly Hills' • Rosa canina • Vinca major 	
	Grasses:	
	<ul style="list-style-type: none"> • Carex flagellifera • Deschampsia cespitosa 'Bronzeschleier' • Luzula sylvatica • Uncinia rubra 	
	Herbaceous Perennial:	
	<ul style="list-style-type: none"> • Achillea 'Moonshine' • Bergenia 'Wintermärchen' • Euphorbia amygdaloides var. robbiae 	
	Native planting:	
	<ul style="list-style-type: none"> • Corylus avellana • Crataegus monogyna • Euonymus europaeus • Ligustrum vulgare • Viburnum opulus 	
	Climbers:	
	<ul style="list-style-type: none"> • Lonicera japonica 'Halliana' • Hydrangea anomala 'petiolaris' • Parthenocissus tricuspidata 'Veitchii' 	
M2	Ground Cover	
	<ul style="list-style-type: none"> • Artemisia 'Powis Castle' • Cistus x pulverulentus 'Sunset' • Clematis viticella • Echinops bannaticus 'Taplow Blue' • Heuchera 'Obsidian' • Lavandula angustifolia • Nandina domestica • Fremontodendron 'California Glory' • Santolina chamaecyparissus • Panicum virgatum 'Shenandoah' • Perovskia 'Blue Spire' 	
	Climbers	
	<ul style="list-style-type: none"> • Campsis radicans 'Flava' • Eccecmocarpus scaber • Jasminum officinale • Passiflora caerulea • Solanum crispum 	

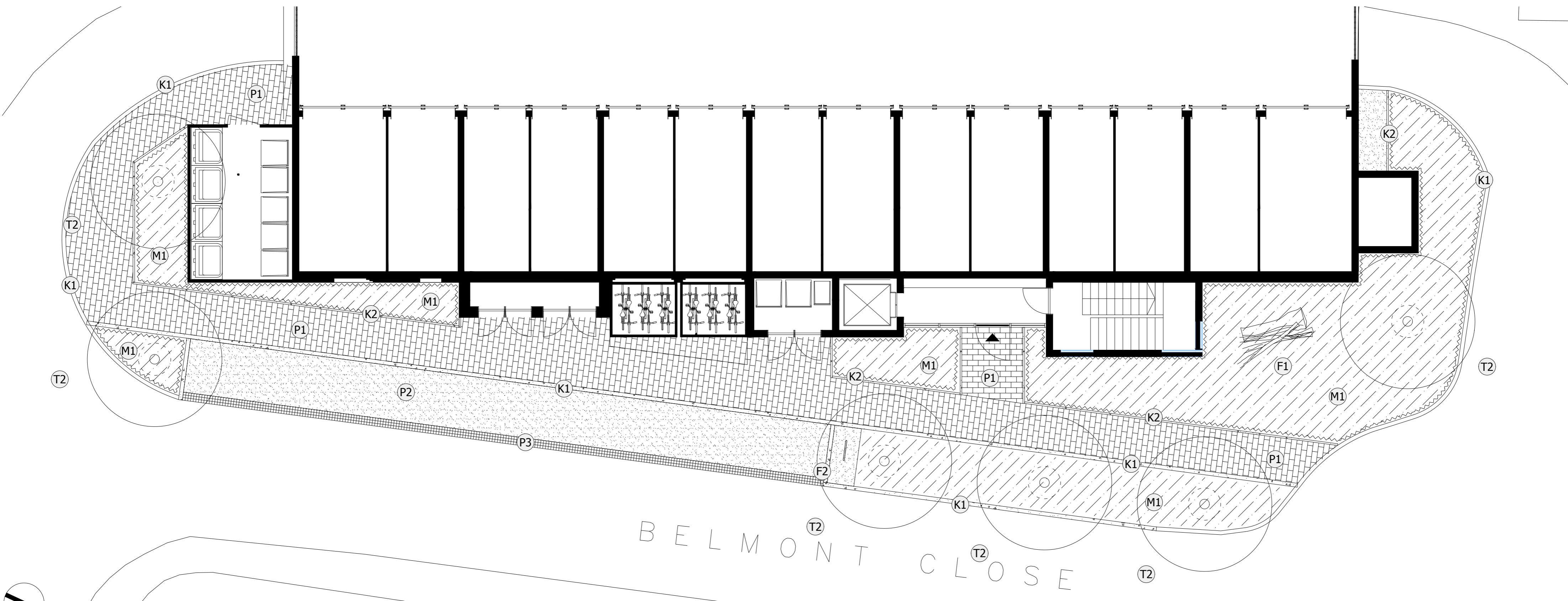

Notes:
 The scope of this drawing is the identification and arrangement of landscape elements, for planning submission, and must be read in conjunction with the design team discipline's respective drawings. Do not scale from this drawing, request .dwg versions if required. Information beyond site edge shown indicatively only.
 Based on context and architectural information received from Downen Farmer Architects. Highways layouts, structural, civil and mechanical and electrical engineer elements by others.
 All trees, proposed and existing, must be assessed by the structural engineer to ensure adequate detailing based on NHBC (as standard) and best practice guidelines.
 This drawing does not constitute tender or construction status information and must not be used as such.

Rev 02 | Updated following architect comment | 28.11.23
 Rev 01 | Updated to latest layout | 27.11.23
 Rev 00 | First issue for comment | 11.10.23

Landscape Proposals
Belmont Close, Enfield
 Client: Foxglade Properties Ltd
 Status: Planning
 Scale: 1:100 @ A1
 Drawing no: MTC44P01
 Revision: 02

