

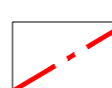

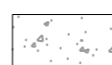

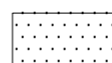





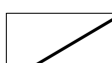

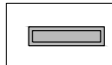

### Landscape Legend

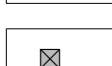
-  Application Boundary
- Hard Landscape**
  -  Paving Type 01 (vehicle loading)  
Tarmac to primary roads
  -  Paving Type 02 (vehicle loading)  
Coloured tarmac to secondary roads
  -  Paving Type 03 (pedestrian loading)  
Resin bound aggregate to footpaths
  -  Paving Type 04 (pedestrian loading)  
Resin bound aggregate feature banding
  -  Paving Type 05 (pedestrian loading)  
Concrete flags to private terraces
  -  Paving Type 06 (pedestrian loading)  
Block paving to footpaths
- Edges & Boundaries**
  -  Kerb Type 01  
Raised kerb with 125mm upstand
  -  Kerb Type 02  
Flush kerb
  -  Boundary Type 01  
1.1m Railing to private terraces
  -  Boundary Type 02  
1.8m Railing to top of retaining wall
  -  Wall Type 01  
Low wall to private terraces of Block B to retain difference between FFL and street level
- Gate Types**
  -  Automated Double leaf vehicle gates to northern parking court
  -  Double and single leaf access gates to pedestrian areas - Open during day light hours
  -  Single leaf access gates to private terraces
  -  Double leaf access gates to St Paul's - Open during day light hours
- Furniture**
  -  Furniture Type 01  
Removable Bollards
  -  Furniture Type 02  
Bench with arm and back rests
  -  Furniture Type 03  
Raised Seating Wall, colour to match PT04
  -  Furniture Type 04  
Combined Seating and Table
  -  Furniture Type 05  
Seating Cubes
  -  Furniture Type 06  
Litter Bin
  -  Furniture Type 07  
Handrail to steps
- Play Features**
  -  Play Feature 01  
Stepping Stones
  -  Play Feature 02  
Vertical poles
  -  Play Feature 03  
Tactile Orbs
  -  Play Feature 04  
Games Table
- Soft Landscape**
  -  Proposed shrub herbaceous planting
  -  Proposed hedge planting
  -  Proposed amenity lawn (turf)
  -  Proposed SUDS seed mix to Dove Lane
  -  Proposed single-stem tree
  -  Proposed multi-stem tree
  -  Existing trees retained
  -  Existing Trees Removed

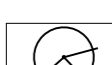

See D3125-FAB-00-XX-DR-L-1001 for continuation

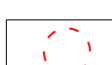
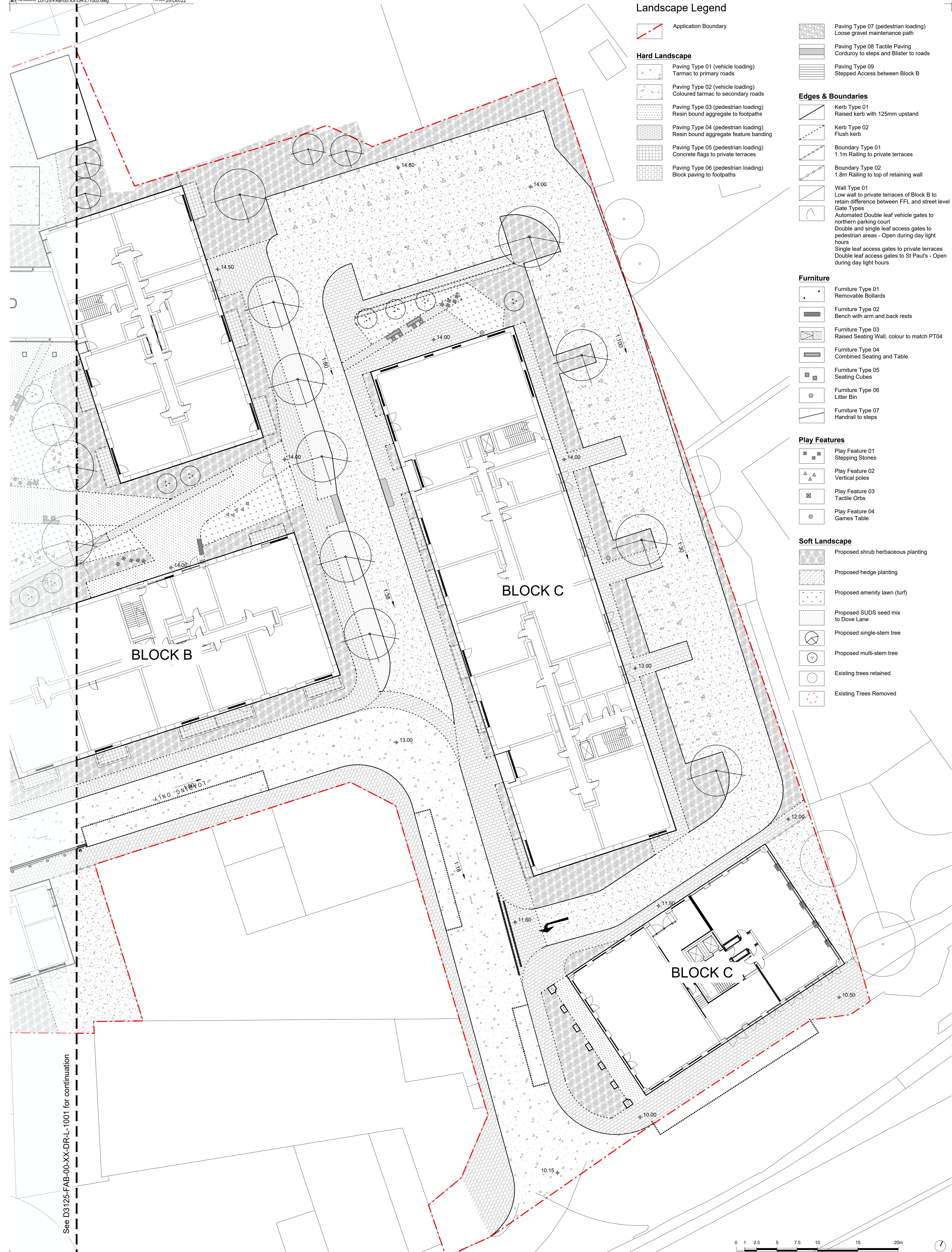
PO4	24.10.2022	Issued for Planning	JR	JR
PO3	20.03.2022	Issued for Planning	PDC	PDC
PO2	25.03.2022	Final draft for review	GC	PDC
PO1	25.03.2022	Draft for Review	GC	PDC
Revision	Date	Reason	Drawn	Checked

Disclaimer:  
 1. This drawing is copyright of Fabrik Ltd. It must not be copied or reproduced without written consent from the owner.  
 2. Do not scale from this drawing. Only figured dimensions are to be taken from this drawing.  
 3. All contractors must visit site and be responsible for taking and checking all dimensions related to the works shown on the drawing prior to fabrication or setting out.  
 4. This drawing uses coloured lines. Please do not rely on a monochrome copy.

External References:  
 • Site Context | D3125-FAB-00-XX-M2-L-7000 | Originally provided by Architect 08.02.2022

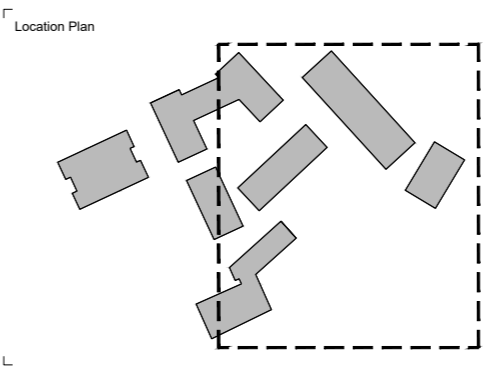

0 1 2.5 5 7.5 10 15 20m  
1:200

**fabrik** landscape architects  
 First Floor Studio | The Old School | 4 Exton Street | London | SE1 8JL  
 T: 0207 620 1453 | E: london@fabrik.com | W: www.fabrik.com

Project: Dove Lane, Bristol  
 Client: Places for People Homes Limited

Drawing Title: General Arrangement Plan - Sheet 2

Drawn By	Checked By	Drawn Scale	Date of First Issue
GC	PDC	1:200 @ A1	Feb   2022

Project Number	Origin	Zone	Level	File Type	Role	Number	Revision
D3125	FAB	00	XX	DR	L	1002	P04