

0m 10m 50m  
scale 1-500

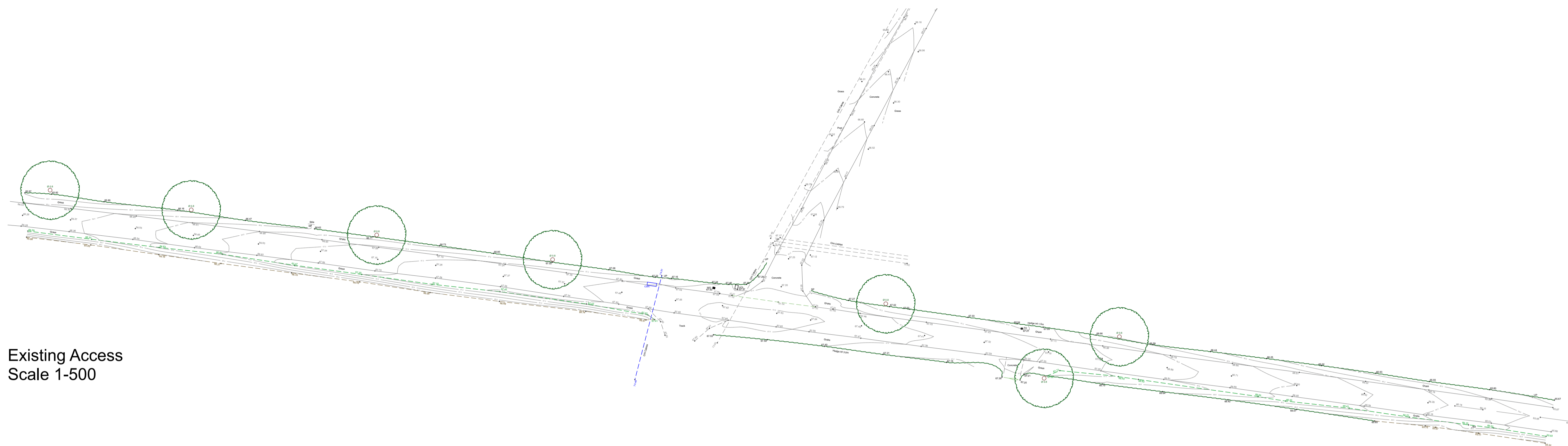

Existing Access  
Scale 1-500

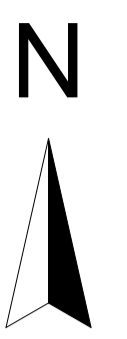
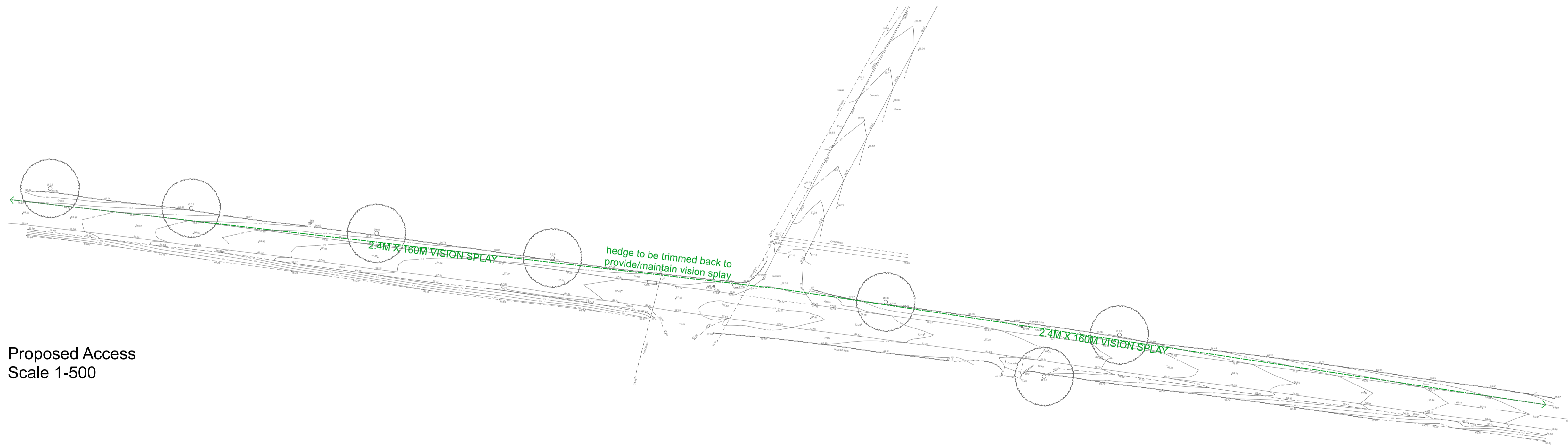

Proposed Access  
Scale 1-500

|       |    |      |          |
|-------|----|------|----------|
| Notes | no | date | revision |
|       |    |      |          |

**JCE** PLANNING & ARCHITECTURAL CONSULTANCY  
Chetwood House • Chilton • HP18 9LS  
01844 267990 • admin@jcemmett.co.uk

THIS DRAWING REMAINS THE SOLE COPYRIGHT OF JEFFREY CHARLES EMMETT ASSOC. R.I.C.S  
All dimensional discrepancies to be referred to JCE Planning & Architectural Consultancy

Full Planning Application

|         |   |                |
|---------|---|----------------|
| project | Wood Farm, Menmarsh Road, Worminghall, HP18 9UP |                |
| title   | Existing and Proposed Access 1-500              |                |
| drawn   | AK  | Project number |
| date    | 05/12/2023                                      | 1357           |
| scale   | 1:500 @ A1                                      | Drawing no     |
|         |   | 1357_PL-04     |