

The Tunnel Inn Barn – Photographs taken 13th December 2023

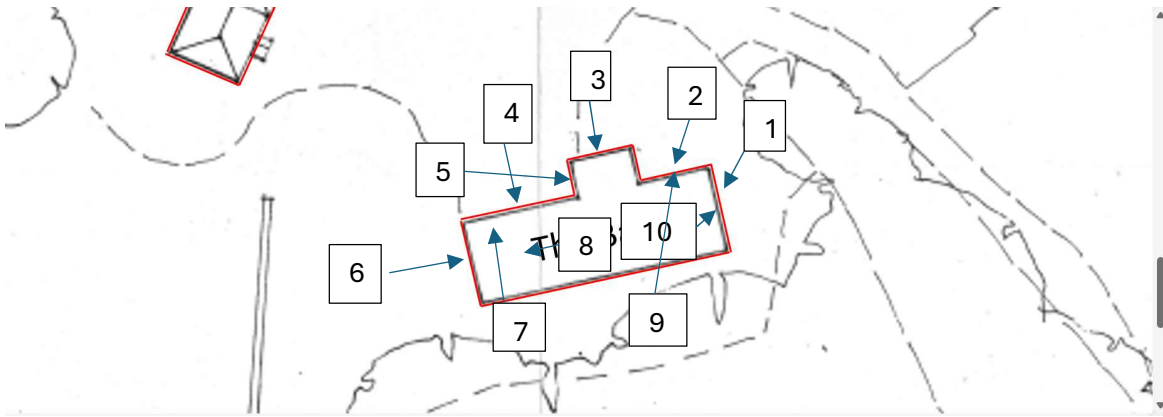

Photograph 1 – eastern gable end, note fully cement pointed verges and closed eaves.



Photograph 2 – eastern end of north facing front elevation, fully tiled and hips close bedded



The Tunnel Inn Barn – Photographs taken 13th December 2023

Photograph 3 – centre of north facing elevation with fully pointed verge and sealed openings



Photograph 4 – western end of north facing elevation with closed eaves, ridge and sealed openings



The Tunnel Inn Barn – Photographs taken 13th December 2023

Photograph 5 – West facing return elevation, closed eaves, ridge and valley details



Photograph 6 – western gable end with eaves details all closed.



The Tunnel Inn Barn – Photographs taken 13th December 2023

Photograph 7 – inside the western end looking north



Photograph 8 - inside looking west, note ceilings closed, no roof void and no indication of bird or bat activity.



The Tunnel Inn Barn – Photographs taken 13th December 2023

Photograph 9 – inside eastern end looking north, eaves and slits all closed, no access points.



Photograph 10 – looking east, ceiling, eaves etc all closed, no voids.

