



NOTES  
It is the contractors responsibility to check design levels and sizes for compliance. Any discrepancies or errors to be identified to the design team.

**Synthetic Pitch Area**  
Length - 25.0m  
Width - 20.0m  
Recesses - 2x 4.0m x 2.0m  
**Total - 516m<sup>2</sup>**

**Playing Lines**  
Football (White)  
Length - 25.0m  
Width - 20.0m

**Basketball Shooting Areas (Blue)**

- Key**
- 2G Synthetic Turf
  - New Access Path Hardstanding
  - 3.0m High Perimeter Fencing

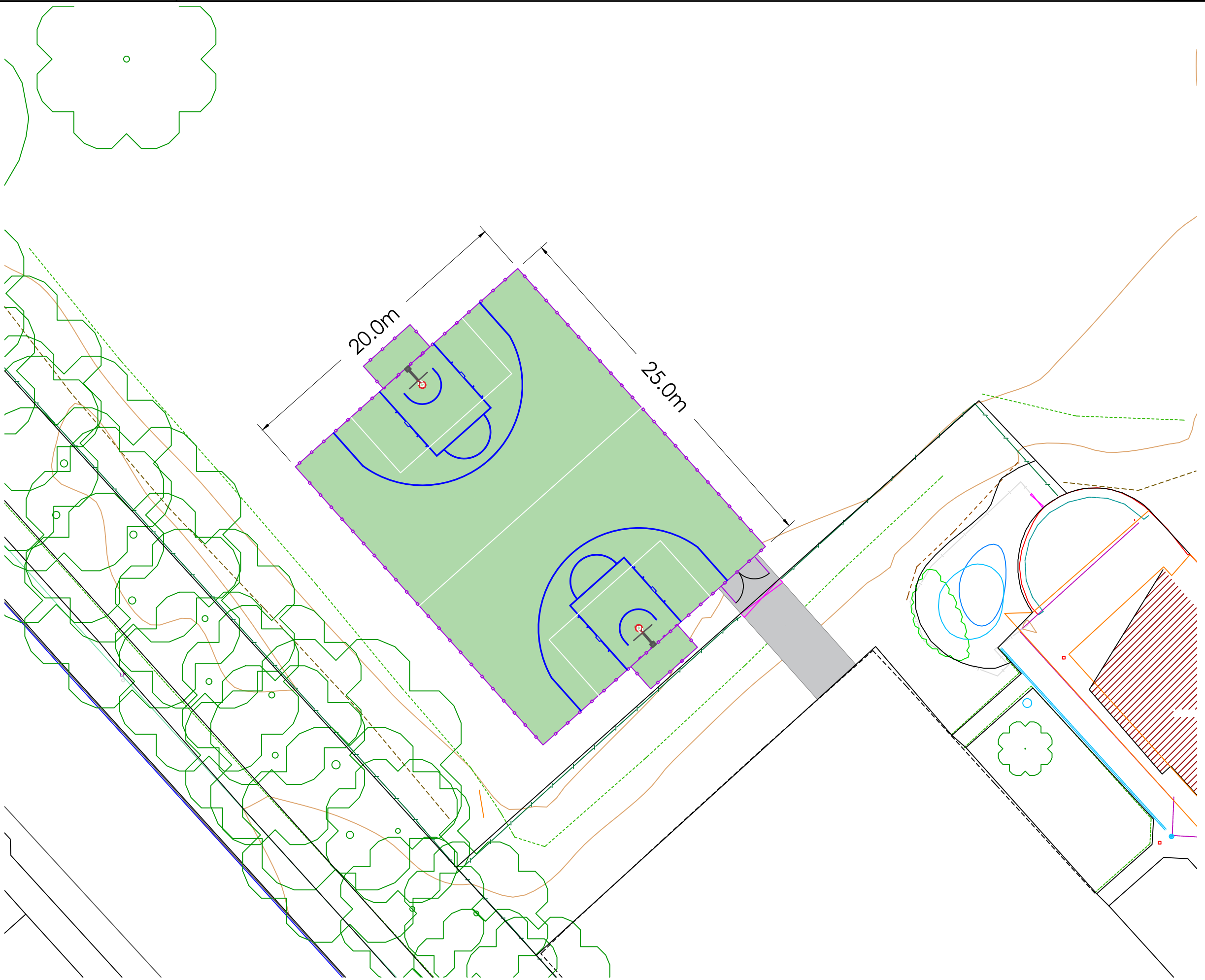

**01** GENERAL ARRANGEMENT  
SCALE: 1:250

REVISION	DETAILS	BY	DATE	CHECKED



info@sportslabsconsult.com

ST GREGORY'S CATHOLIC ACADEMY  
GENERAL ARRANGEMENT  
CONSTRUCTION OF A NEW 2G PITCH



Date: 10/2023 Scale: 1:250 @ A3	Job. No. <b>3219</b>	Drawn by: CH Checked by: DD
------------------------------------	----------------------	--------------------------------