

Rev	Description	Date	BY
0	Site Colouring changed to meet LPA requirements	21.10.2019	rcd

Block Plan 1:500

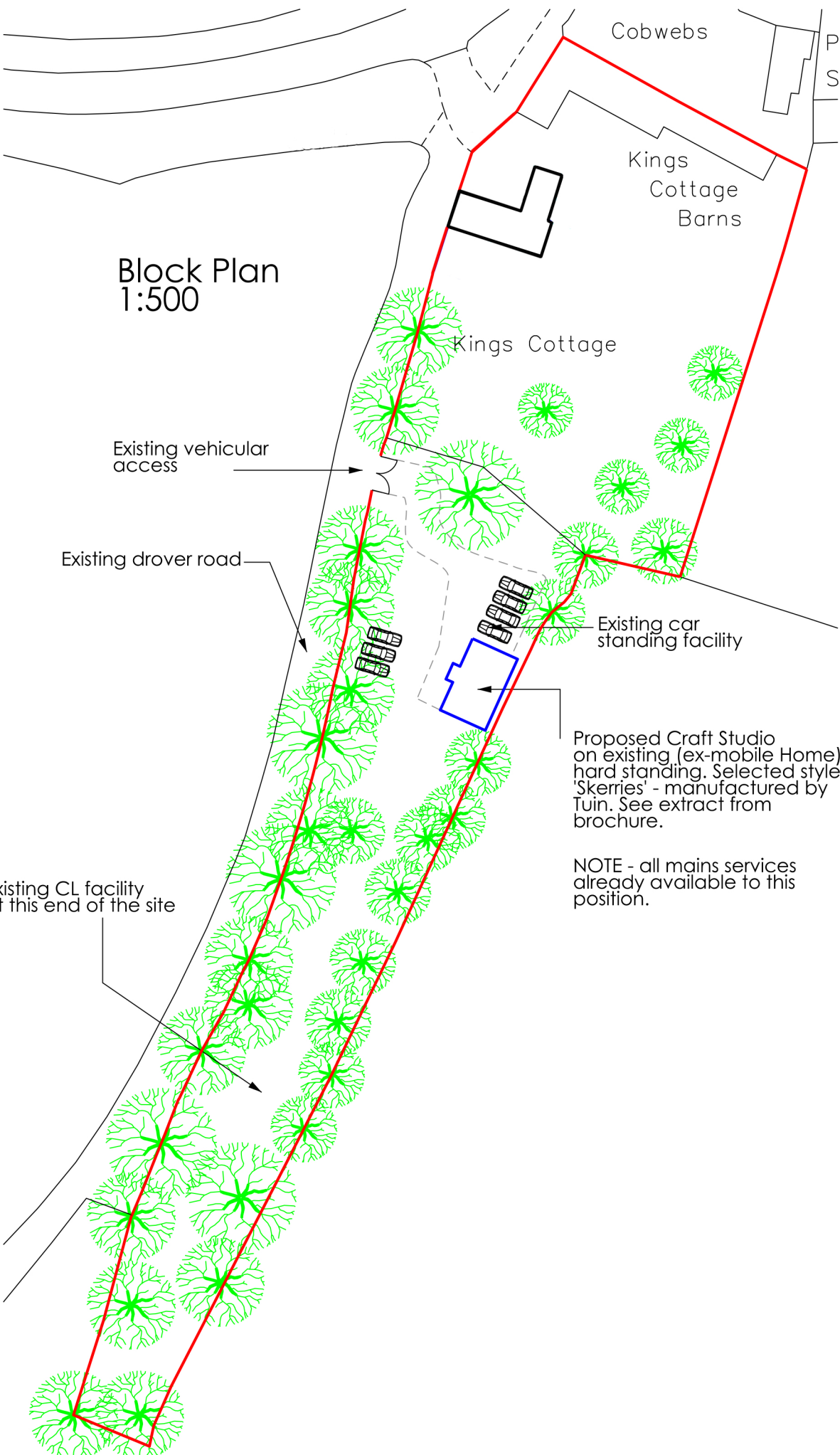

Proposed Craft Studio on existing (ex-mobile Home) hard standing. Selected style 'Skeries' - manufactured by Tuin. See extract from brochure.

NOTE - all mains services already available to this position.



(3) PLANNING

**dykes associates
architects**

Little Orchard - School Road, Brisley, NORFOLK NR20 5LH
 Tel: 07860 274159
 e-mail: adam@dykesassociates.co.uk website: www.dykesassociates.co.uk

client
 Mr. & Mrs. R. Barker

project
 Kings Cottage,
 Fakenham Rd.,
 Stibbard, NR21 0EN

drawing title
 Block Plan

scale @A3 1:500 date 09.10.2019
 by rcd

0 10 20 30 40 50 metres at 1:500 Scale
 scaling from this drawing may be unreliable

sheet number	sheet stage	approval number	revision
4480	(3)	002	a