

Drainage Layout
Scale 1:500

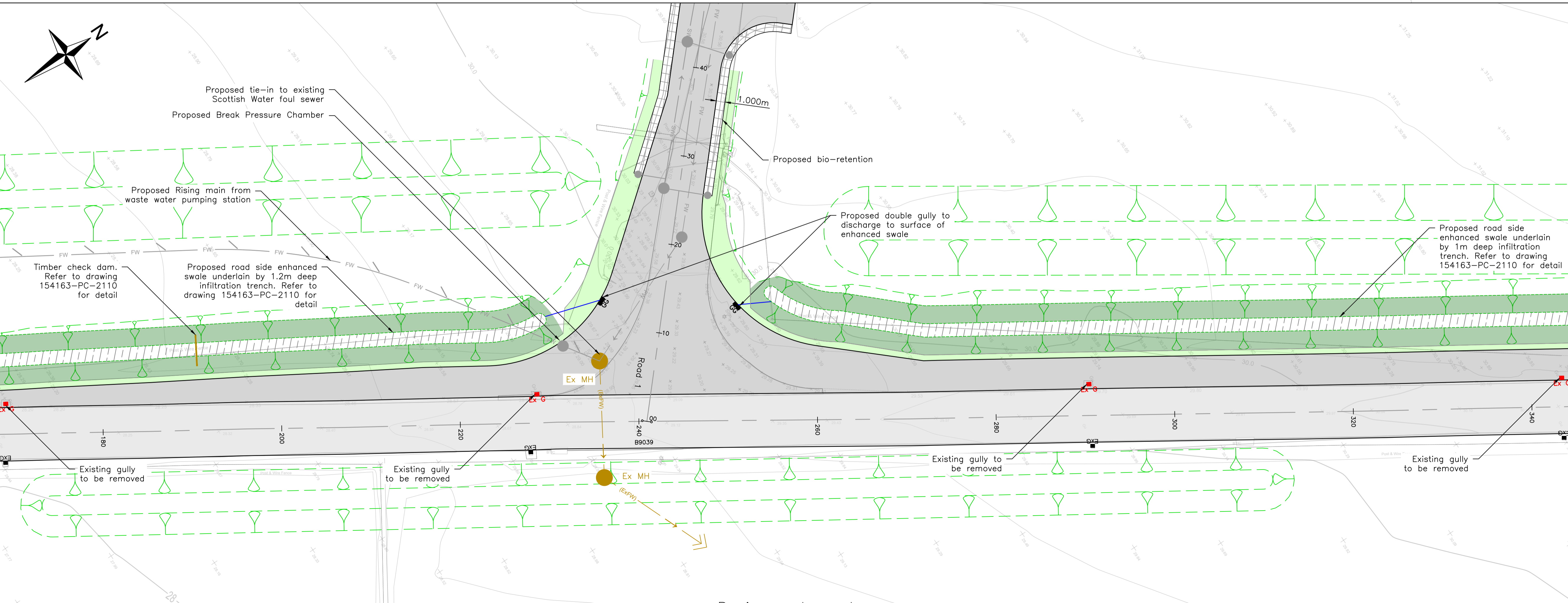

Drainage Layout
Scale 1:250

Legend:

- Proposed Road Surfacing
- Existing Road Surfacing
- Proposed Landscaped Area/Grassed Verge
- Proposed 1m Bio-Retention
- Proposed Enhanced Swale
- Proposed Infiltration Trench Underlying Enhanced Swale
- Proposed Rising Foul Main
- Proposed Foul Water Sewer
- Existing Foul Water Sewer (ExFW)
- Proposed Surface Water Sewer
- Proposed Bio-Retention Collector Pipe
- Proposed Surface/ Foul Manhole (MH)/Inspection Chamber (IC)
- Proposed Gully
- Existing Gully
- Existing Gully to be Removed
- Existing Foul Manhole (Ex MH)

Do not scale from this drawing.

SAFETY HEALTH AND ENVIRONMENTAL INFORMATION

IN ADDITION TO THE HAZARD/RISKS NORMALLY ASSOCIATED WITH THE TYPES OF WORK DETAILED ON THIS DRAWING, NOTE THE FOLLOWING RISKS AND INFORMATION.

RISKS LISTED HERE ARE NOT EXHAUSTIVE. REFER TO DESIGN ASSESSMENT FORM NO. DAF01

CONSTRUCTION:
LIVE PRIMARY ROUTE TRAFFIC (B9039). UTILITIES TO BE DIVERTED/PROTECTED

DEMOLITION:
NONE THAT WOULD NOT BE APPARENT TO A COMPETENT CONTRACTOR

FOR INFORMATION RELATING TO USE, CLEANING AND MAINTENANCE SEE THE HEALTH AND SAFETY FILE.

IT IS ASSUMED THAT ALL WORKS WILL BE CARRIED OUT BY A COMPETENT CONTRACTOR WORKING, WHERE APPROPRIATE, TO AN APPROVED METHOD STATEMENT.

- Notes:**
- All dimensions on this drawing are in metres unless noted otherwise. Do not scale from this drawing, only written dimensions are to be used.
 - This drawing is to be read in conjunction with all architectural and engineering drawings, details and specifications.
 - Any discrepancies should be reported to the engineer immediately so clarification can be sought.
 - All existing services to be located prior to any construction work being carried out. The locating of any mains and services must be undertaken by hand dug trial holes. The approval of the appropriate utility must be sought before any mechanical plant is used.
 - Underground services must be located in accordance with Health and Safety Executive Guidance note HSG 47.
 - For clarity this drawing should only be printed and read in colour.
 - A minimum of 0.6m cover to be provided to all pipework within garden/landscaped areas and a minimum of 1.2m below any road/parking area unless otherwise stated. Pipes under trafficked areas with <0.9m cover to have concrete protection.
 - All manhole and disconnection chamber covers within trafficked areas to be D400 class. A15 class covers sufficient in pedestrian areas.
 - Existing road and sewer tie-in levels to be checked on site by contractor and confirmed to engineer prior to commencement of works.
 - Sewage installation works to be carried out in accordance with Scottish Water's 'Sewers For Scotland, 4th Edition'.
 - The Contractor shall contact the Engineer prior to work commencing should they note any discrepancies or require clarification on any aspect of the design.
 - Location of Existing Scottish Water infrastructure is approximate only and to be confirmed on site.
 - All pipes to be twinwall HDPE unless noted otherwise.

A	23/10/23	Drawing title updated. Road side swales added. Drainage layout updated.	HF	AH	AKF
Rev.	Date	Description	Drawn	Chkd.	Appd.

Client: **FAIRHURST** Castle Stuart Golf LLP

Elvie House
Beechwood Business Park
WICKNESS
IV2 3BW

Tel: 01463 724 544
Fax: 0844 381 4412

Project Title: **Cabot Highlands**

Drawing Title: Upgraded Access Drainage Layout		
Scale at A1:	Status:	
As Shown	Road Construction Consent	
Drawn: HF	Checked: AH	Approved: AKF
Date: 13/07/2023	Date: 21/09/2023	Date: 21/09/2023
Drawing No.: 154163-PC-2100	Revision: A	