

©Crown Copyright. All rights reserved. Licence no. 100019980

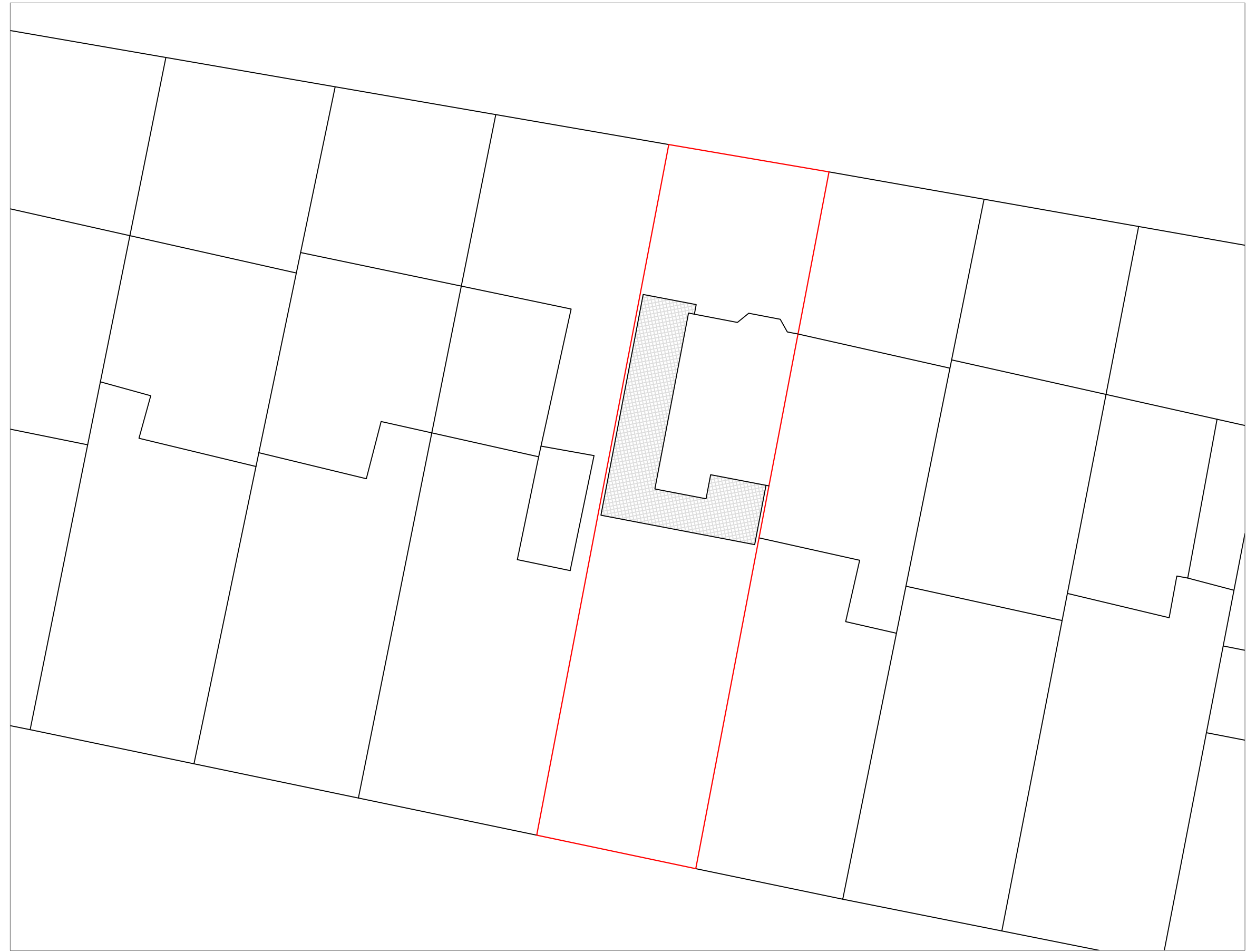
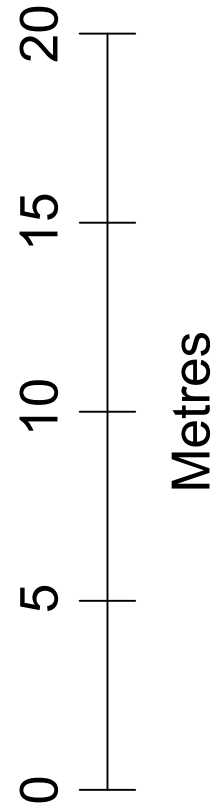
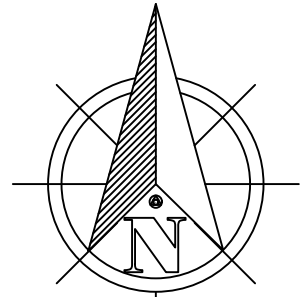

S-(13)03

Site Plans: Proposed Block Plan  
(1:200 @A3)

Date: November 2023 Drawing Number: 23059CB-PP-(13)03 Rev

Project: Two Storey Side & Ground Floor Rear Extension

Client: Mr T Smith & Ms C Baudean

Site Address: 16 Glebe Lane, Maidstone. ME16 9BD



124a North Road, Hythe, CT21 5DY  
t: 01303 237762  
m: 07711 200634

e: [des@building-drawings.co.uk](mailto:des@building-drawings.co.uk)  
w: [www.building-drawings.co.uk](http://www.building-drawings.co.uk)