

156960mN

156920mN

156880mN



Tree Schedule			
1	Fruit	d=0.4	h=7
2	Fruit	d=0.1	h=2
3	Sycamore	d=0.1	h=6
4	Unknown	d=0.15	h=5

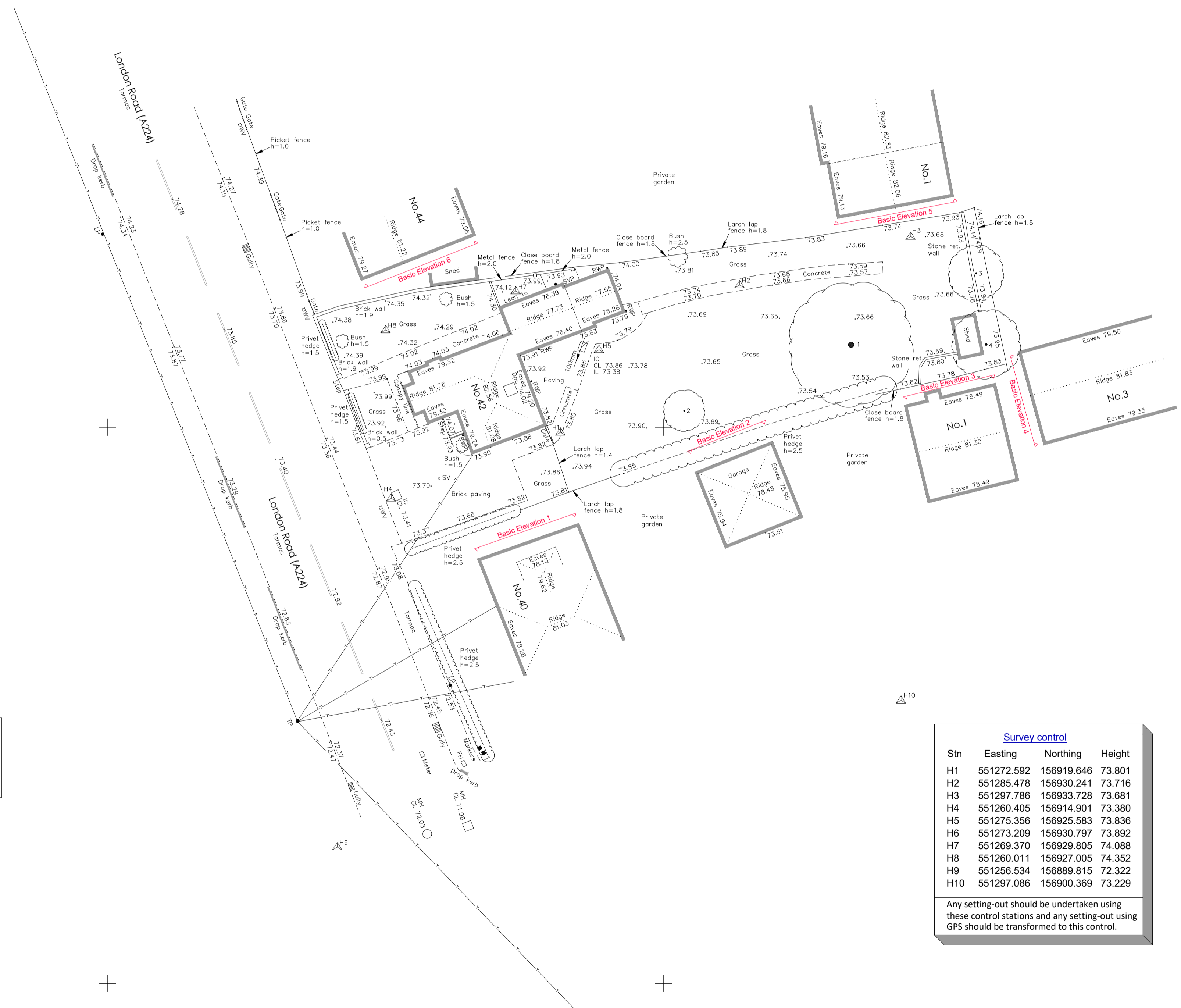

Survey control			
Stn	Easting	Northing	Height
H1	551272.592	156919.646	73.801
H2	551285.478	156930.241	73.716
H3	551297.786	156933.728	73.681
H4	551260.405	156914.901	73.380
H5	551275.356	156925.583	73.836
H6	551273.209	156930.797	73.892
H7	551269.370	156929.805	74.088
H8	551260.011	156927.005	74.352
H9	551256.534	156889.815	72.322
H10	551297.086	156900.369	73.229

Any setting-out should be undertaken using these control stations and any setting-out using GPS should be transformed to this control.

Copyright 2022 Hook Survey Limited
 The Copyright of these Plans shall remain vested with Hook Survey Limited who will grant an irrevocable licence for use by the Client once payment has been received in full. No Third Party may use the plans even if payment has been made to the Client but not received by the Company. Please see our terms and conditions of supply at www.hooksurvey.com for further details.

Topographical Survey Legend

Hedge		Telephone line	
Undergrowth		Power line	
Tree		Banking	
Bush		Contour line	6.4
Building		Survey Station	H5
Glass Building		Gate	
Open Building		Level	115.28
Ordnance Survey Benchmark			
Foul Drainage			
Storm Drainage			

OSBM
 FW MH CL 117.10 IL 116.75
 SW MH CL 117.10 IL 116.75

Abbreviations

Animal Settle	Sett
Air Valve	AV
Borehole	BH
Bus Stop	BS
Cover Level	CL
Earth Rod	ER
Electricity Pole	EP
Fire Hydrant	FH
Inspection Cover	IC
Invert Level	IL
Lamp Post	LP
Manhole	MH
Marker	MK
Name Plate	RNP
Power Pole	PP
Rain water Pipe	RWP
Road Sign	RS
Rodding Eye	RE
Reinforced Steel Joint	RSJ
Soil Vent Pipe	SVP
Stop Valve	SV
Survey Station	STN
Telegraph Pole	TP
Tree Stump	STump
Trial Hole	TH
Unable To Lift	UTL
Vent Pipe	VP
Water Valve	WV

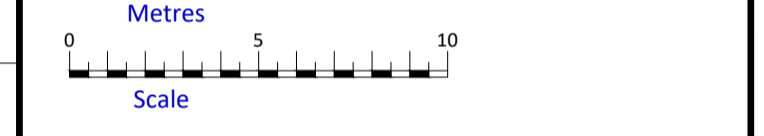

Notes
 All trees are identified where possible. Species, spread, height and girth are indicative only.
 Drainage has been surveyed where found, and traced where possible.
 Eaves and ridge heights of surrounding buildings have been surveyed where possible.

HOOK SURVEY
 Land & Building Surveyors
 www.hooksurvey.com

Project:
 No.42 London Road, Dunton Green, Sevenoaks, Kent TN13 2UG

Client:
 Mr and Mrs Hocking

Drawing title:
 Topographical Survey

Job No. : S23/9508	Dwg No. : S23/9508/01	Revision : -
Scale : 1:200	Date : August 2023	Drawn by : W.M.

Grid & Levels related to:
 Ordnance survey coordinate system using GPS related to the Leica Smartnet RTK network. Based around 3 survey stations with a scale factor of 1.000, only the fixed survey stations H1, H2 and H4 are true Ordnance Survey positions.

Head Office
 Unit 1, Bybow Farm
 Orchard Way
 Dartford, Kent
 DA2 7ER
 Email - mail@hooksurvey.com
 Tel - 01322 277221

Midlands Office
 42 Hanson Avenue
 Shipston-on-Stour
 Warwickshire
 CV36 4HS
 Email - midlands@hooksurvey.com
 Tel - 01608 523118

www.hooksurvey.com