

The use of drawings by the Customer acts as an agreement to the following statements. The Customer must not use the drawings if it does not agree with any of the following statements:
 All drawings are based upon site information supplied by third parties and as such their accuracy cannot be guaranteed. All features are approximate and subject to clarification by a detailed topographical survey, statutory service enquiries and confirmation of the legal boundaries. Do not scale the drawings. Figured dimensions must be used in all cases. All dimensions must be checked on site. Any discrepancies must be reported in writing to ColourUDI, before proceeding. All drawings are copyright protected. Refer to full Terms & Conditions at www.colour-udi.com

	Ownership Boundary		Red Line Boundary
	Existing Vehicular Tarmac to be retained		Existing Pedestrian Tarmac to be retained
	Existing Paving to be retained		Proposed Flag Paving Marshalls Perfects Colour: Buff Size: 450 x 450 x 20mm
	Proposed Block Paving Marshalls Tegula Colour: Harvest Size: 162x120 & 240x160mm		Proposed Vehicular Tarmac
	Proposed Steps To match proposed paving Tactile paving to bottom and top Product: Marshalls Tactile anti-slip paving Colour: Charcoal Size: 400 x 400mm		Proposed Vehicular Tarmac to replace existing (Approximate location)
	Road Kerb Refer to Engineers specification for build up		Flush Kerb Refer to Engineers specification for build up
	Pin Kerb Refer to Engineers specification for build up		Proposed Retaining Wall to match existing
	Existing Retaining Wall		Proposed Balustrade To proposed retaining walls. To match existing Colour: Anthracite grey
	Existing Balustrade To be retained to top of existing retaining walls. Colour: Anthracite grey		Proposed 2.2m High Acoustic Fence & Gates To match Product: 12k acoustic enviro fence Supplier: Jacksons
	Existing 2m High Metal Fence To be retained		Existing 1.8m High Timber Fence To Be Retained. Northern line to be altered in line with proposed plans
	Proposed 2m High Timber Fence Treatment: Close board Finish: All timber to match proposed cycle shelters		Proposed Vertical Bar Railings Height: 2m Supplier: Jacksons Colour: Black
	Gates To match corresponding fence type		
Softworks			
	Existing Tree To be retained		Proposed Tree
	Existing Tree To be removed		Existing Structure Plantin To be retained
	Existing Structure Planting To be retained and trimmed back where necessary		Proposed Hedge Planting
	Proposed Shrub Planting		Proposed Amenity Grass Planting
	Proposed Species Rich Grassland Product: WFG18 Butterfly & Honeybee Supplier: Germinal Amenity		
Furniture			
	Proposed Benches Product: iGlife III Bench Supplier: Streetle Refer to NBS Q50 120		Proposed Light Bollard To main entrance
	Proposed Lamp Post		Proposed Cycle Shelter by Green Roof Shelters Refer to NBS Q50 212
	DDA Active Charging Bay		Proposed CCTV Column
	EV active charging bay Upswinging vehicle charging point to be 2.3m or less		DDA Bay
	Shared vehicle parking		Litter Bin Product: Wyatt Capacity: 50 liters Supplier: Vybone or similar approved Finish: Clear oil

197 Parking Bays in total:
 -157 Car parking bays
 -20 Shared vehicle bays
 -10 EV Active bays
 -9 Disabled bays
 -1 EV Active Disabled bay
 and 70 Cycle Storage spaces (10 of which have EV charging capabilities)

P09	Layout updated following comments	02.08.23	CJT	CJT
P08	Layout updated following comments	02.08.23	CJT	CJT
P07	Layout updated following comments	09.06.23	AH	CJT
P06	Layout updated following comments	16.05.23	CJT	CJT
P05	Layout updated following comments	04.05.23	AH	CJT
Rev	Amendments	Date	Drawn	Chkd

Project
 Boldon House, Pity Me
Drawing Title
 Landscape Masterplan

Project No. 2341 **Scale @ A1** 1:250 **Project Status** Stage 3
Drawing No. BOL-COL-XX-XX-DR-L-1000 **Revision** P09

London 0207 38 78 560 **Newcastle** 0191 24 24 224 **York** 01904 925 888 **colour**
www.colour-udi.com

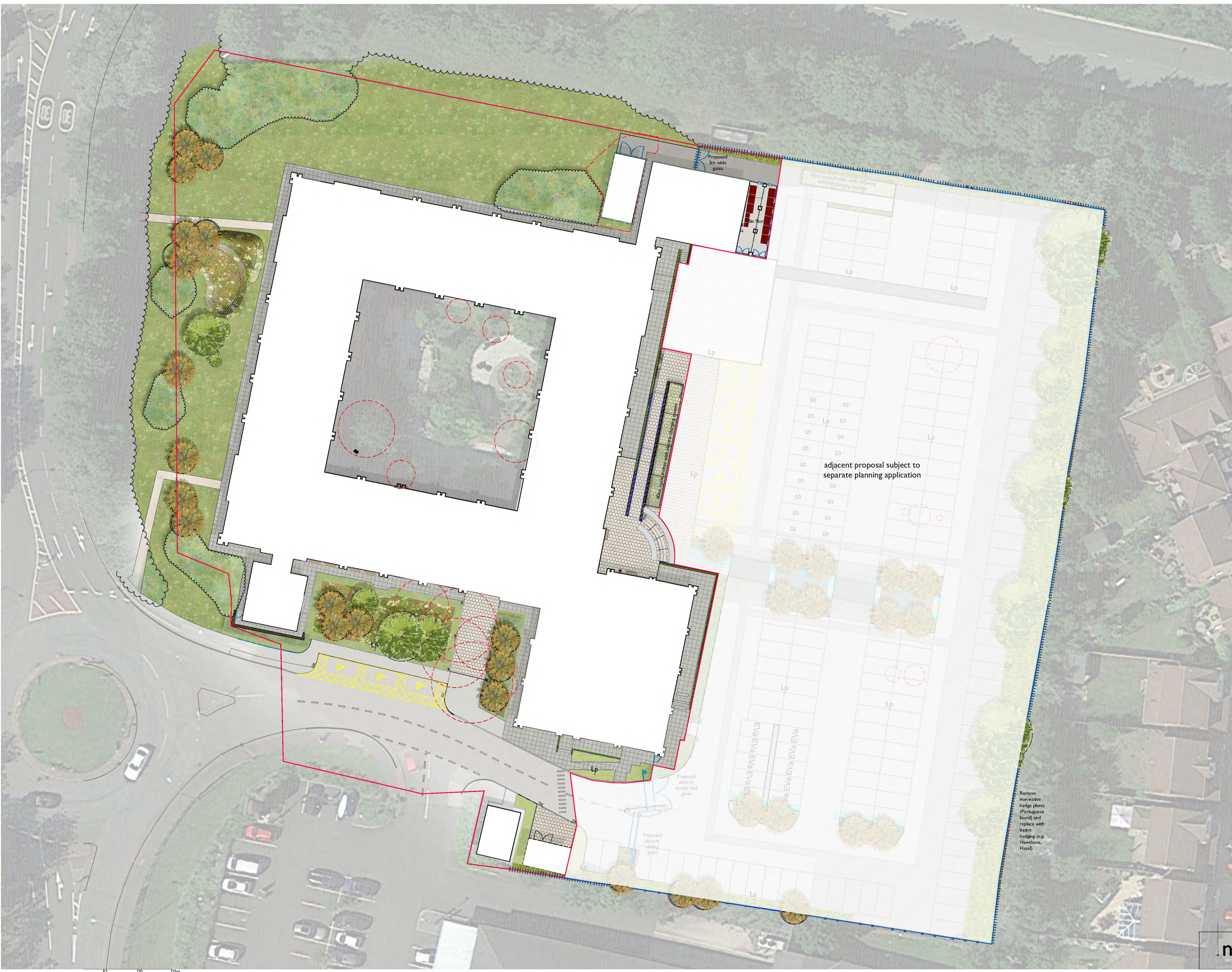

adjacent proposal subject to separate planning application

Remove non-native hedge plants (Portuguese laurel) and replace with native hedging (e.g. Hawthorn, Hazel)