

- PLANNING GENERAL NOTES:**
1. THE DRAWINGS, DESIGN AND ALL INFORMATION CONTAINED THEREIN ARE THE SOLE COPYRIGHT OF CANHAM CONSULTING LTD AND ANY REPRODUCTION IS FORBIDDEN UNLESS PERMISSION IS OBTAINED IN WRITING.
 2. ALL DRAWINGS SHALL BE READ IN CONJUNCTION WITH ALL RELEVANT OTHER DRAWINGS AND SPECIFICATIONS.
 3. ANY DISCREPANCIES BETWEEN THE INFORMATION GIVEN BY THE ENGINEER, AND THAT PROVIDED BY OTHERS, MUST BE REFERRED TO THE ENGINEER BEFORE THE AFFECTED WORKS PROCEED.
 4. DIMENSIONS MUST NOT BE SCALED FROM THE ENGINEER'S DRAWINGS.
 5. ALL DIMENSIONS ARE IN METRES UNLESS NOTED OTHERWISE.
 6. THE INFORMATION SHOWN DOES NOT CONSTITUTE TECHNICAL APPROVAL FROM THE RELEVANT AUTHORITIES AND COULD BE SUBJECT TO CHANGE POST PLANNING.
 7. THE PROPOSED SITE LAYOUT SHOWN ON THIS DRAWING IS BASED UPON THE CHAPLIN FARRANT DRAWING BGM-CF-Z-XX-M2-A-6832, DATED 2023.10.10.

LEGEND

	PERMEABLE PAVING DRAINING TO SURFACE WATER NETWORK (0.318ha)
	RAIN GARDENS (0.042ha)
	GREEN ROOF (0.067ha)
	IMPERMEABLE ROOF (0.186ha)
	HARD LANDSCAPING (0.109ha)
	SOFT LANDSCAPING (0.081ha)

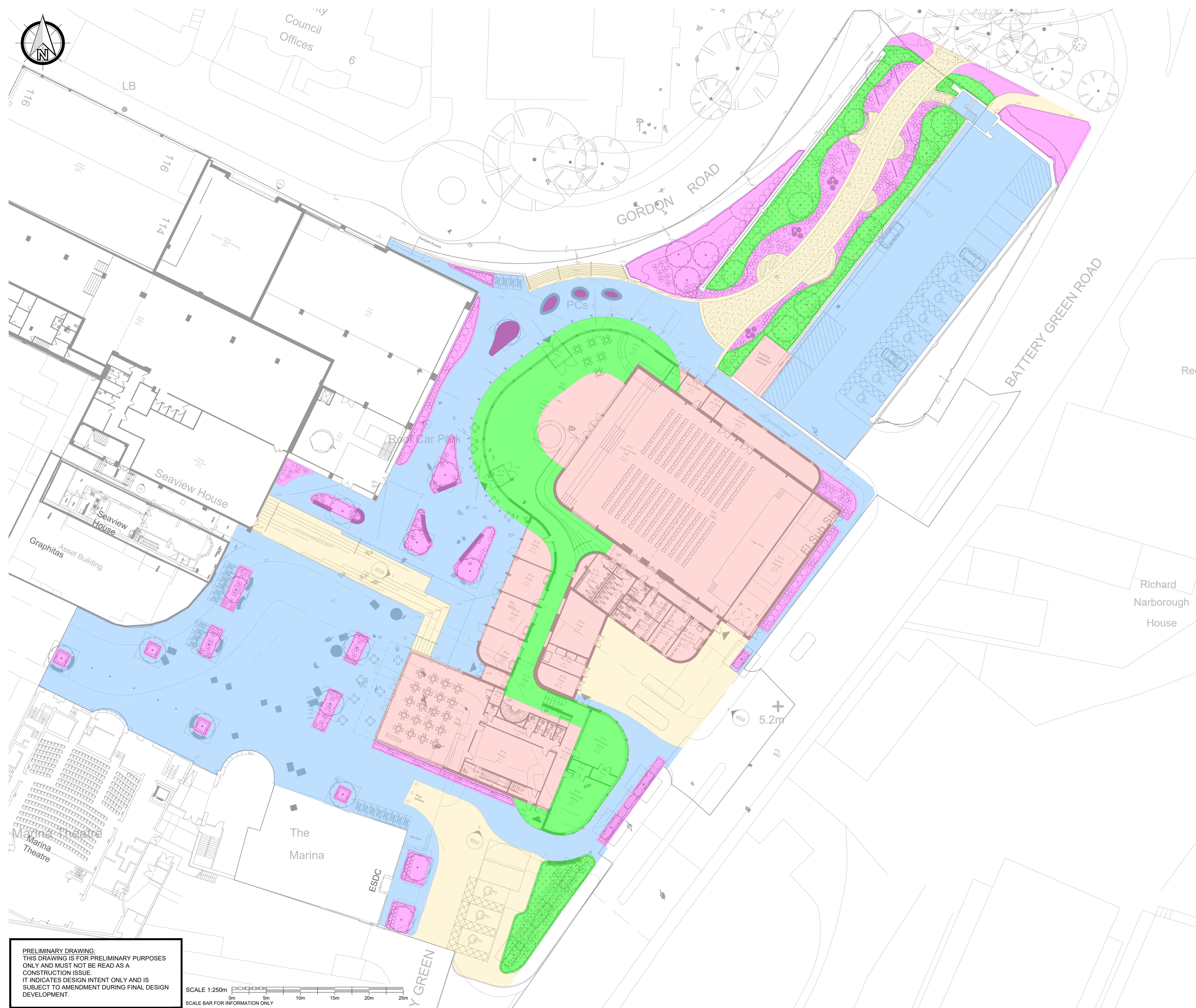

P01	17.11.23	PRELIMINARY ISSUE	GPC	MH
rev	date	details	drawn	check

Canham Consulting
Structural Civil Building Engineers

+44 (0)1603 430650 | mail@canhamconsulting.co.uk | www.canhamconsulting.co.uk
client: EAST SUFFOLK COUNCIL

architect: CHAPLIN FARRANT

project: REDEVELOPMENT OF BATTERY GREEN AND THE MARINA CENTRE

title: DRAINAGE STRATEGY: PROPOSED IMPERMEABLE AREAS PLAN

CCL ref:	drawn	design	checked	scale	size	date
218070	GPC	GPC	MH	1:250	A1 (L)	17.11.2023

status: S3 - SUITABLE FOR REVIEW & COMMENT

drawing number: 218070-CCL-XX-00-DR-C-3001 P01

© This drawing is copyright and is not to be reproduced without the written permission of Canham Consulting Ltd

PRELIMINARY DRAWING:
THIS DRAWING IS FOR PRELIMINARY PURPOSES ONLY AND MUST NOT BE READ AS A CONSTRUCTION ISSUE.
IT INDICATES DESIGN INTENT ONLY AND IS SUBJECT TO AMENDMENT DURING FINAL DESIGN DEVELOPMENT.

SCALE 1:250m
SCALE BAR FOR INFORMATION ONLY

THIS DESIGN IS PRODUCED IN ACCORDANCE WITH THE CONSTRUCTION DESIGN AND MANAGEMENT REGULATIONS 2016 INCORPORATING THE APPROVED CODE OF PRACTICE REGULATIONS 17 AND 17. THOSE ALTERING THE DESIGN WITHOUT THE AUTHORITY OF CANHAM CONSULTING LTD SHOULD BE AWARE THEY MAY ALSO ASSUME RESPONSIBILITY FOR THOSE CHANGES.