

This drawing is produced as a document for use in this project only and may not be used for any other purpose. The license is granted only to the specific recipients of the drawing directly from Chaplin Farrant Ltd. Chaplin Farrant Ltd accepts no liability for the use of this drawing other than the purpose for which it was intended in connection with this project as recorded on the title block and 'File Status Code' and 'Revision'. If also issued in digital format, the data within this file may not be used for any purpose other than the information present on the paper copy of the document.

Chaplin Farrant Copyright © 2018. This drawing may not be reproduced in any form without Chaplin Farrant's prior written agreement.

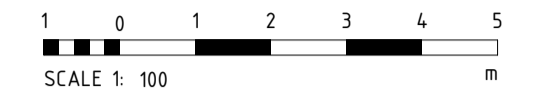

NOTES

This drawing contains the following:

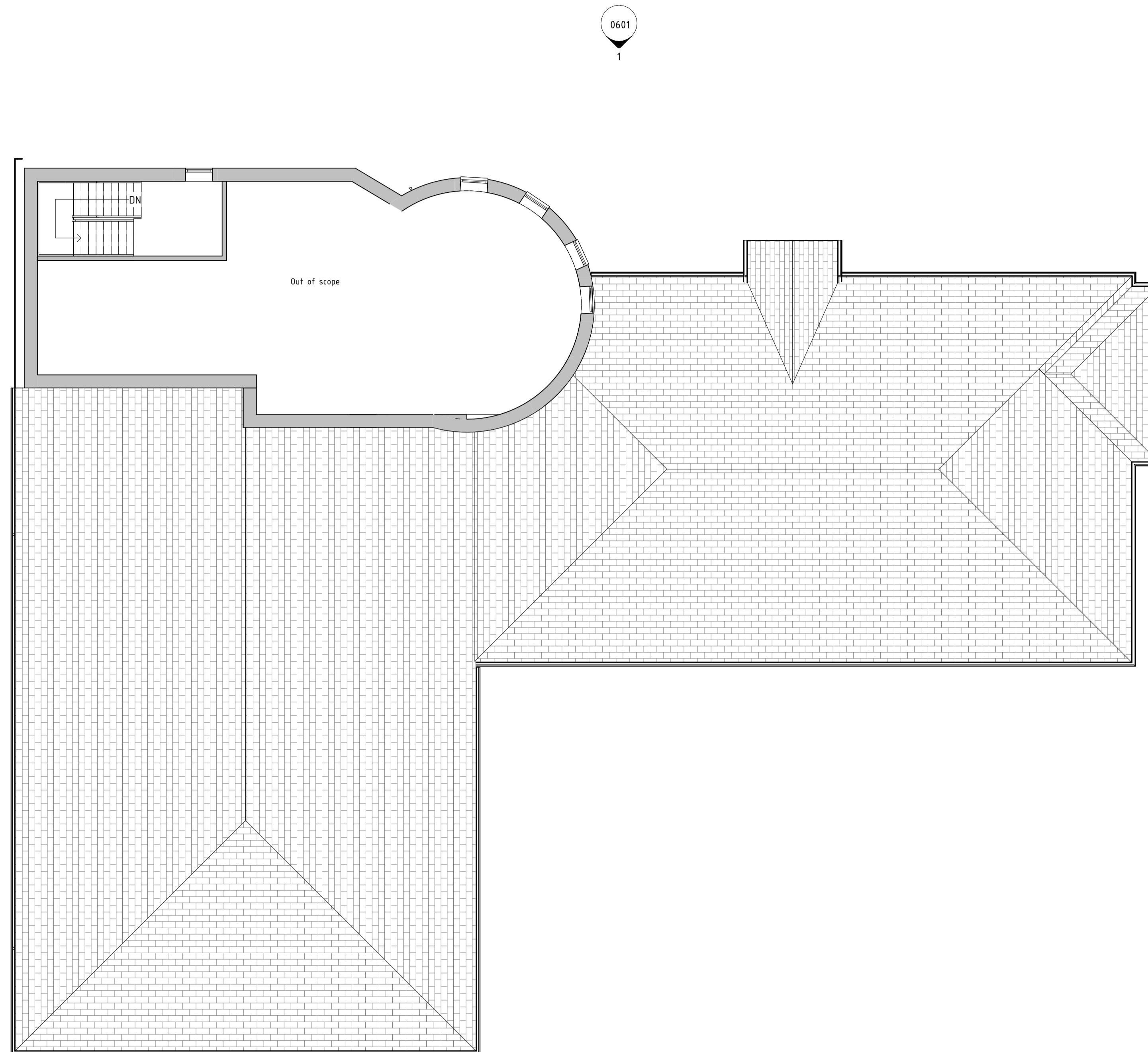

REVISION LOG

| ISSUED | REV | DATE | DESCRIPTION |
|--------|-----|----------|-----------------|
| FS | P1 | 14/06/23 | First issue |
| FS | P2 | 09/11/23 | Drawing updated |
| FS | P3 | 22/11/23 | Planning issue |

CLIENT

East Suffolk Council

PROJECT

Battery Green Marina Centre

PROJECT ADDRESS

Marina Centre, Marina, Lowestoft, NR32 1HH

| DRAWING USE | STATUS CODE |
|-------------|-------------|
| PLANNING | S4 |

| DRAWING TITLE | SIZE |
|-------------------------|------|
| Second Floor - Existing | A1 |

| DRAWING NO. | REVISION |
|------------------------|----------|
| BGMC-CF-B-XX-DR-A-0582 | P3 |

| CREATED BY | CHECKED BY | APPROVED BY |
|------------|------------|-------------|
| FS | SD | MC |

| 53 Yarmouth Road Norwich NR7 0ET 01603 70000 office@chaplinfarrant.com | CF JOB NO. 6832 |
|--|--------------------|
|--|--------------------|

Also at:
Cambridge and Winchester
www.chaplinfarrant.com



1 Second Floor As Existing

1 : 100