

**Fences Key**

- existing 1.8m metal palisade
- - - existing 1.8m timber board
- existing 1.1m timber board
- - - proposed 1.8m timber board

**Landscaping Key**

- existing trees retained
- existing low level shrubs
- existing trees removed
- proposed native trees

**Parking Provision**

- Car - 22 No. spaces (2.4 x 4.8m)
- Bicycle - 68 No. spaces (34 per container)

**Waste Storage Provision**

approx. 15 m<sup>2</sup>

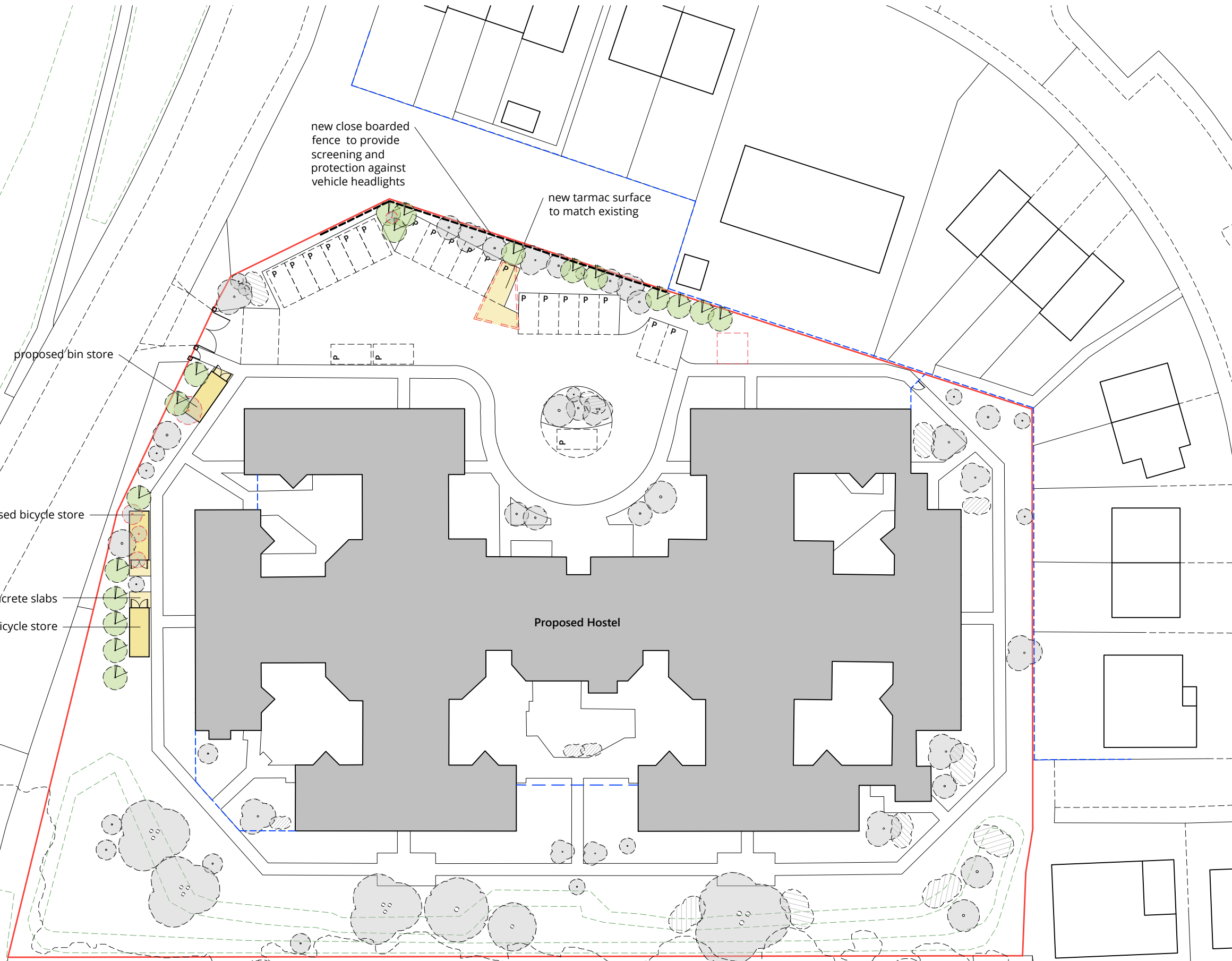

**Proposed Site Plan**  
Scale 1:500

REV	DESCRIPTION	BY	DATE
-	-	-	-

STATUS **PLANNING**

**MMA** Macaulay Miller Architecture  
www.mma.eco

MMA North, 36 King Harald Street, Lerwick, ZE1 0EQ  
 MMA South, 20-23 Woodside Place, Glasgow, G3 7QL email: mail@mma.eco

CLIENT **Broomfield Court**

PROJECT Convert former care home into hostel at  
 751 Broomfield Road, Barmulloch, Glasgow  
 G21 3HQ Glasgow City Council

DRAWING **A003 proposed site plan**

1:500 0 5 30 m