

Existing Site Plan
Scale - 1:200@A3

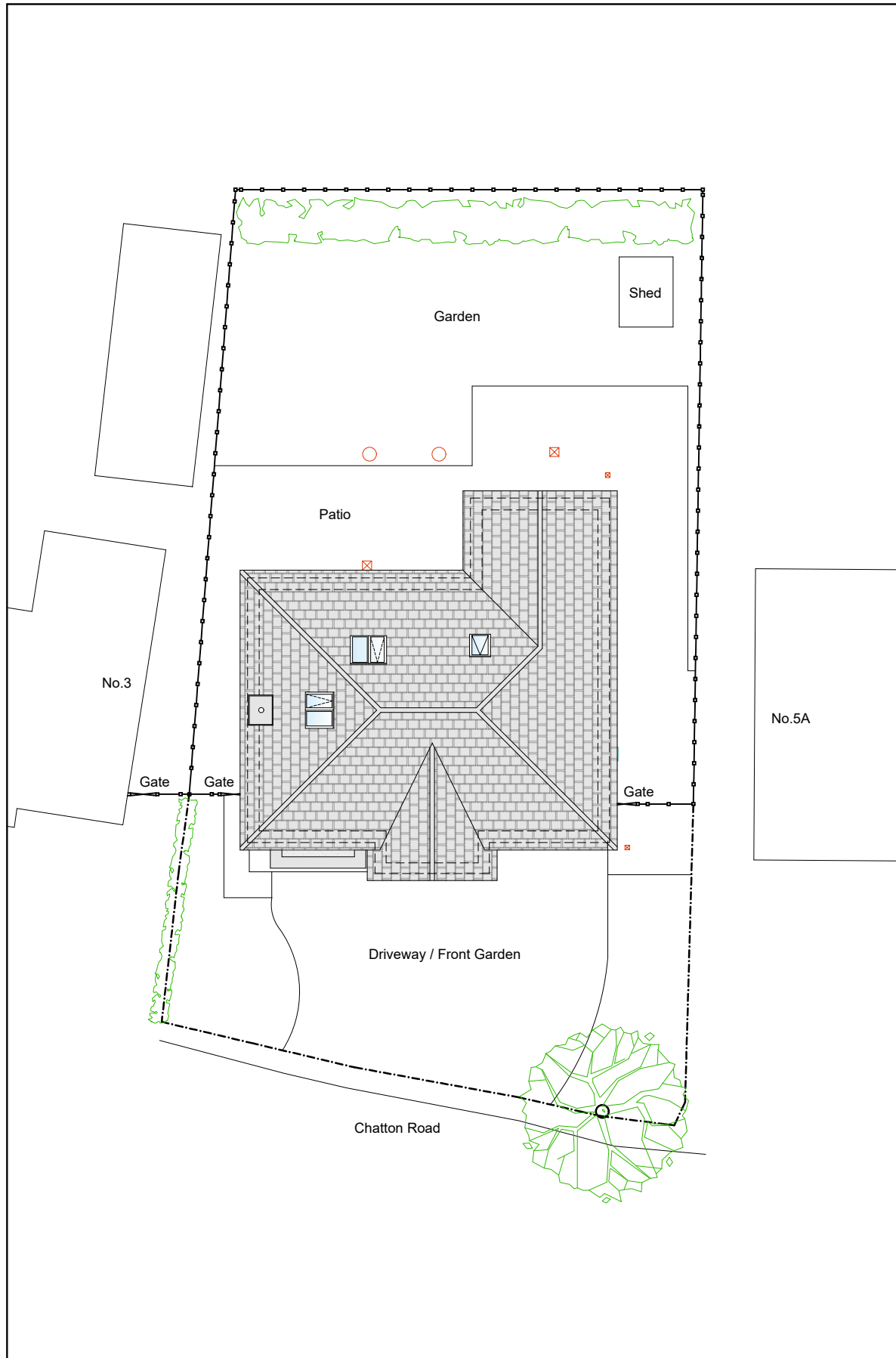

Proposed Site Plan
Scale - 1:200@A3

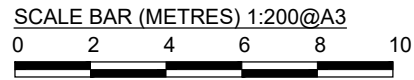

COPYRIGHT ©
 DETAILS OF THIS DRAWING ARE THE COPYRIGHT OF ASPIRE ARCHITECTURAL SERVICES LTD AND MUST NOT BE REPRODUCED OR COPIED WITHOUT PRIOR WRITTEN CONSENT.
 ANY ERRORS OR OMISSIONS ARE TO BE REPORTED TO THE ARCHITECT IMMEDIATELY.
 ALL PROPOSED ROAD AND JUNCTION ALTERATIONS SUBJECT TO HIGHWAYS ENGINEERS DETAILED DESIGN.
 REMOVAL OF ANY EXISTING TREE AND LANDSCAPED AREAS SUBJECT TO NEGOTIATIONS WITH LOCAL AUTHORITY PLANNING DEPT AND OTHER STATUTORY CONTROLS.
 ALL DRAWINGS TO BE READ IN CONJUNCTION WITH STRUCTURAL ENGINEERS DRAWINGS AND ALL RELATED ARCHITECTS AND CONSULTANT DRAWINGS AND OTHER RELEVANT INFORMATION.
 ANY CHANGES TO THE DRAWN DESIGN DURING CONSTRUCTION WORK SHOULD BE RECORDED AND REPORTED TO THE DESIGNER IMMEDIATELY.
 ASPIRE ARCHITECTURAL SERVICES LTD WILL NOT TAKE RESPONSIBILITY FOR ANY VARIATION MADE BY OTHERS TO THE DESIGN AND CONSTRUCTION DETAIL CONTAINED WITHIN THIS DRAWING.

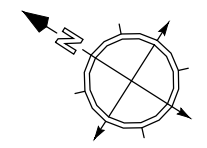

REV	DATE	VARIATION



WWW.ASPIRE-AS.CO.UK
 UNIT 3, FOXHILLS FARM BUSINESS CENTRE
 LONGCROSS ROAD
 CHERTSEY
 KT16 0DN
 TEL: 01932 988520

Project CHERRY HOUSE, 3A CHATTON ROW, BISLEY, WOKING, SURREY, GU24 9AP		
Title EXISTING AND PROPOSED SITE PLANS		
Drawn By AG	Checked ASPIRE	Date DEC 23
Drawing Number 2169-120	Revision -	Scale 1:200@A3
Client -		

Planning