

Areas	
<b>EXISTING</b>	
<b>House</b>	
Basement	19.5m <sup>2</sup>
Ground	157.5m <sup>2</sup>
First Floor	151m <sup>2</sup>
Annexe	24m <sup>2</sup>
TOTAL	352m <sup>2</sup>
<b>Residential Units in Outbuilding</b>	
Unit 1 Ground	33m <sup>2</sup>
Unit 1 First Floor	22m <sup>2</sup> (1.5m min headheight)
Unit 2 Vacant	N/A
TOTAL	55m <sup>2</sup>
<b>TOTAL EXISTING</b>	<b>407m<sup>2</sup></b>
<b>PROPOSED</b>	
<b>House (Retained)</b>	
Basement	19.5m <sup>2</sup>
Ground	157.5m <sup>2</sup>
First Floor	151m <sup>2</sup>
Annexe	0m <sup>2</sup> (Demolished)
TOTAL	328m <sup>2</sup>
<b>Proposed Residential Units</b>	
Unit 1	79m <sup>2</sup>
Unit 2	80m <sup>2</sup>
Unit 3	79m <sup>2</sup>
Unit 4	79m <sup>2</sup>
TOTAL	317m <sup>2</sup>
<b>TOTAL PROPOSED</b>	<b>645m<sup>2</sup></b>

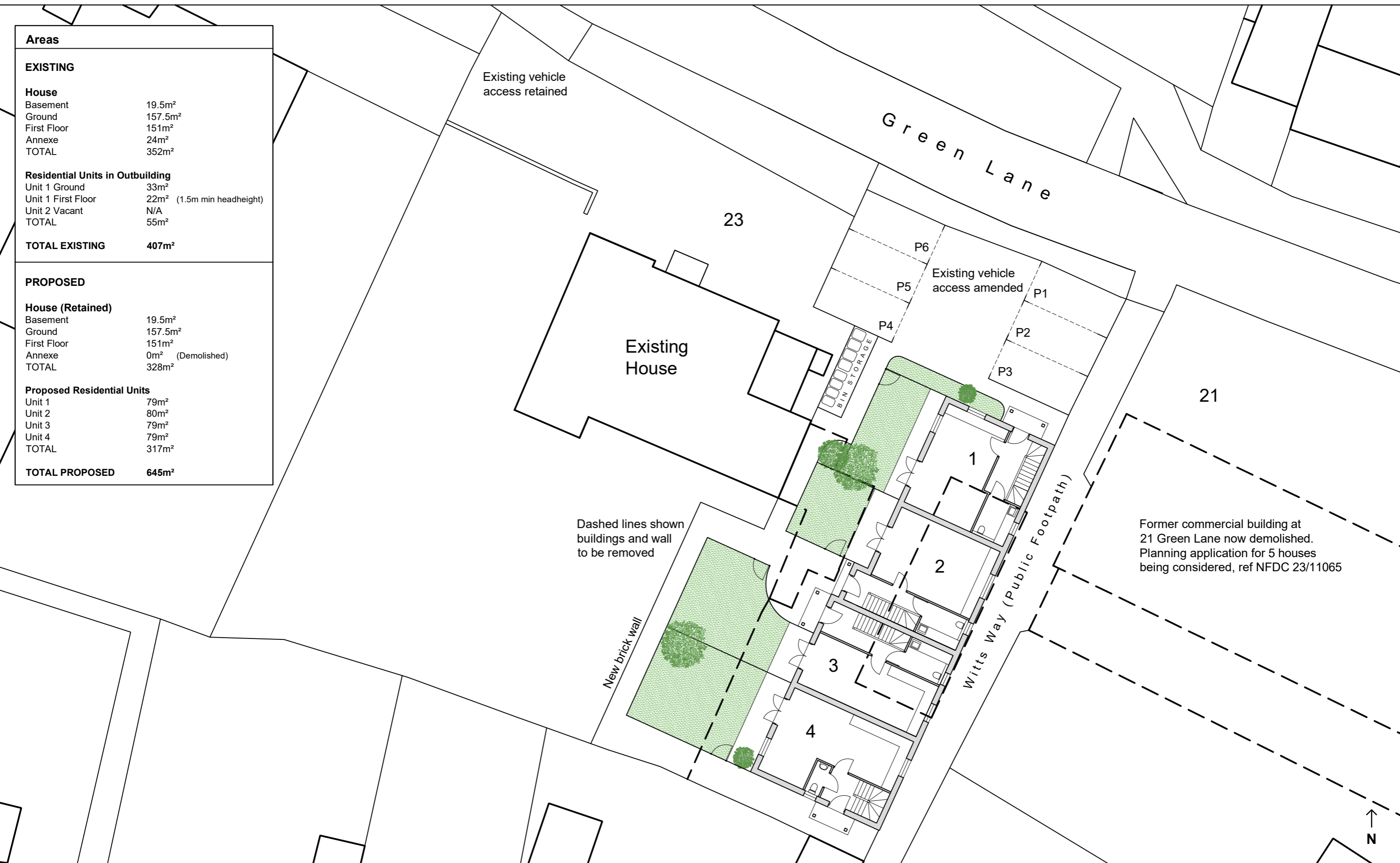

Dashed lines shown buildings and wall to be removed

Former commercial building at 21 Green Lane now demolished. Planning application for 5 houses being considered, ref NFDC 23/11065