

Work to figured dimensions only and check all dimensions on site
Please report any discrepancy to architect © ASCENT ARCHITECTURE

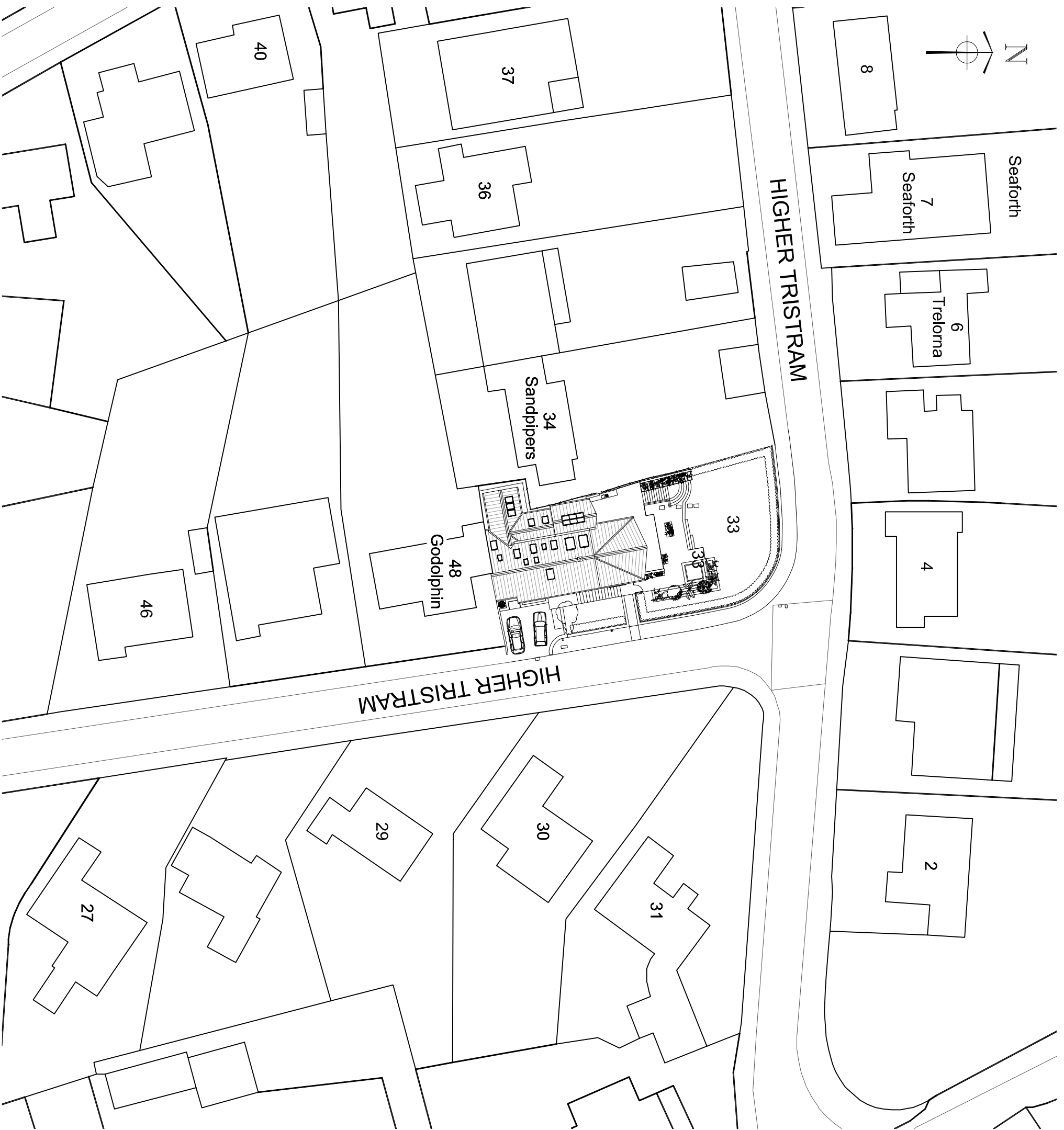
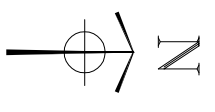

REVISIONS
A: -

Ascent
ARCHITECTURE
81-83 STOKES CROFT
BRISTOL BS1 3RD
T: 0117 942 9515
E: info@ascentarchitecture.com
www.ascentarchitecture.com

Project
Proposed Extension & Remodelling
Marmarra, 33 Higher Tristram, Polzeath PL27 6TF

Client
Mr & Mrs Horswell
Detail
Proposed Block Plan

Drawing no. 221/10
Revision -
Scale 1:500@A3
Date 14/12/23
Drawn SGM