

NOTES

1. Do not measure from drawings for installation purposes

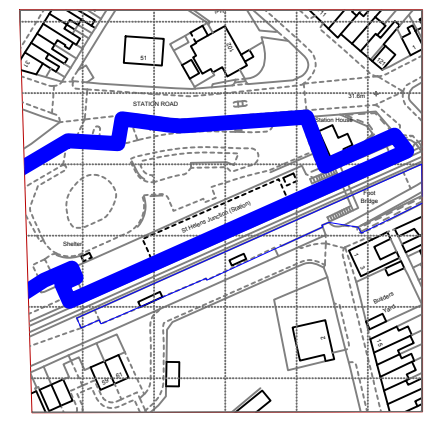

Location 1:1250

Detail A

Sizes to suit each individual sign.
150mm clear around base of sign
Constructed of 44mm galvanised steel
Painted RAL Yellow
Resin bolt floor fixing

Detail B

35mm Frame bezel on a 250x250x4 steel plate
100x100x3 box steel legs
mechanically fixed to 300x300x50 concrete foundation
PPC to TOC colours

Detail C

100mm x 100mm strongbox square section support posts
50mm x 50mm strongbox section roof framework,
3mm Pet-g UV2 roof sheets.
Framework produced from steel strongbox section to EN 10219:2006
CPA Assured Galvanising applied to inside and outside surfaces as standard,
and is a corrosion resistant zinc coating to BSEN1461
Pet-G UV2 clear sheeting
Mechanically fixed to concrete footings

A Tapping Rail
1:30 @A1

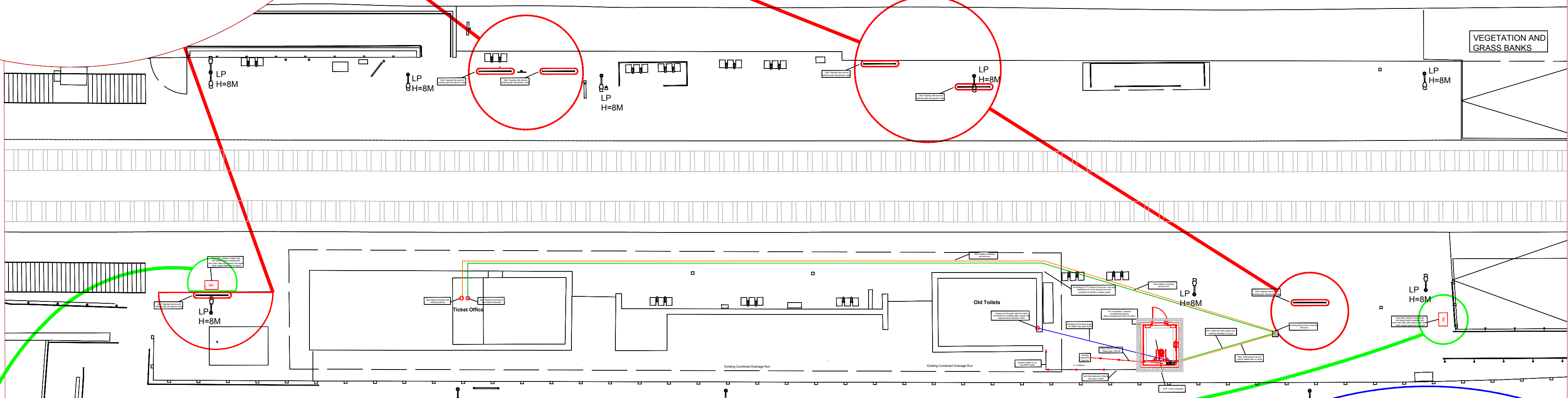

B Braille Stands
1:20 @A1

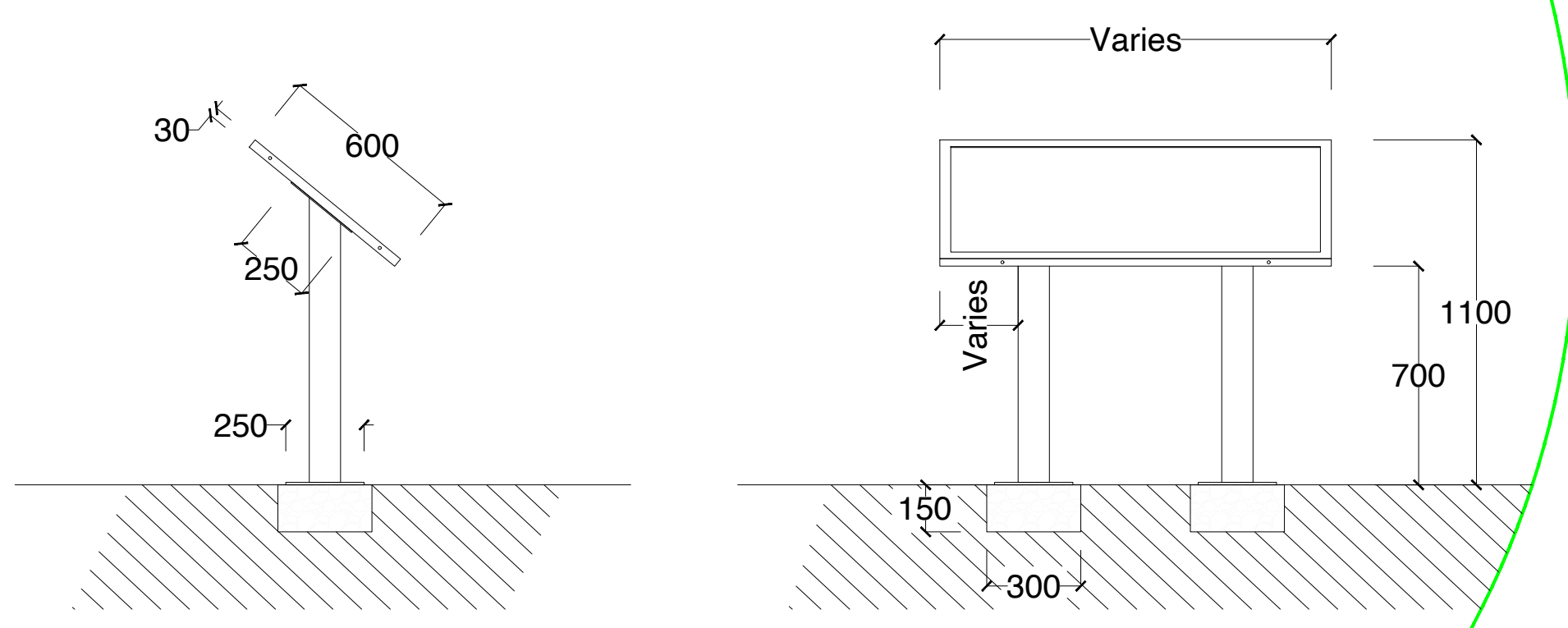

C Drop Off
1:50 @A1

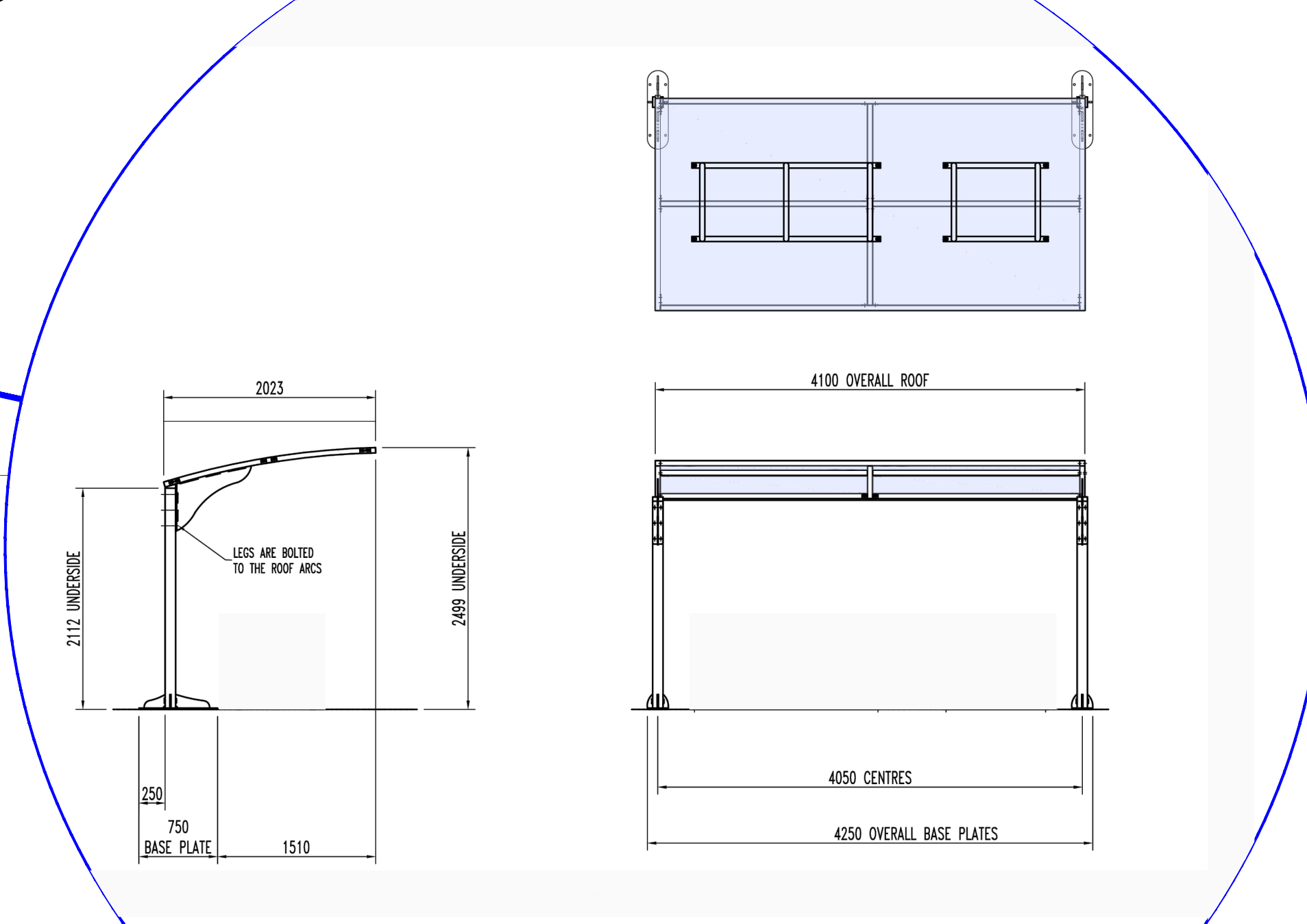

Revision	0.1	Drawing created.	SA	01.09.23		
Location Figure						
Sheet Size	A1	Scale	As indicated (@A1)	Status	IDC	
Contractor Name	n/a	Based on Drawing No.	n/a	Drawn by	SA	
Project	Accessibility Package				Checked by	SA
Drawing Title	St Helens Details				Rev	P01
Drawing No.	GEN-001					