

Note: This Drawing is for planning purpose and should not be used for construction.
 All dimensions should be confirmed on site and any deviation should be reported back to designer.

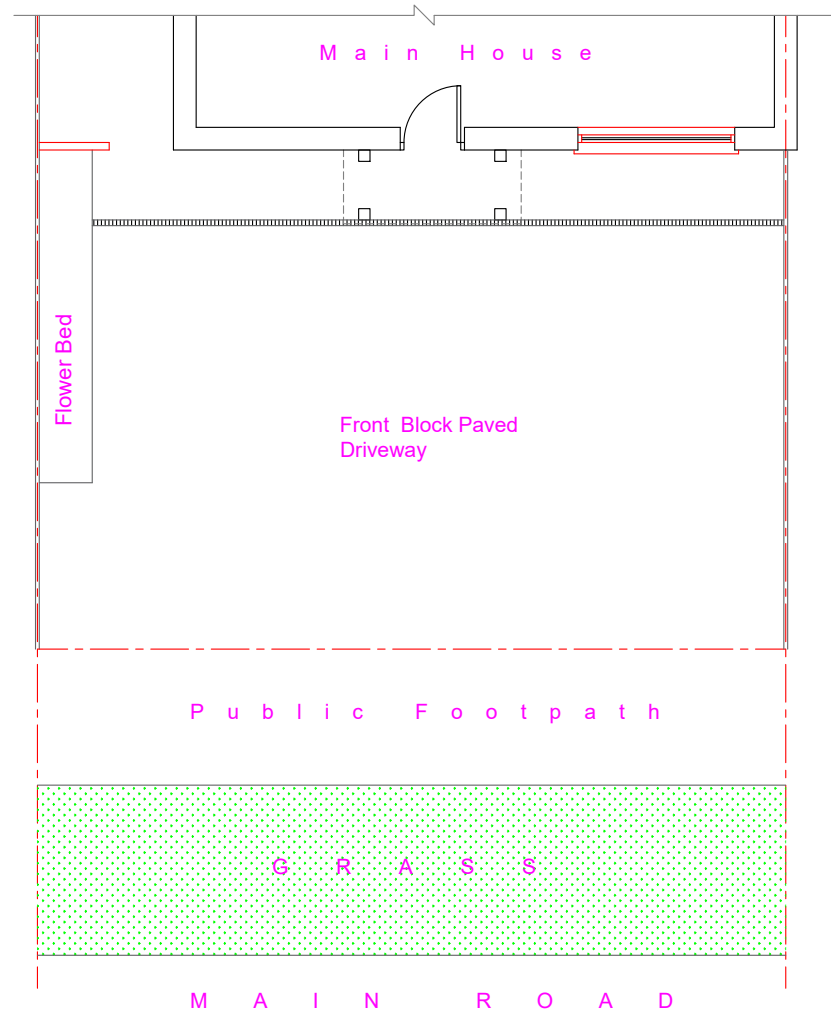

Existing Front Driveway Layout

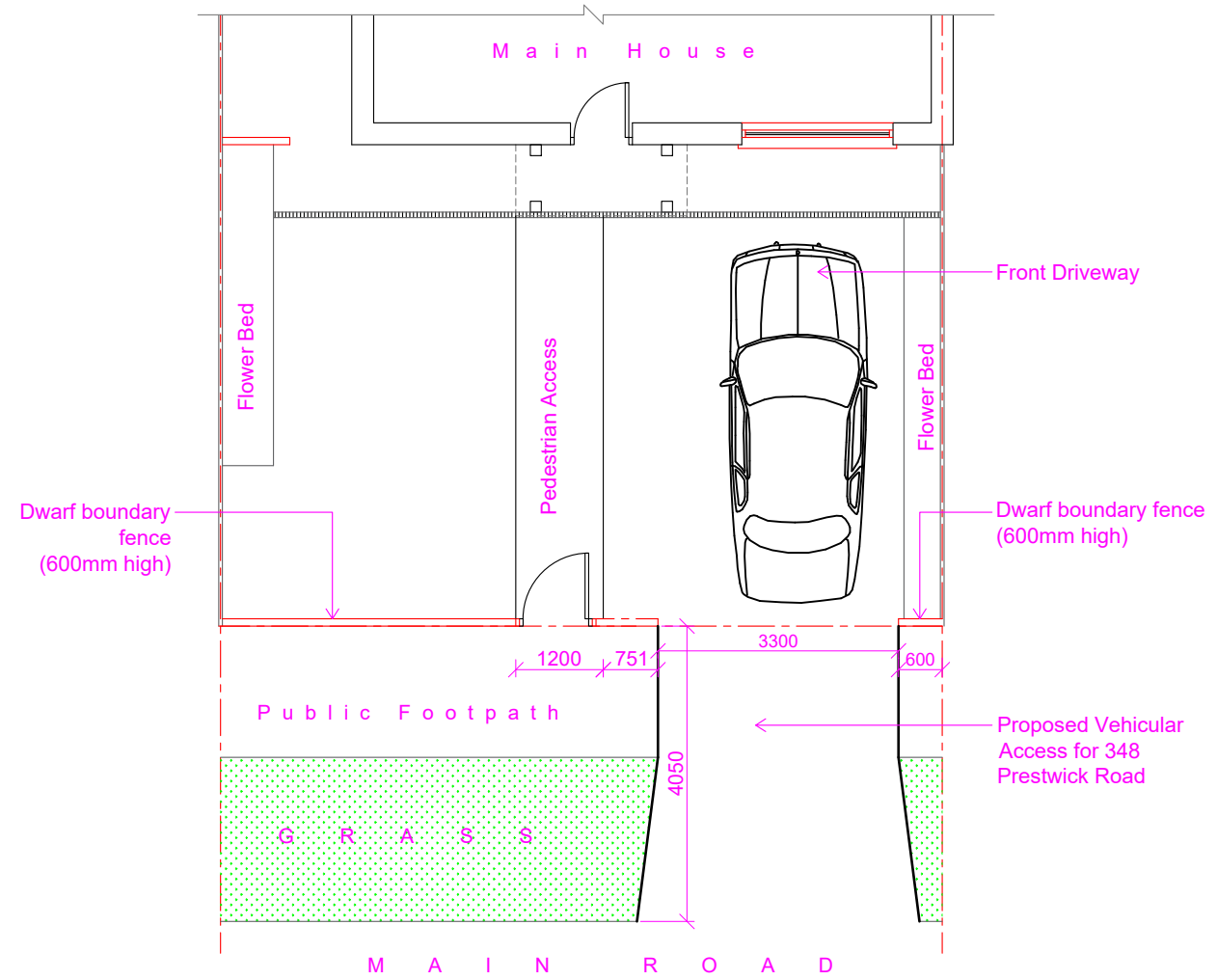

Proposed Front Driveway Layout

Proposed Development:
 Front Drive

Site Address:
 348 Prestwick Road
 Watford
 WD19 6UR

Revisions:

Rev	Date	Description
A	09/10/2023	

Drawing Description:
 Existing & Proposed Front Driveway Layouts

Drawing No:
 ART/2023/DK348PR/ELPL

Scale: 1:100
 Paper Size: A3
 Sheet No: 1 of 3



ART CONSULTANTS (UK) LTD
 113 LONG LANE
 STANWELL
 TW19 7AL
 M:07960071377
 E: ARTCONSULTANTSUK@GMAIL.COM