

17/01/2017/RAJ

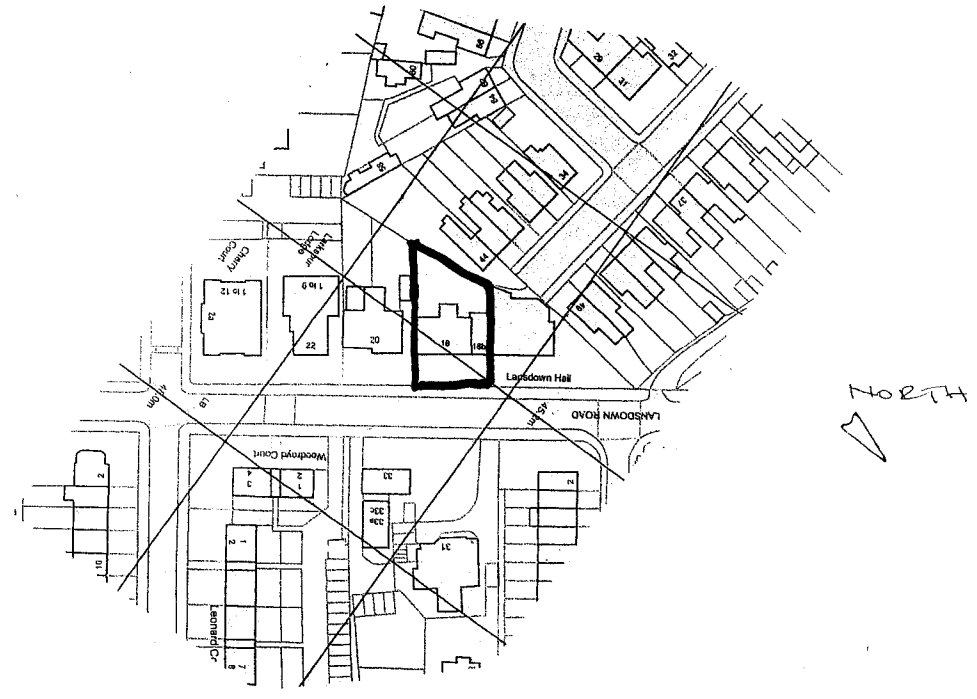

LOCATION PLAN  
1/1250

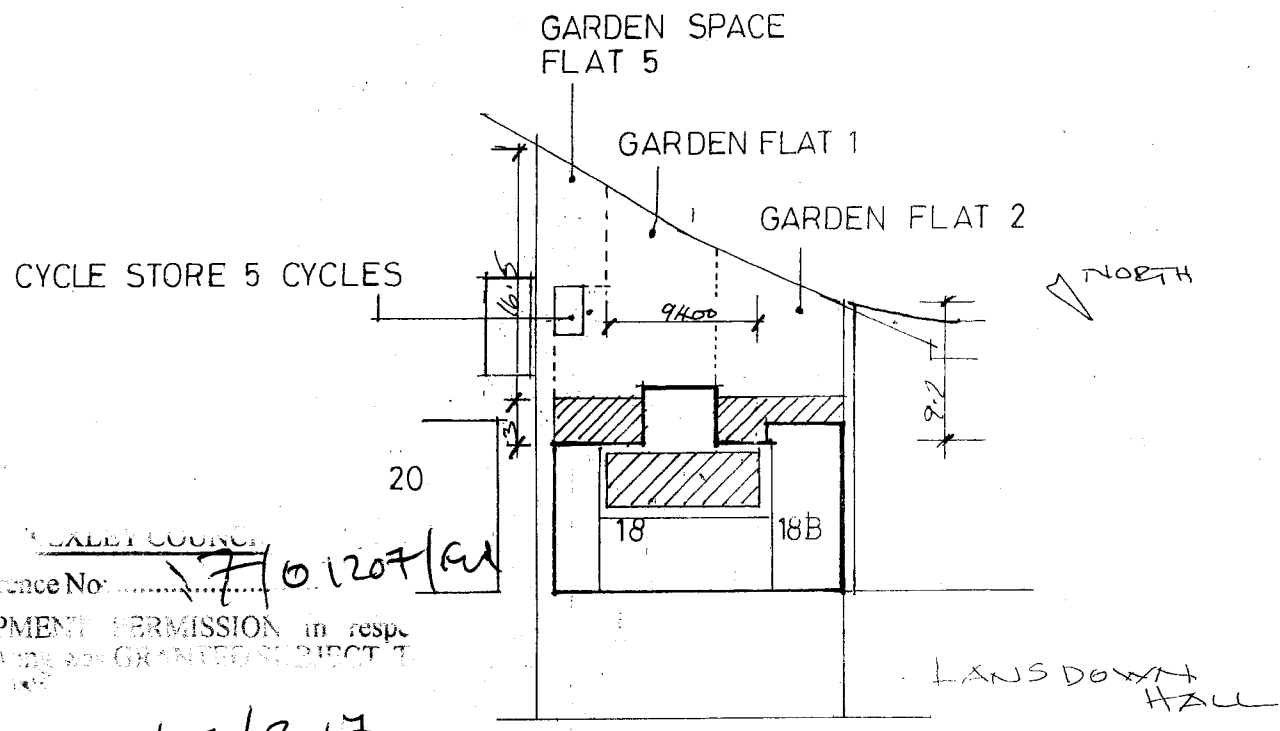

LANSDOWN ROAD  
BLOCK PLAN 1/500

Reference No: 17/01207/RAJ  
DEVELOPMENT PERMISSION in resp.  
of this drawing was GRANTED SUBJECT TO  
CONDITIONS

17/07/2017

FILE COPY

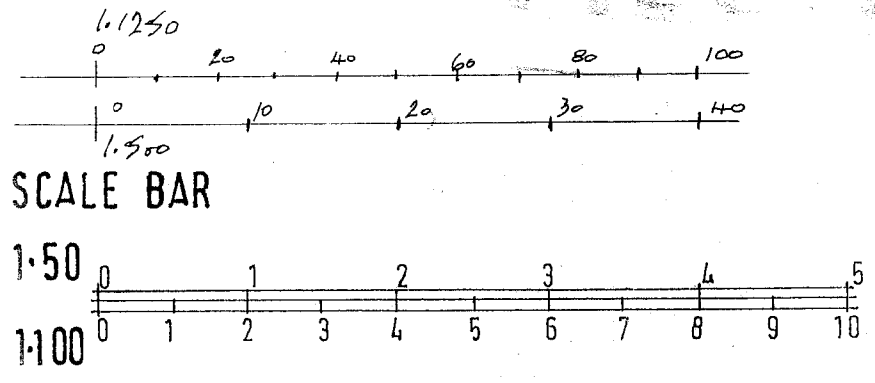

ALL DIMENSIONS TO BE CHECKED ON SITE PRIOR TO THE FABRICATION OF ANY WORKS OR ORDERING OF MATERIALS.  
BERNARD ILES RETAIN COPYRIGHT IN AN OWNERSHIP OF THESE DRAWINGS.

PROJECT 18 LANSDOWN RD SIDCUP DA14 4EG		TITLE LOCATION PLAN & PROPOSED BLOCK PLAN		
Bernard Iles MCIAT Chartered Architectural Technologist Mobile: 07778 212 280 E-mail: bernard.j.iles@gmail.com	DATE DEC 16	SCALE 1:1250 & 1:500	REVISIONS	
	DRAWN	JOB NO. L531	NO. LPBP1	REV   DATE