

**NOTES:-** RESPONSIBILITY IS NOT ACCEPTED FOR ERRORS MADE BY OTHERS IN SCALING FROM THIS DRAWING. ALL CONSTRUCTION INFORMATION SHOULD BE TAKEN FROM FIGURED DIMENSIONS ONLY. ALL DIMENSIONS ARE IN MILLIMETERS

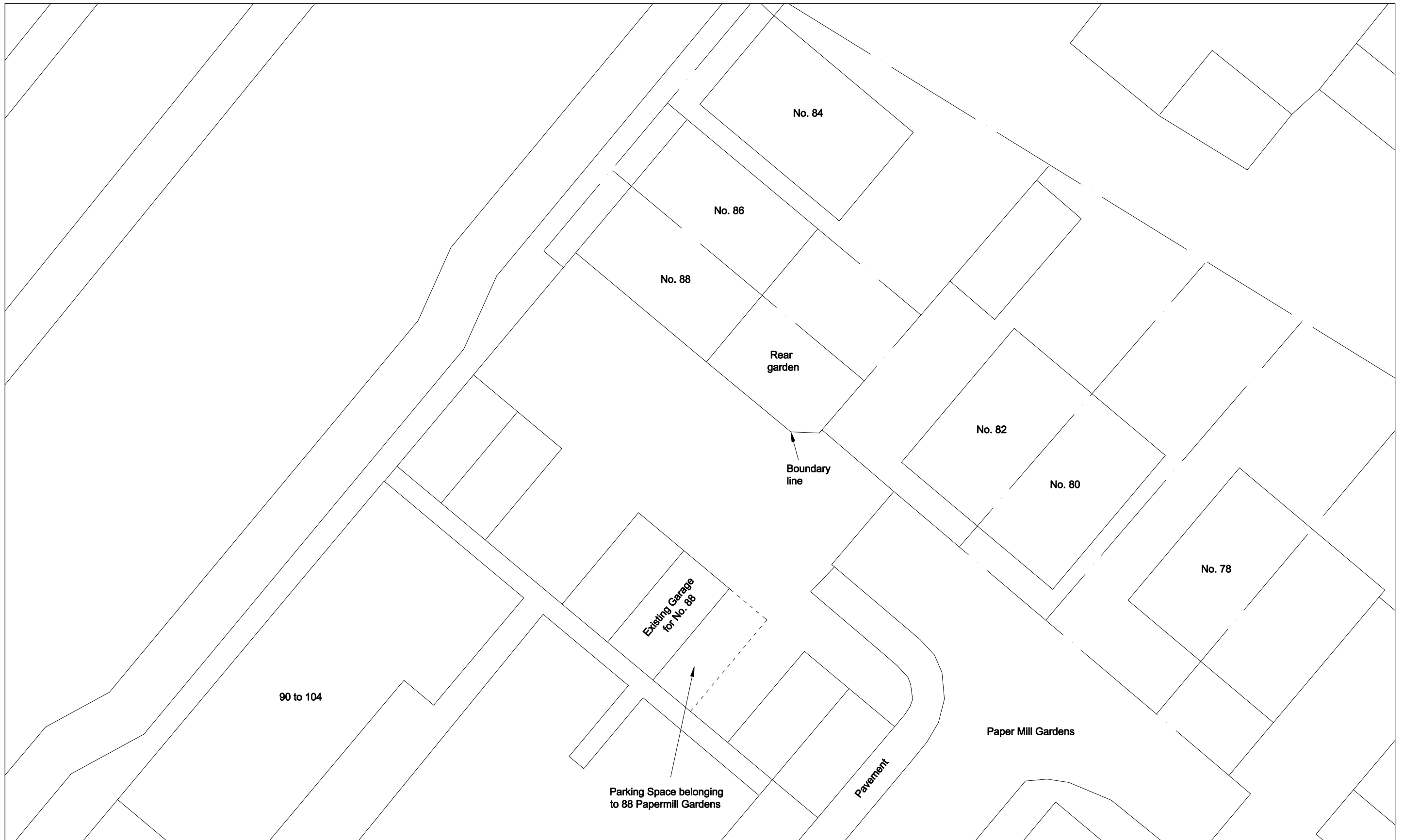

**Clifton Design (Bristol)**  
**17 Lower Redland Road**  
**Redland**  
**Bristol**  
**BS6 6TB**  
**0117 973 6000**

Rev:	Description of Changes:
-	-

Drawn:	Date:	North:
-	-	↑

**Client:**  
**Mr A Kite**  
**Address:**  
**88 Paper Mill Gardens, Portishead**

**Postcode:**  
**BS20 7QX**  
**Date:**  
**Nov 2023**

**Drawing Title:**  
**Block Plan - Existing**  
**Drawing No: 88/PMG/P/05/P**  
**Drawn: D.H** Option: - Rev: -

