

EXISTING SITE PLAN (scale 1:500 @ A1)

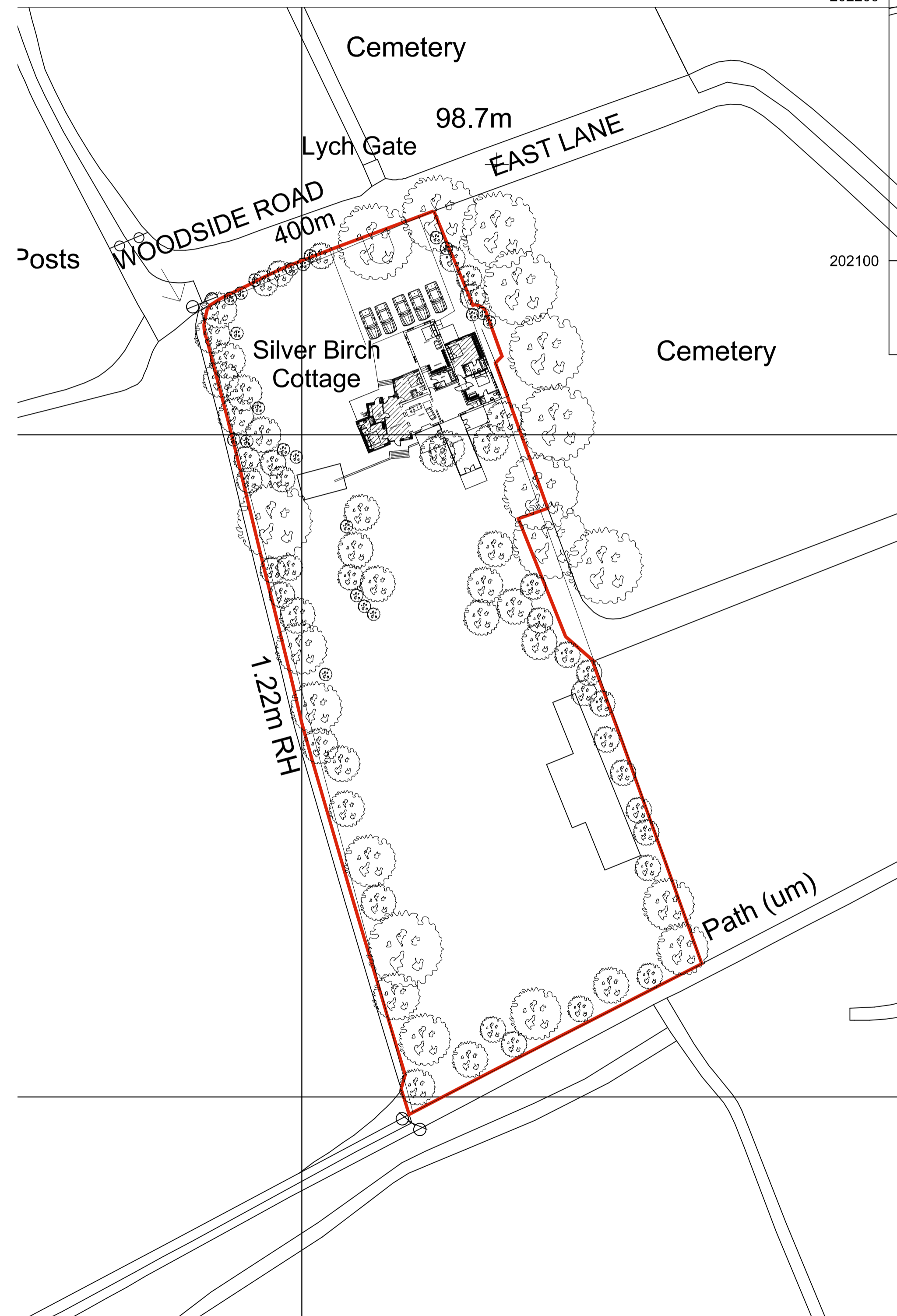

POTENTIAL SITE PLAN (scale 1:500 @ A1)

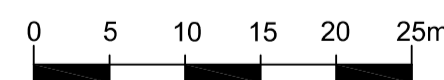

the NORTH

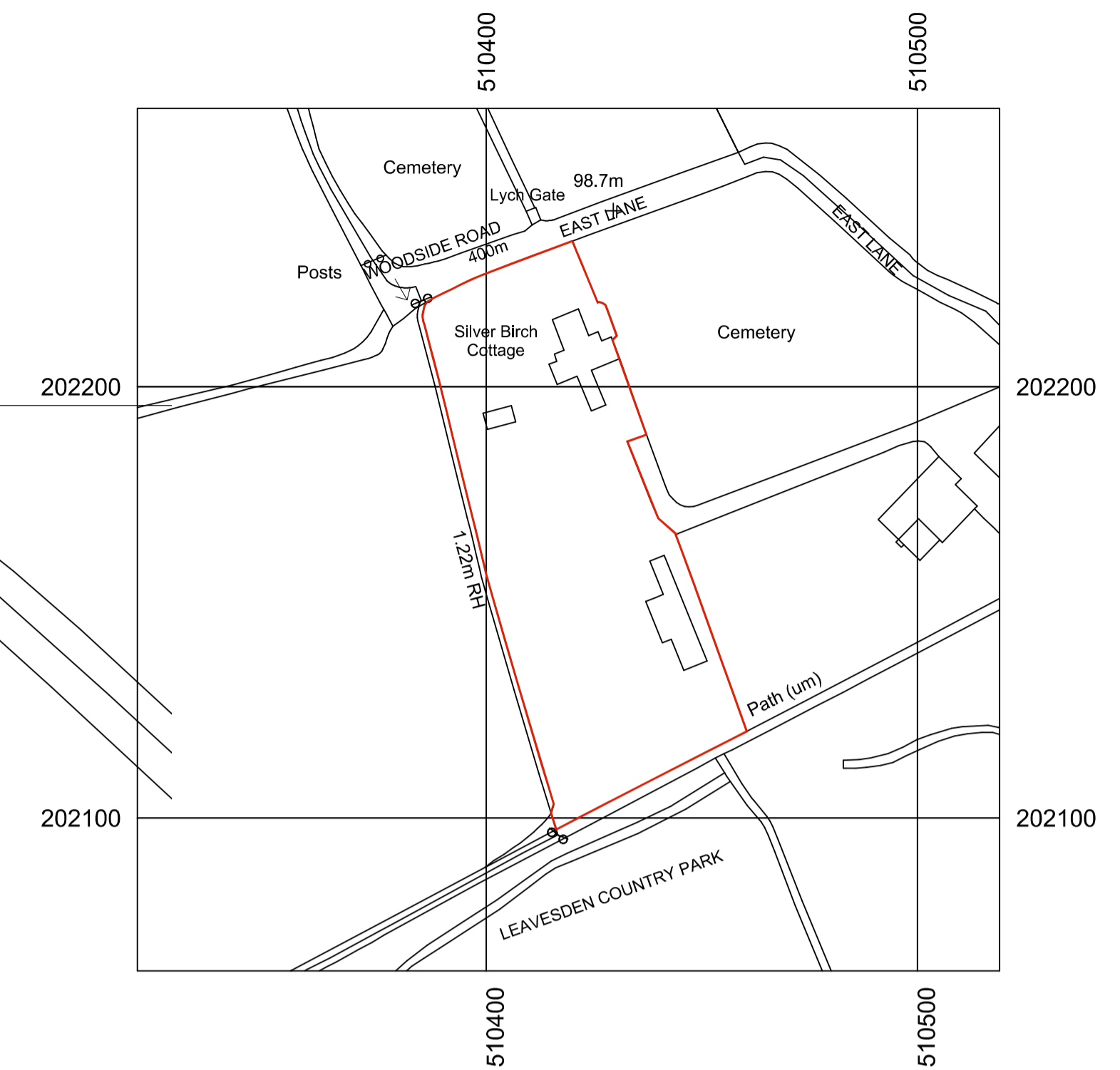

LOCATION PLAN (scale 1:1250 @ A1)

PLANNING

date	description	drawn	chckd	rev no
02-01-2024	Road ref added - hatched extended - cars noted	JWT	JWT	A

RLPSurveyors
 St Luke's House, 5 Walsworth Road, Hitchin, Herts, SG4 9SP
 Tel 01462 436318 email rlps@rpsurveyors.co.uk www.rpsurveyors.co.uk

RACS
 client
 Mr and Mrs Bishop

project
**SILVER BIRCH, EAST LANE
 RESIDENTIAL EXTENSION.**

title
**EXISTING / PROPOSED
 SITE PLANS.**

scale drawing no rev
 1/500 - 1250 @ A1 2337-SK-201 A

© 2008 this drawing is copyright