

PLEASE NOTE THAT THIS DRAWING IS NOT A CONSTRUCTION OR WORKING DRAWING AND HAS BEEN PRODUCED SOLELY FOR THE PURPOSES OF GAINING DEVELOPMENT CONTROL APPROVAL. CHRISTOPHER JAMES ARCHITECTURE TAKES NO RESPONSIBILITY FOR THEIR USE FOR ANY OTHER PURPOSE. ERRORS AND OMISSIONS TO BE REPORTED TO CHRISTOPHER JAMES ARCHITECTURE. THIS DRAWING IS COPYRIGHT

PLANNING ISSUE

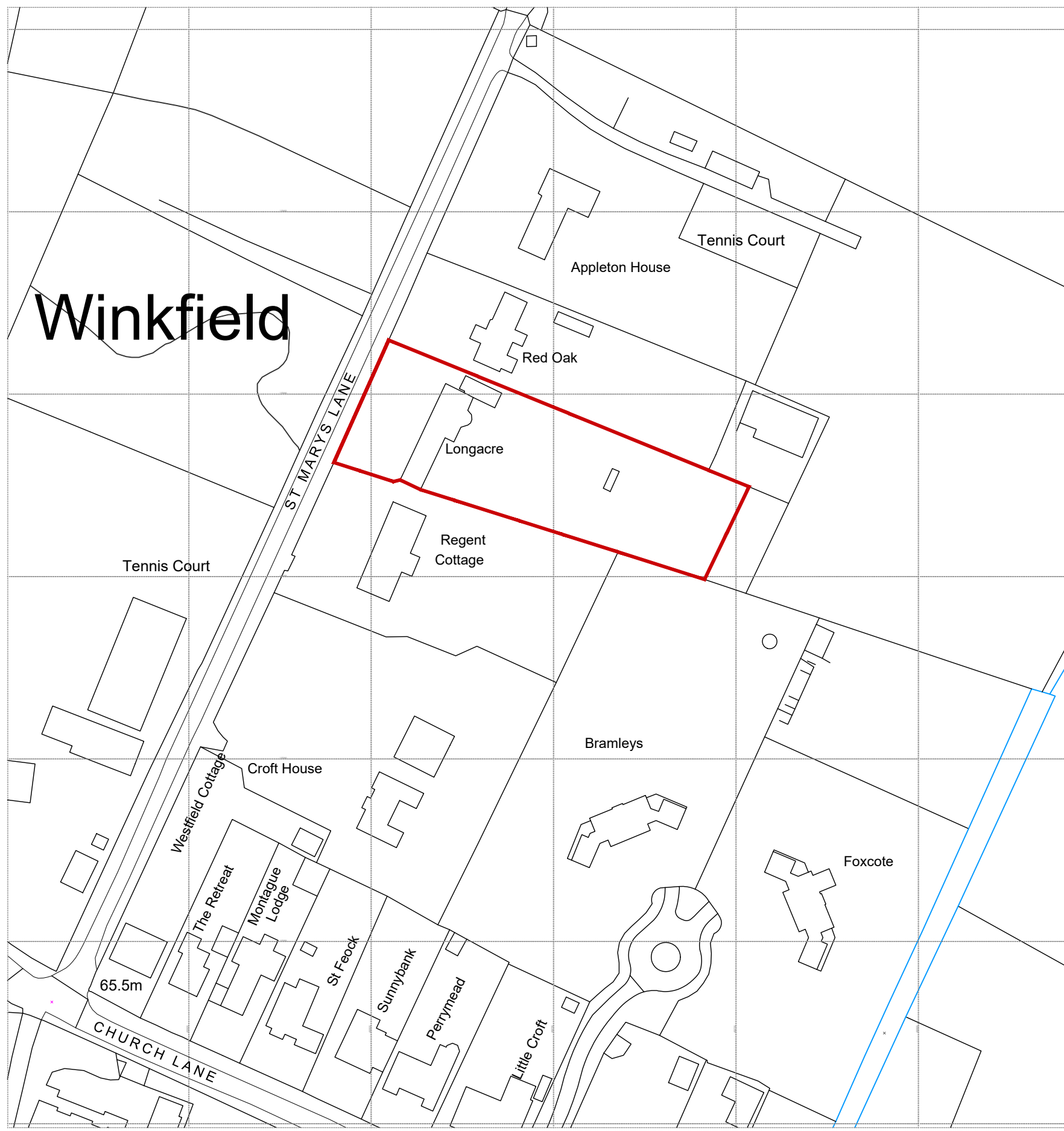

Site Location Plan - 1:1250 @ A1

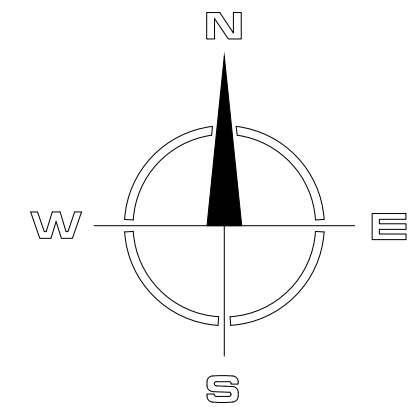

EXISTING PLANS SHOWN FOR INFORMATION ONLY

READ IN CONJUNCTION WITH CONSENTED APPLICATION 22/00634

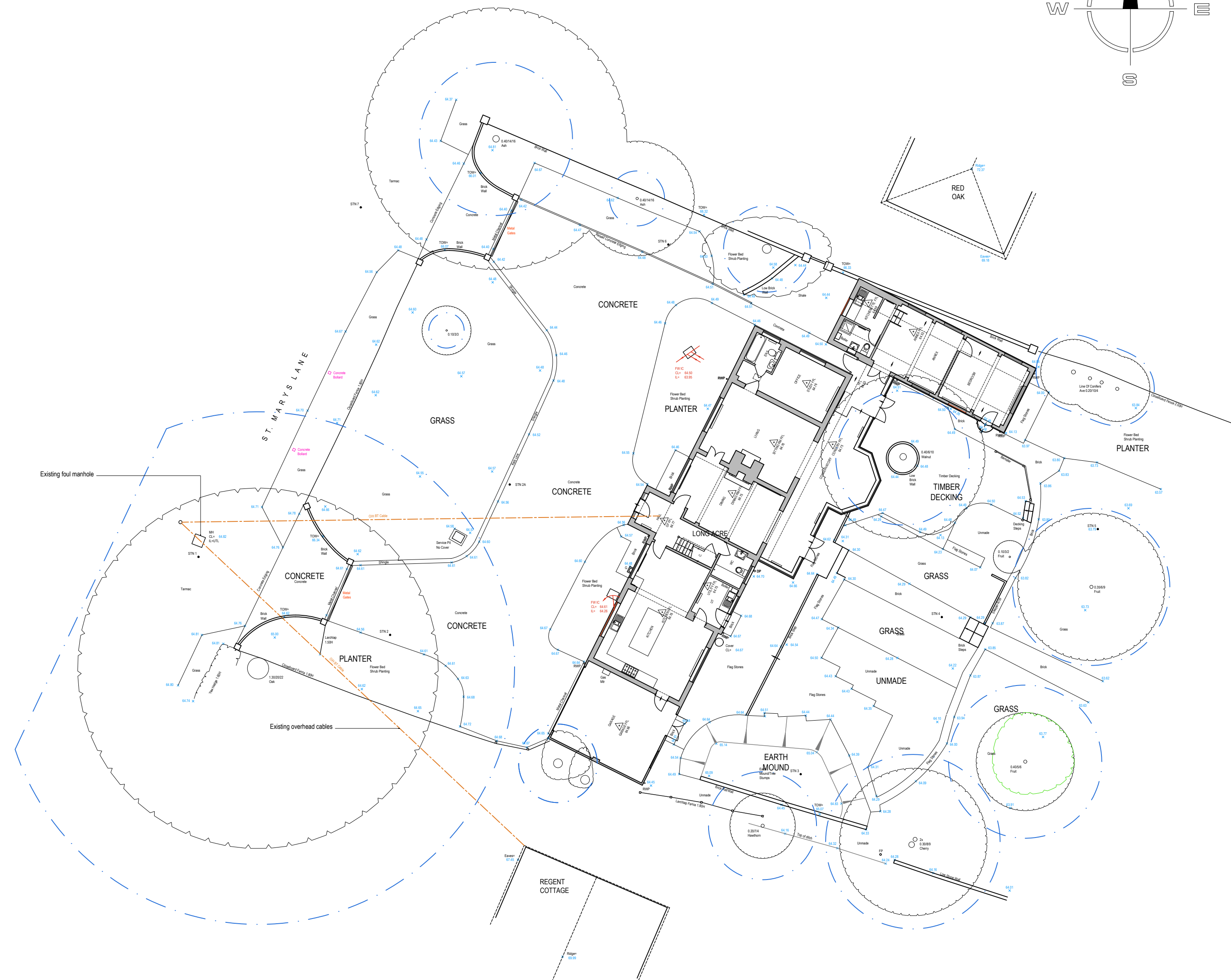
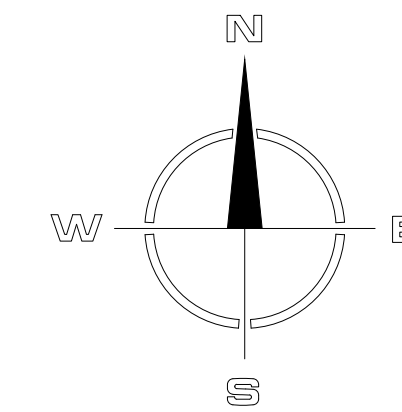

Existing Part Site Plan and Ground Floor Plan - 1:200 @ A1

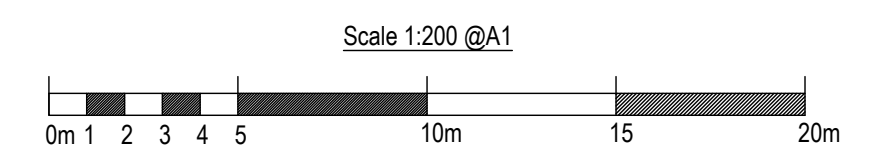

CHRISTOPHER JAMES ARCHITECTURE

27 Chaucer Way. Woosehill. Wokingham

Berkshire . RG41 3BG

T: 01189 797892 M: 07736039224

E: CHRIS@CHRISTOPHERJAMESARCHITECTURE.CO.UK

Longacre St Marys Lane Winkfield Windsor Berkshire - Proposed PV Array and Installation of Air Source Heat Pump

Site Location Plan & Existing Site Plan

Scale as shown @ A1

Dec'23

202-1100

