

L1B CONVERSION SAP ASSESSMENT

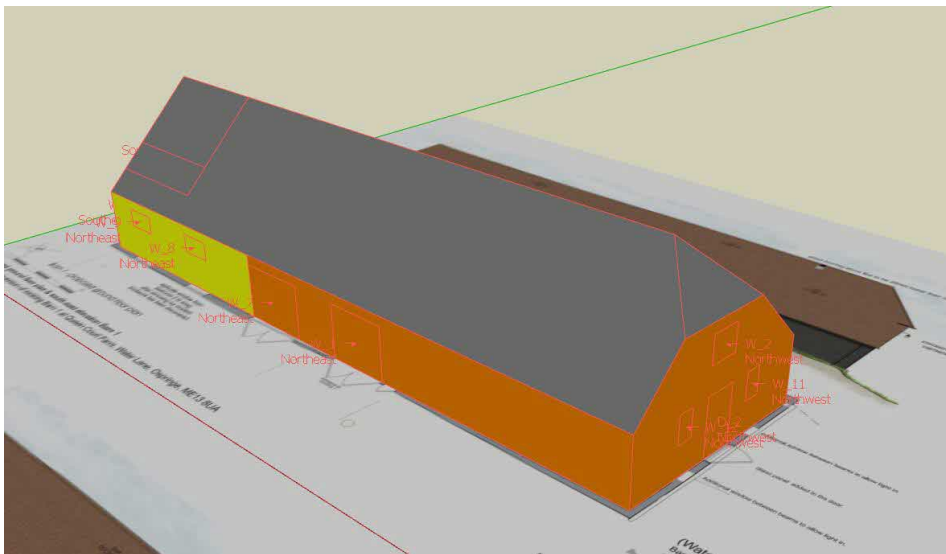

PROJECT NUMBER:	PRO-065476_OPP-076734
DATE:	22/09/23
CONTACT NAME:	PAUL CROOK
COMPANY NAME:	
COMPANY ADDRESS:	
EMAIL ADDRESS:	retrovintagewholesale@gmail.com
ASSESSOR NAME:	LIAM MASON
SITE NAME:	WATER LANE BARN
SITE ADDRESS:	FAVERSHAM, ME13 8ZD
NUMBER OF UNITS:	01

PLOT	EPC RATING	ENV IMP RATING	DER: DWELLING EMISSION RATE	TER: TARGET EMISSION RATE	DFEE: DWELLING FABRIC EFFICIENCY	TFEE: TARGET FABRIC EFFICIENCY
01	D66	D57	N / A	N / A	N / A	N / A



STROMA BUILT ENVIRONMENT LTD
 REGISTERED OFFICE: 4 PIONEER WAY,
 CASTLEFORD, WF10 5QU
www.stroma.com/built-environment

2 KINGS HILL AVENUE, KINGS HILL,
 WEST MALLING, KENT, ME19 4AQ

REGISTERED IN ENGLAND: 04507219
 VAT No: 154 765 781

CONSTRUCTION NOTES		
ELEMENT	CONSTRUCTION	U-VALUE
FLOORS	MAIN GROUND FLOOR: 300MM GEOCELL FOAM GLASS (λ 0.080), 100MM SCREED SECONDARY GROUND FLOOR: 100MM TIMBER FRAME INFILLED WITH GEOCELL FOAM GLASS BUBBLES (λ 0.070), 22MM CHIPBOARD, 20MM UNDERFLOOR HEATING INSULATION (λ 0.034), 25MM TIMBER FLOOR	TARGET: \leq 0.25 0.16 TARGET: \leq 0.25 0.25
EXTERNAL WALLS	EXISTING TIMBER EXTERNAL WALLS: CLADDING ON BATTENS, ACTIS BOOST R HYBRID (R1.35) BATTENED, ACTIS H CONTROL HYBRID (R1.90) BATTENED, 18MM PLYWOOD, 12.5MM PLASTERBOARD, SKIM EXISTING SOLID WALLS: NO THERMAL UPGRADE, APPENDIX S SAP TABLES USED	TARGET: \leq 0.30 0.26 TARGET: \leq 0.30 2.10
ROOFS	PITCHED ROOF INSULATED SLOPE SLOPING CEILING: AS U-VALUE CALCULATION 'UVT-(r-tp) R-Pitched' 14.01.22	TARGET: \leq 0.18 0.28
OPENINGS	WINDOWS: MANUFACTURERS DECLARATION: DOUBLE GALZED, ARGON FILLED, (LOW-E, EN = 0.05, SOFT COAT) 0.70 FRAME FACTOR, 16MM OR MORE GAP, G VALUE = 0.63 DOORS MANUFACTURERS DECLARATION (SOLID)	1.60 1.80
VENTILATION	SYSTEM 1 VENTILATION SYSTEM: OPENABLE WINDOWS AND TRICKLE VENTS, DMEV IN WETROOMS AND KITCHEN AREA	
TARGET AIR PERMEABILITY	15.00m ³ /hm ² (50pPa) NOT TESTED, SAP DEFAULT USED	
HEATING		
MAIN HEATING DETAILS	HEAT TYPE: WORCESTER GREENSTAR 8000 LIFE GR8300IW S NG HEAT SOURCE: UNDERFLOOR HEATING HEAT CONTROLS: TIME AND TEMPERATURE ZONE CONTROL	
SECONDARY HEATING	NONE	
HOT WATER	300L MEGAFLO HOT WATER CYLINDER HEAT LOSS: 1.69KWH/DAY, CYLINDER IN HEATED SPACE, CYLINDERSTAT, FULLY INSULATED PRIMARY PIPEWORK, WATER HEATING TIMED SEPERATELY.	
RENEWABLES	NONE	
THERMAL BRIDGING	NOT CALCULATED, SAP DEFAULT FIGURE USED (Y=0.15)	
ADDITIONAL INFORMATION		
OVERHEATING: WINDOWS NEED TO BE OPEN HALF THE TIME IN SUMMER TO COMPENSATE FOR OVERHEATING LOW ENERGY LIGHTING: 100% OF FITTINGS (REGULATED) WATER EFFICIENCY: DWELLING DESIGNED TO ACHIEVE A WATER USE TARGET OF NOT MORE THAN 125 LITRES PER PERSON PER DAY INDICATIVE LOW THERMAL MASS		
EXISTING SOLID WALLS AND PITCHED ROOF THERMAL ELEMENTS DO NOT MEET THE MINIMUM REQUIREMENTS OF APPROVED DOCUMENT PART L1B (2013).		

AS BUILT STAGE SAP AND EPC CONFIRMATION OPP-076734

DISCLAIMER

THE RESULTS IN THE ATTACHED SCHEDULE HAVE BEEN PREPARED BASED ON WORKING DRAWINGS, SPECIFICATION AND OTHER CORRESPONDANCE PROVIDED. ANY DEVIATION FROM ANY OF THIS DOCUMENTATION OR THE ABOVE SPECIFICATIONS, WILL INVALIDATE THE SAP, DER, TER, AND EPC RESULTS.

I HAVE READ THE ABOVE CONSTRUCTION NOTES AND CAN CONFIRM THEY ARE CORRECT. PLEASE PROCEED AND PRODUCE AS BUILT STAGE CERTIFICATES AND EPC(S) FOR THIS / THESE UNIT(S).

SIGNED:.....DATED:.....

PRINT NAME:.....CONTACT NUMBER:.....



STROMA BUILT ENVIRONMENT LTD
REGISTERED OFFICE: 4 PIONEER WAY,
CASTLEFORD, WF10 5QU
www.stroma.com/built-environment

REGISTERED IN ENGLAND: 04507219
VAT No: 154 765 781