

Chimney pots:  
Terracotta chimney pots to  
match photo dating circa  
1917

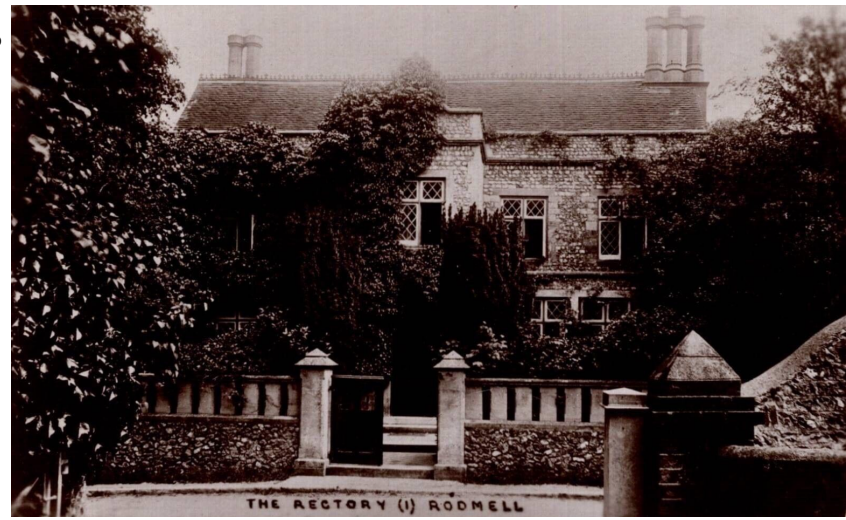

NOTES

Any errors or omissions to be reported to NAGANJOHNSON ARCHITECTS immediately.

This drawing and design is the copyright of NAGANJOHNSON ARCHITECTS and is not to be used for any purpose without their consent.

All dimensions are to be verified on site before commencing work.

This drawing shall be read in conjunction with all relevant documents.

To be read in conjunction with SE information.

REVISIONS

Rev A - Roof lights revised	05.09.2023
Rev B - chimney works and re-tiling	13.09.2023
Rev C - Chimney pots	04.10.2023

DRAWING No. REV.

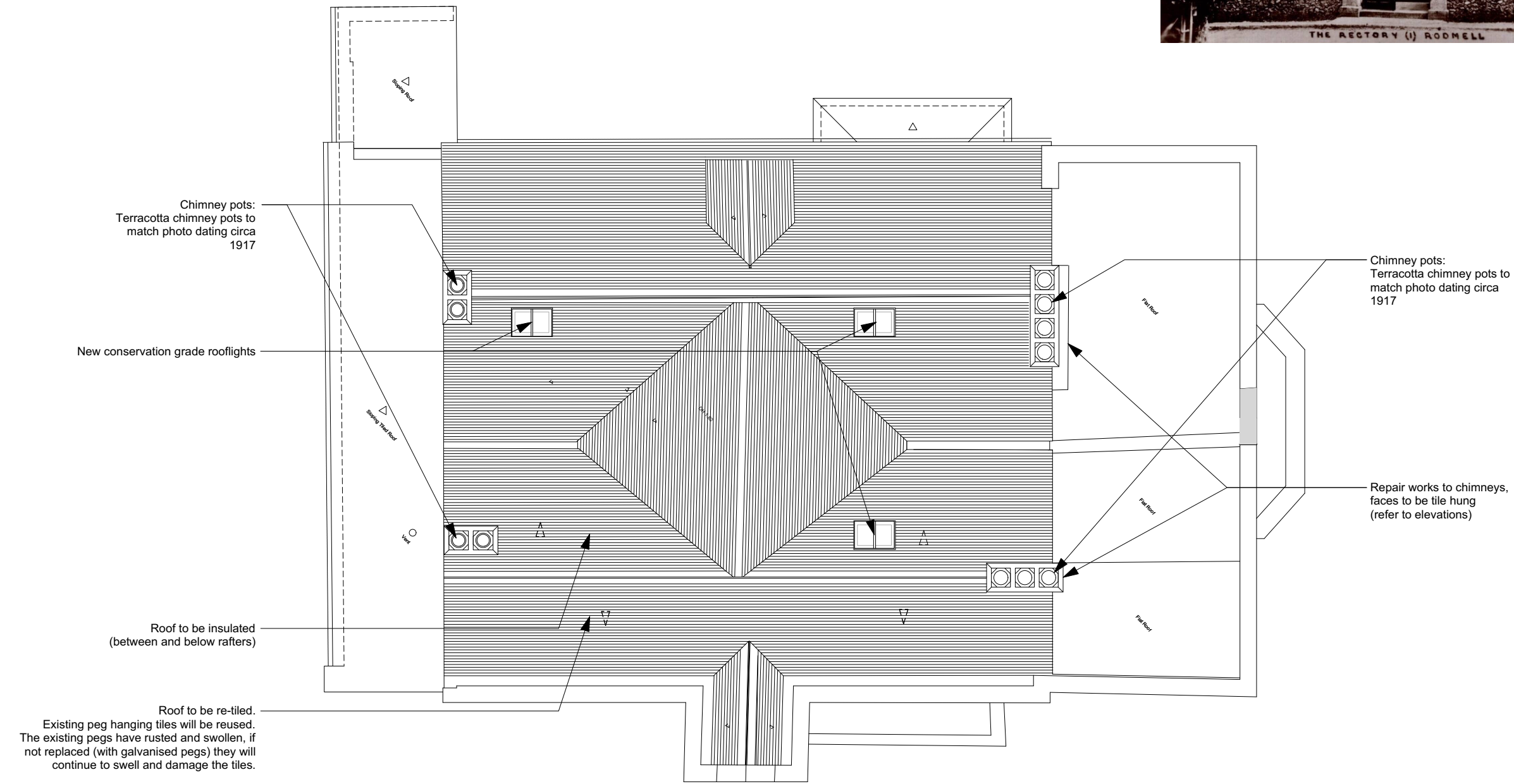

Chimney pots:  
Terracotta chimney pots to  
match photo dating circa  
1917

New conservation grade rooflights

Roof to be insulated  
(between and below rafters)

Roof to be re-tiled.  
Existing peg hanging tiles will be reused.  
The existing pegs have rusted and swollen, if  
not replaced (with galvanised pegs) they will  
continue to swell and damage the tiles.

Broken tiles will be replaced with Sussex  
hand-made 6 1/2 x 10 1/2inch peg hanging tiles  
to match existing.

Chimney pots:  
Terracotta chimney pots to  
match photo dating circa  
1917

Repair works to chimneys,  
faces to be tile hung  
(refer to elevations)

SCALE AT A3 (1:100)

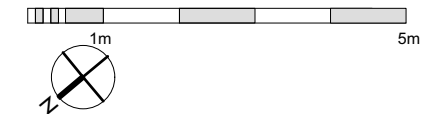

As Proposed, Roof  
PLAN

**NAGAN JOHNSON ARCHITECTS**  
2 Pontypool Place London SE1 8QF | studio@naganjohnson.co.uk | 0207 633 0200

PROJECT CODE	PROJECT ADDRESS	CLIENT	DATE
<b>RODM</b>	The Old Rectory Rodmell		Nov. 2023
DRAWING No.	DRAWING TITLE	PROJECT CONTACT	SCALE AT A1
<b>119</b>	As Proposed Roof Plan	Michael Johnson	SCALE AT A3 1:100
REV.			
<b>C</b>			