

Existing Site Plan

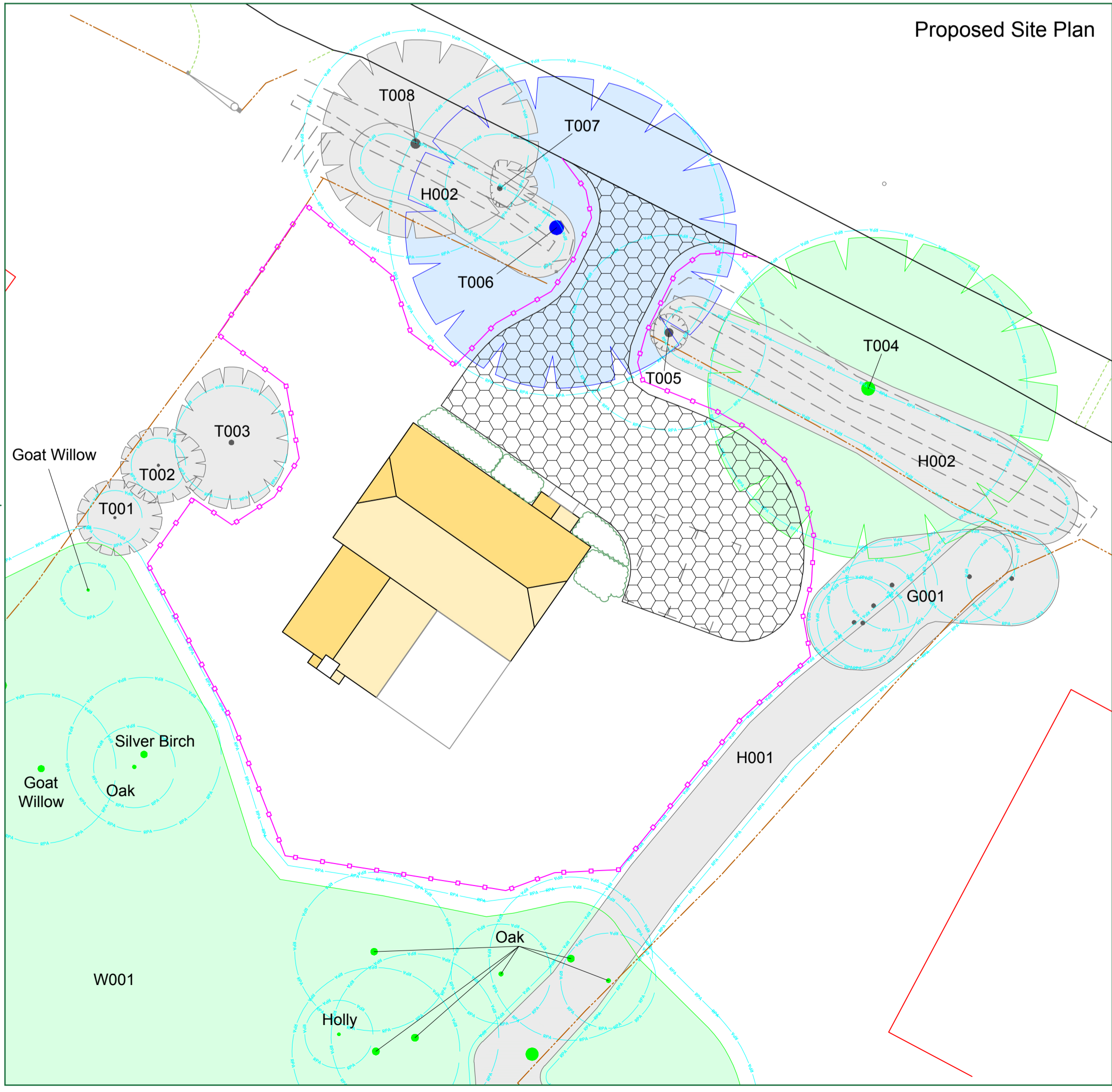

Proposed Site Plan

NOTE:
 Hayden's Arboricultural Consultants were provided with a Topographical Survey but these do not always show the positions of all the trees/features on site. The locations of any additional features have been fixed using GPS. As such the position of the trees/landscape features should not be taken as exact but gives a fair distribution of their locations on site.

CATEGORY AND DEFINITION

Trees unsuitable for retention	
Category U	Those in such condition that they cannot realistically be retained as living trees in the current land use for longer than 10 years
Trees to be considered for retention	
Category A	Trees of high quality with an estimated remaining life expectancy of at least 40 years
Category B	Trees of moderate quality with an estimated remaining life expectancy of at least 20 years
Category C	Trees of low quality with an estimated remaining life expectancy of at least 10 years, or young trees with a stem diameter below 150mm

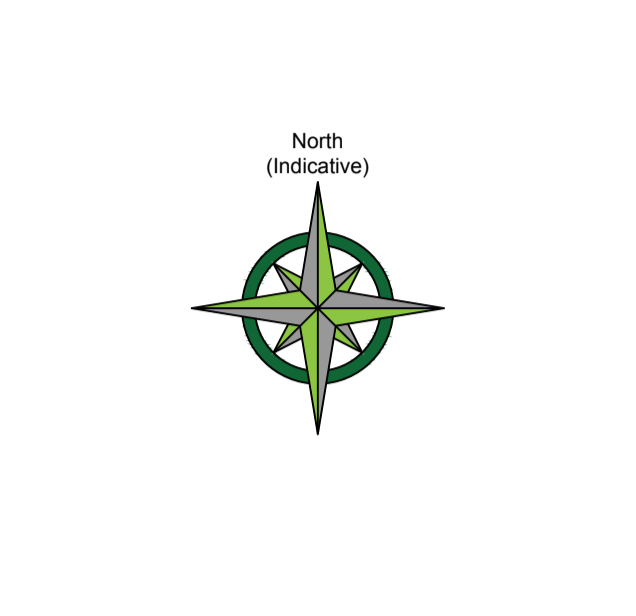

LEGEND

	Existing Tree/Feature BS 5837:2012 Category A
	Existing Tree/Feature BS 5837:2012 Category B
	Existing Tree/Feature to be crown lifted to allow for development
	Existing Tree/Feature BS 5837:2012 Category C
	Existing Tree/Feature to be copped
	Line of Root Protection Area (RPA) - calculated following guidelines set in BS 5837:2012
	Dead or Dying Tree
	Line of proposed temporary protective barrier
	Proposed development within & close to the RPA to be constructed following the No Dig Specification

Rev:	A	Date:	24/10/2023	By:	KFJ	Updated to be based on bbr Design Proposed Site Plan Drawing: 22208_PL03
Rev:	-	Date:	12/09/2023	By:	KFJ	Based on Sunshine Survey Ltd. topo drg no. GY15446 - 1/001 and bbr Design Proposed Site Plan Drawing: PL03

The position, condition, and dimensions of the trees are based on a site survey undertaken on 22/03/2023
 "The original of this drawing was produced in colour - a monochrome copy should not be relied upon"

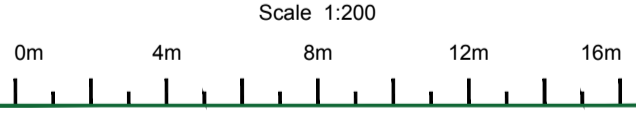

HAYDEN'S
 Arboricultural Consultants

© HAYDEN'S 2022

5 Moseleys Farm Business Centre
 Fornham All Saints,
 Bury St Edmunds
 Suffolk IP28 6JY

Head Office: 01284 765391
 Southern Office: 01722 657423
 Email: info@treesurveys.co.uk

www.treesurveys.co.uk

Client:	GSC Solicitors LLP	Drawing Title:	TS & AIA
Site:	Old Wood, Skellingthorpe, Lincashire, LN6 5UA		
Date:	12/09/2023	Drawn By:	KFJ
Scale:	1:200 (A2)	Checked By:	SHO/LA
		Drawing No:	9677-D-AIA
		Rev:	A