

Site Plan as Existing

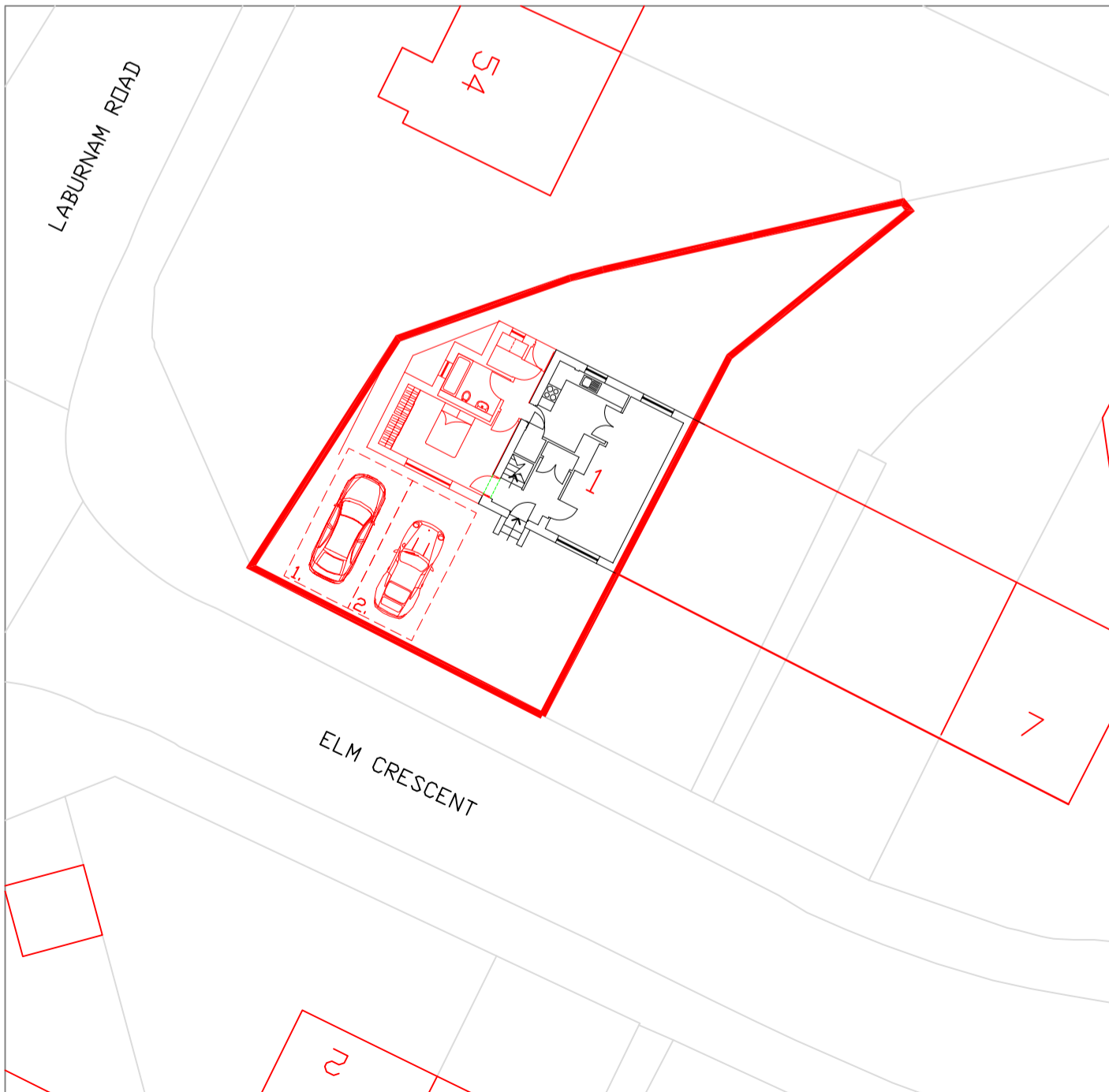

Site Plan as Proposed

Important
 The contractor will be held to have examined the site and checked all dimensions and levels before commencing construction work. No assumption should be made without reference to the architect. No dimensions should be scaled from this drawing.

Revision _____ Date _____

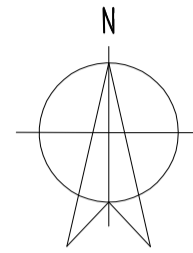

--- FOUL DRAINAGE LINE
 --- SURFACE WATER DRAINAGE LINE

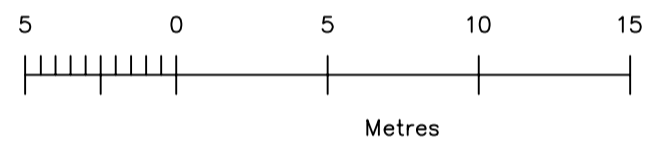

Calum Smith Architect

Woodlands
 134 New Trows Road
 Lesmahagow
 Lanarkshire
 ML11 0ER

T 01555 893122
 M 0773 0067409
 F 01555 893122
 E info@calumsmitharchitect.co.uk



PRELIMINARY

Client
LISA LENNOX & PAUL DONAGHY

Project Title
**PROPOSED EXTENSION/ALTERATIONS
 AT 21 CROFTHED STREET,
 STRATHAVEN, ML10 6BB**

Drawing Title
**SITE PLAN AS EXISTING &
 PROPOSED**

Scale
1:250 @ A3

Date
DECEMBER 2023

Job No.
396

Drawing No.
02

Rev.