

100
0 10
Millimetres

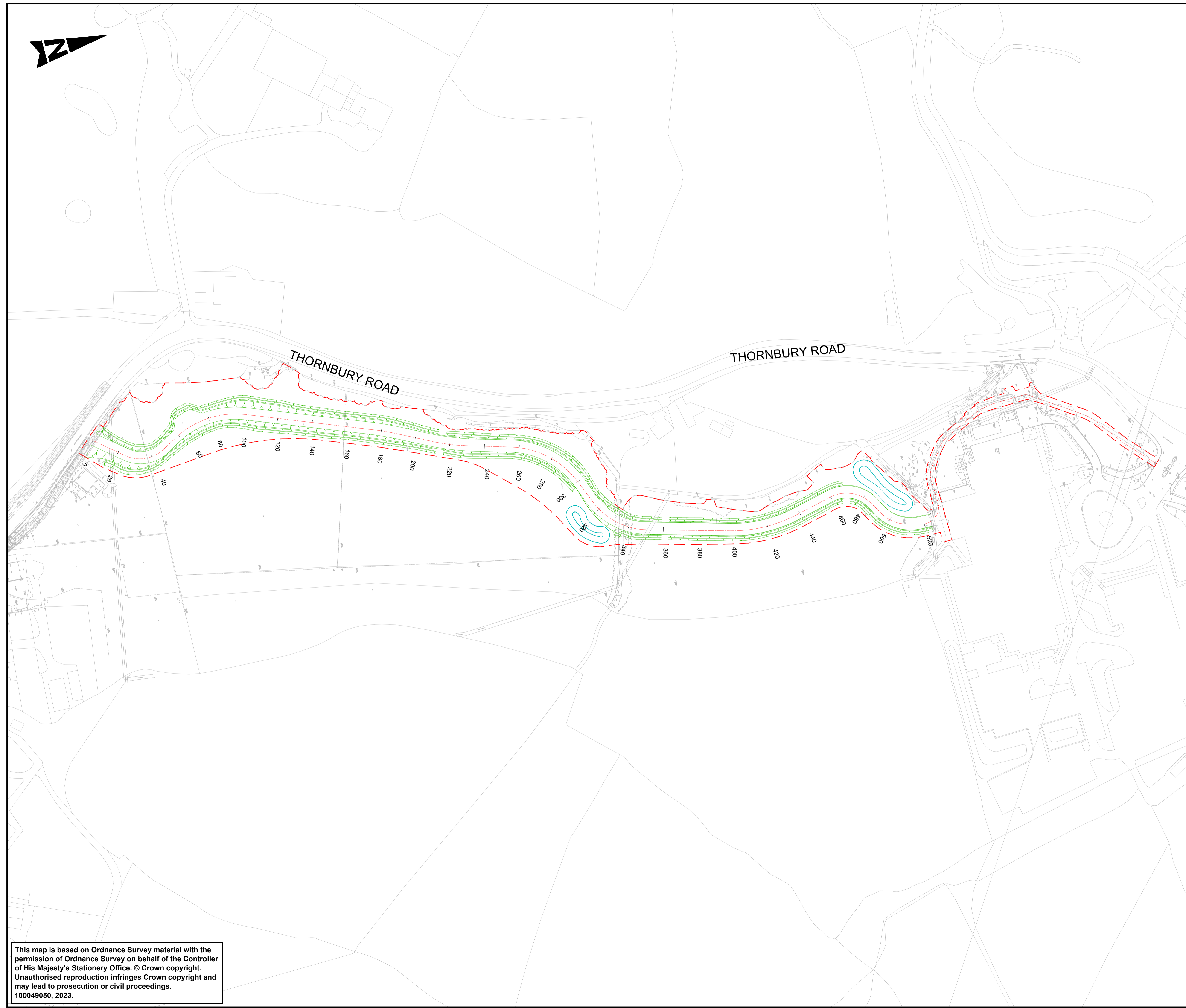

- NOTES:**
1. ALL DIMENSIONS ARE IN METRES UNLESS OTHERWISE STATED.
 2. THE DRAWING SHALL BE READ IN CONJUNCTION WITH
GENERAL ARRANGEMENT DRAWING
WECA_SGC-ATK-HGN-5220316-DR-CH-000007
AND CROSS SECTION DRAWINGS
WECA_SGC-ATK-HGN-5220316-DR-CH-000010 & 11.
 3. THE DRAWING SHALL BE READ IN CONJUNCTION WITH
APPENDIX 6/1,6/2 AND 6/3 SERIES FOR EARTHWORKS.

- KEY:**
- APPLICATION BOUNDARY
 - PROPOSED EARTH WOKS
 - CHAINAGE REFERENCE LINE
 - PROPOSED POND

SAFETY, HEALTH AND ENVIRONMENTAL INFORMATION

In addition to the hazards/risks normally associated with the types of work detailed on this drawing, note the following significant residual risks (Reference shall also be made to the design hazard log).

Construction	None
Live Traffic & Utilities	None
Maintenance / Cleaning	None
Use	None
Decommissioning / Demolition	None

Description	Status	Revision	Drawn	Checked	Reviewed	Authorised	Issue Date
DESCRIPTION							
DESCRIPTION							
DESCRIPTION							

Description	FIRST ISSUE												
Status	A1	Revision	GB1	Drawn	HA	Checked	MM	Reviewed	MM	Authorised	MM	Issue Date	29/09/23

Description	For Planning												
Status	A1	Revision	CO2	Drawn	HA	Checked	JR	Reviewed	MM	Authorised	MM	Issue Date	04/10/23

Drawing Suitability: **APPROVED - PUBLISHED** Status: **A1**

ATKINS
Member of the SNC-Lavalin Group

Aztec West
500 Park Avenue
Almondsbury
Bristol
BS32 4RZ
Tel: +44 (0)1454 662000
+44 (0)1454 663333
www.atkinsglobal.com

Client: **South Gloucestershire Council**
Delivering for you

Project Title: **WECA SGC- Alveston Hill FBC**

Drawing Title: **EARTHWORKS LAYOUT (FOR PLANNING APPROVAL)**

Drawing Number	Project			Originator	Volume
	WECA SGC - ATK - HGT -				
	5220316 - DR - CH - 000001				
Location	Type	Role	Number		
Original Size: A1	Scale: 1:1000	Project Ref. No: 5220316	Sheet: 1 of 1	Rev: C02	

This map is based on Ordnance Survey material with the permission of Ordnance Survey on behalf of the Controller of His Majesty's Stationery Office. © Crown copyright. Unauthorised reproduction infringes Crown copyright and may lead to prosecution or civil proceedings. 100049050, 2023.