

North West

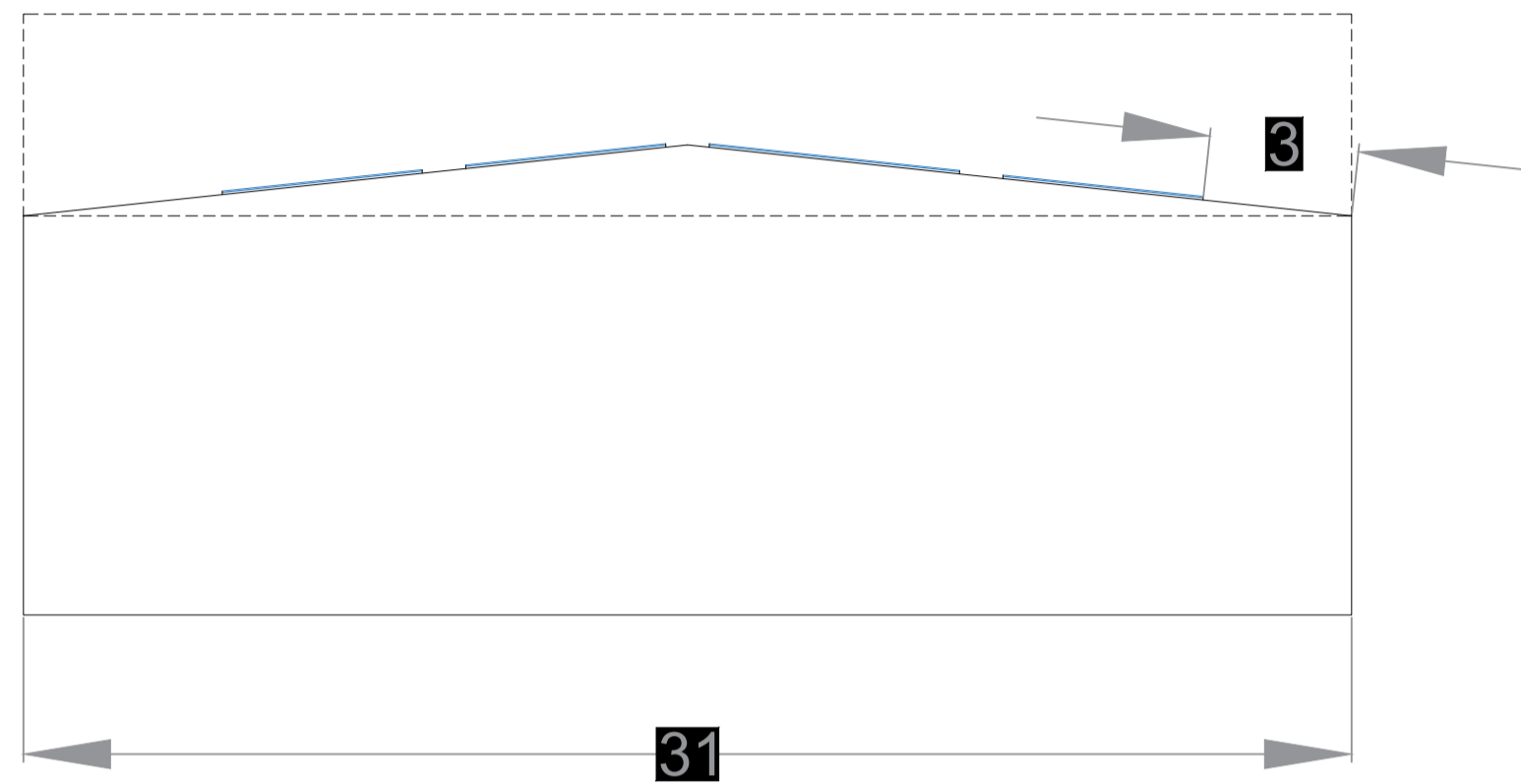

South West

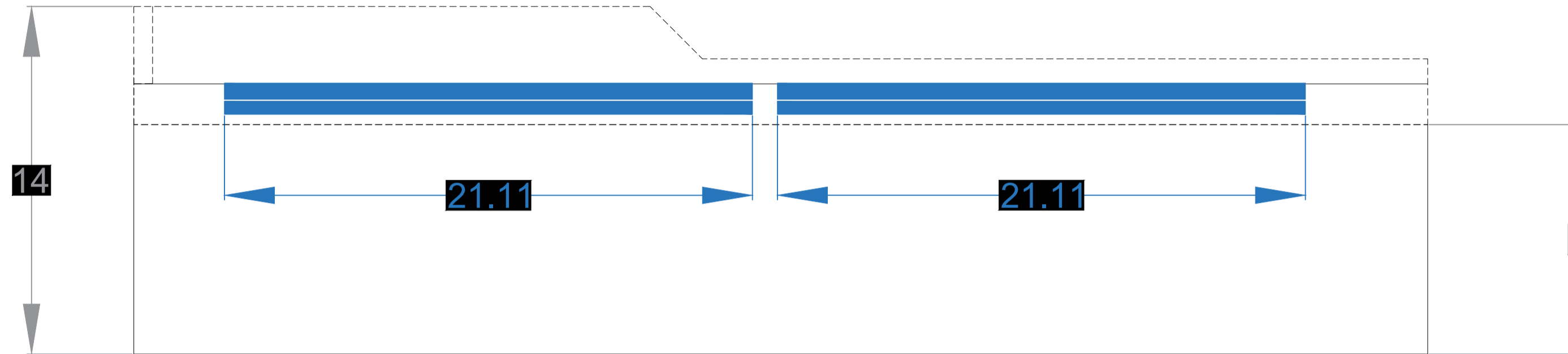

North East

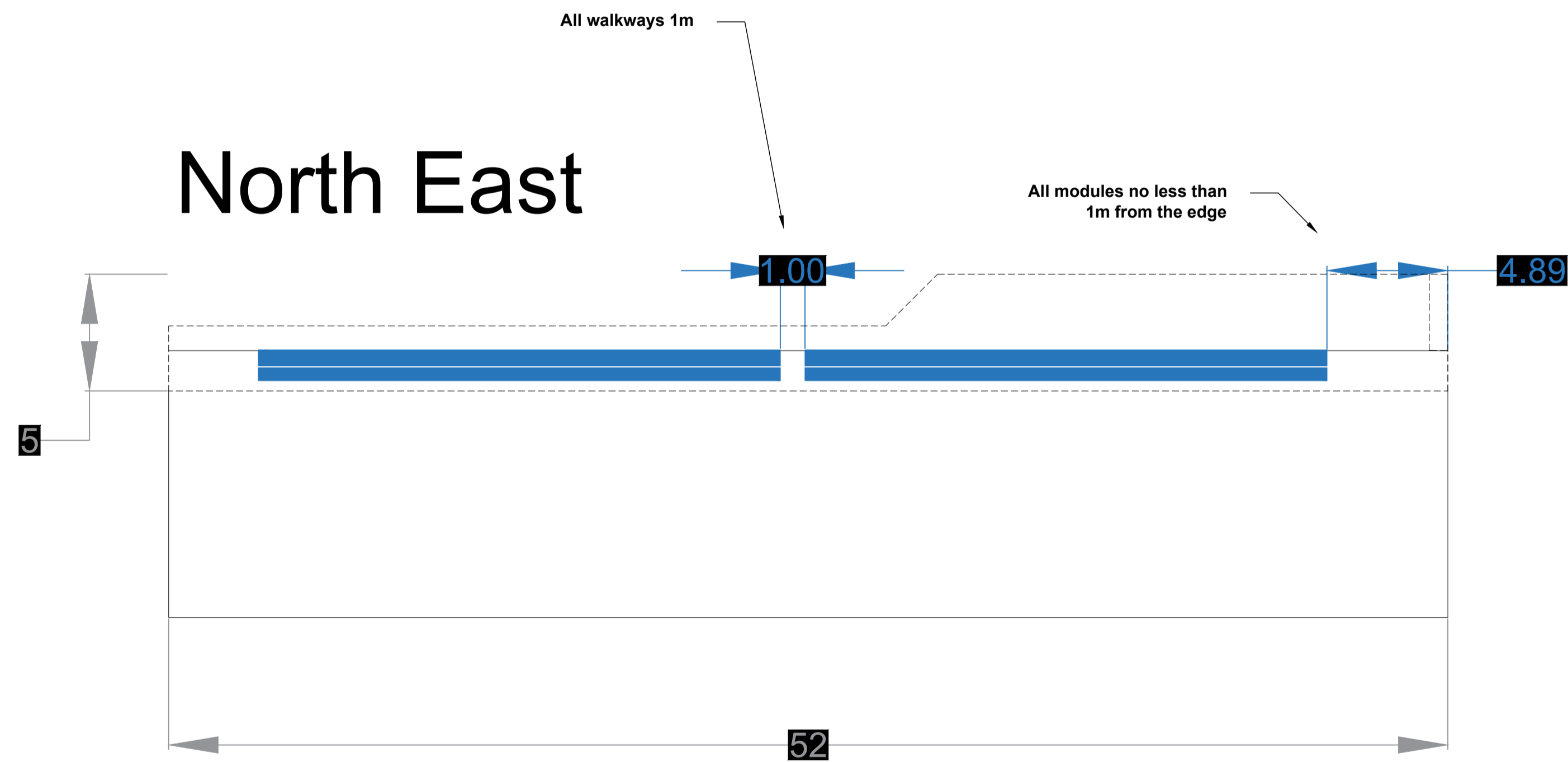

South East

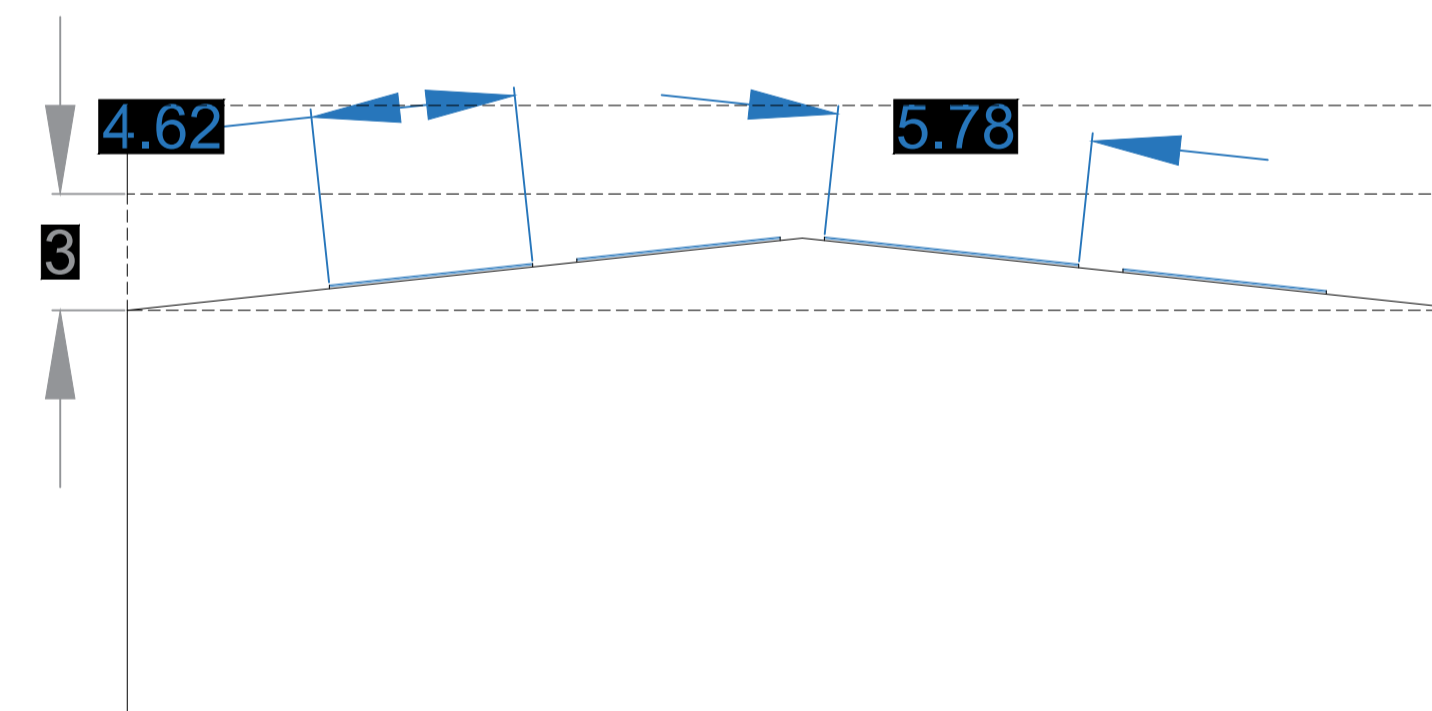

Roof Pitch: 10°
Eaves Height: 9 Meters
Roof Type: Steel Trapazoidal
Inverter Location: North West & North East
Permanent Roof Access: Unknown

COMPANY DETAILS



EDEN GENERATION LTD
 28 Queen Street, London, EC4R 1BB
 Tel : 0345 257 0017
 projects@edengeneration.co.uk
 www.edengeneration.co.uk
 (Company ID.13182727)

PROJECT KEY

- Module or array position
- Building Boundary
- Parapet Wall
- Array Dims
- Building Dims

PROJECT DETAILS

Gallagher Retail Park
 Units E1 & E2 Gallagher Retail Park
 Gallagher Retail Park
 Bristol
 BS30 7DA

PROJECT DESCRIPTION

TOTAL POWER:	171.7 kWp
No. of MODULES:	340
MODULE DETAILS:	JA Solar JAM66S30 505/MR
INVERTERS:	2 x SolarEdge SE66K Total: 132kW DNC: 145.2 kVA

ELEVATIONS

DESCRIPTION:	NESW Elevations
DRAWING No.	GRP-211223-ELEV-V1
DESIGNED by:	Adam Rutherford
APPROVED by:	AR
Date:	21-12-23
ISSUE:	V1
SCALE:	Dims (m) on Drawing