

New uPVC double glazed window, style to match existing house to give min 1.4 W/m²k U value. Glazing to be opaque. Catnic CH110/100 over with 150mm minimum end bearings

New cavity wall tied to existing house with Stainless steel crocodile starter ties to manufacturers recommendations

New solid wall tied to existing house with Stainless steel crocodile starter ties to manufacturers recommendations

Brick feature pier to match existing house

3 piece bathroom suite comprising Shower, WC and basin, specification by client

312.5 thick cavity wall, 102.5 brickwork outer skin, 110mm cavity partial fill with 90mm thick Kingspan Kooltherm K106 Cavity Board insulation, 100mm thick lightweight block inner skin to achieve min 0.17 W/m²k U value

Mechanical extract vent wired to lighting to provide 15 litres per second extract with overrun facility to terminate through wall

100mm wide stud wall boarded with 2 layers 12.5mm wallboard to dressing room side and aquaboard or similar in shower room, insulated with 50mm insulation

Dressing room furniture specification to clients specification

100mm wide stud wall boarded with 2 layers 12.5mm wallboard both sides, insulated with 50mm insulation

All doors to be softwood, to clients specification, 720mm wide in frames to suit

Brick feature pier to match existing house

New uPVC double glazed window, style to match existing house to give min 1.4 W/m²k U value. Catnic CH110/100 over with 150mm minimum end bearings

New roof to match existing, all tiles to be colour matched and slope to match existing. Ridge to be fully water proofed with lead as existing lean to

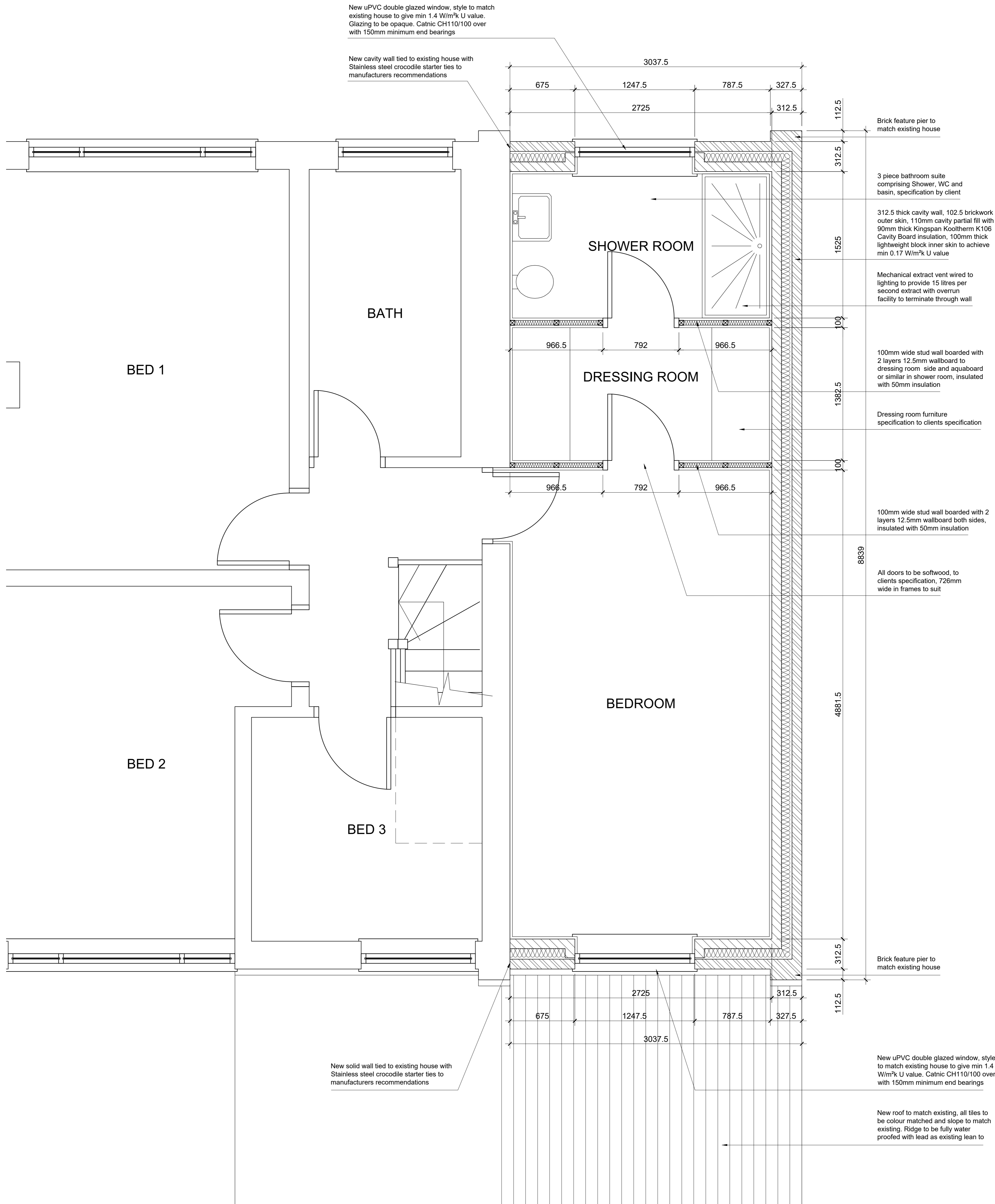

STATUS
PROJECT
2 PRIMROSE AVE
NEWARK
DRAWING
EXTENSION TO DWELLING
PROPOSED FIRST FLOOR PLAN

SCALE 1:20 SHEET SIZE A1 DRAWN BY DS CHECKED BY DATE 16/10/2023
PROJECT NO. DRAWING NO. REVISION
PAV (20)101