

01 Existing Ground Floor Plan
1:100 @ A3

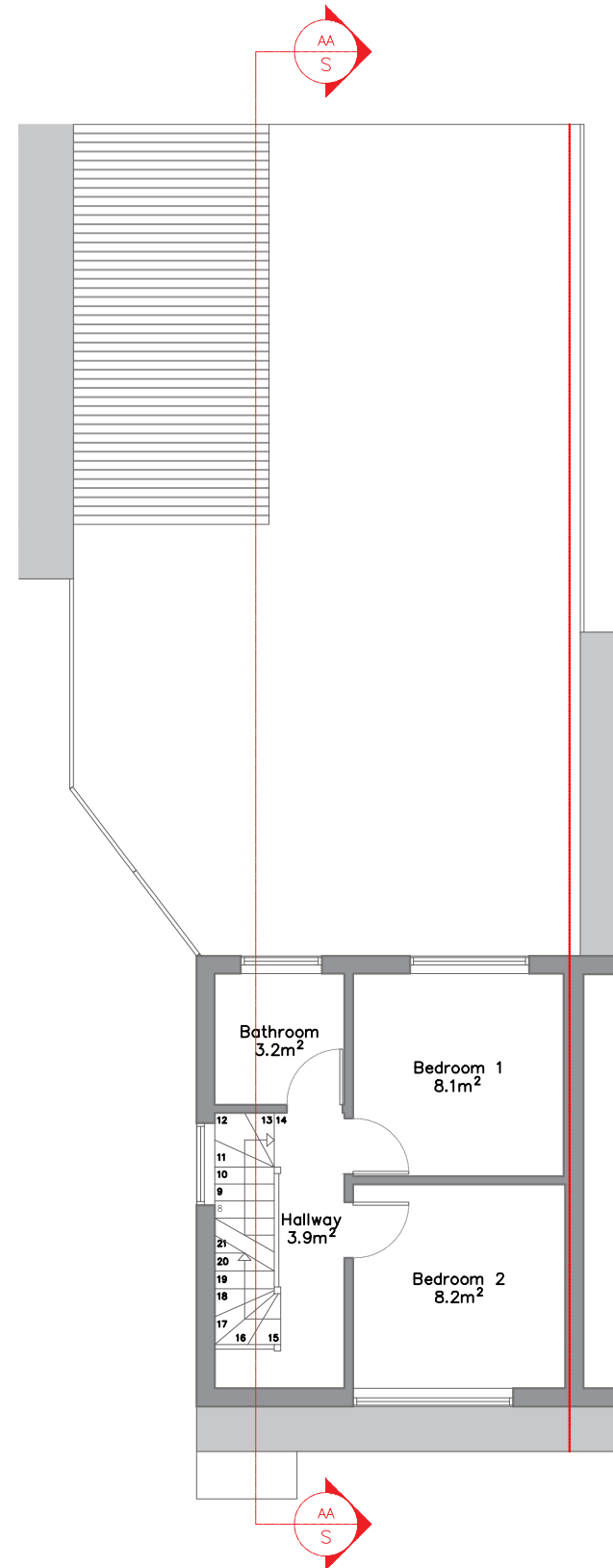

02 Existing First Floor Plan
1:100 @ A3

Key Plan:

Scale: 1:100 @A3

Key:

General Notes:

Proposed Notes:

A December 2023

PLANNING ISSUE	
Project Number:	23002
Date:	December 2023
Scale:	1:100 @ A3
Project:	79 Mimms Hall Road, EN6 3DX
Drawing Title:	Existing Ground & First Floor
Drawing Title:	23002-PL100-A
Drawn: IB	Rev: A



I.B Architectural Design
Copyright I.B Architectural Design
No implied license exists. This drawing should not be used to calculate areas for the purposes of valuation. All dimensions to be checked on site by the contractor and such dimensions to be their responsibility. Do not scale drawings. All work must comply with relevant British Standards and Building Regulations requirements. Drawing errors and omissions to be reported to the designer.

