



KEY TO SYMBOLS

- SIDE-ENTRY GLAMPING POD (BRECON MODEL)
- FRONT-ENTRY GLAMPING POD (BLENCATHRA MODEL)
- EXISTING STONE WALL
- EXISTING TREE
- NEW NATIVE TREE
- EXISTING HEDGE
- EXISTING VEGETATION
- NEW NATIVE SHRUBBERY
- MEADOW GRASS WITH WILD FLOWERS
- NEW PERMEABLE FOOTPATH
- NEW PERMEABLE TRACK
- EXISTING TARMAC

KEY

1. Public Road - A841
2. Existing gated access
3. Refuse and recycling storage
4. Existing dwelling - site manager accommodation
5. Parking and turning area
6. Existing tank - to be boxed in
7. Existing sheds to be replaced with new shed for site storage including secure bicycle storage
8. Barrel sauna
9. Neighbouring dwellings

OWNERSHIP BOUNDARY  
 AREA = 2,154 m<sup>2</sup>

SITE BOUNDARY  
 SITE AREA = 795 m<sup>2</sup>

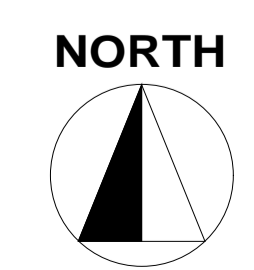
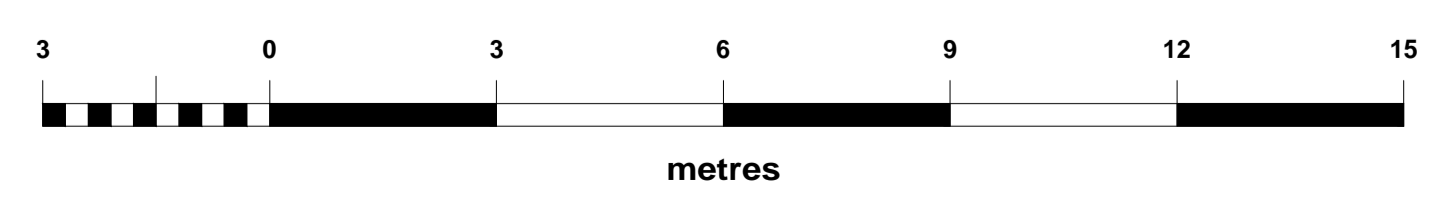

Date	Description	Rev	By

Revision Description

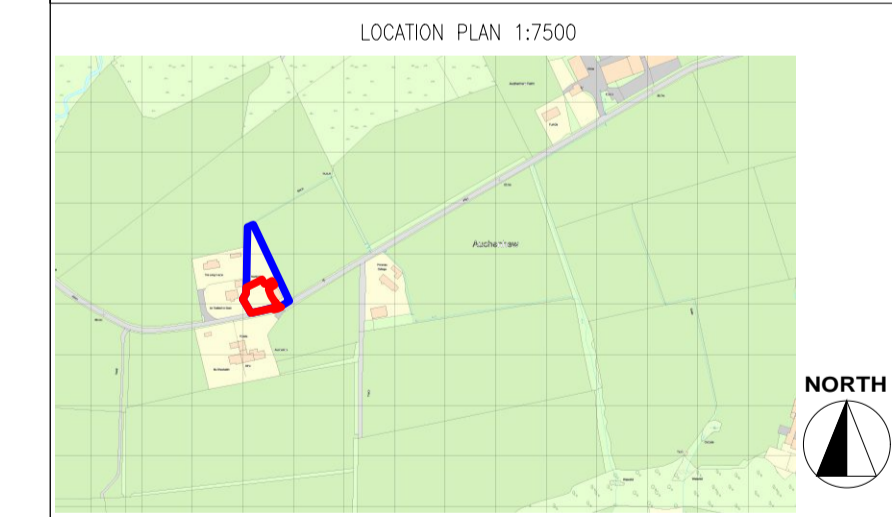

Project:  
**Proposed Glamping Site - For Iain Bermingham**  
 Northern Heights, Kildonan, Isle of Arran  
 KA27 8SG

Drawing Title:  
**PROPOSED LAYOUT PLAN**

Drawing Number:  
**230830-01-02**

Revision: -  
 Date: 30.10.2023  
 Scale: 1:100 @ A1  
 Drawn By: XD  
 CAD Dwg File: -  
 Checked By: -

Issue Status:  
**Full Planning Application**