

KEY TO SYMBOLS



Low Level Path Lighting

Lanea Path Lighting Bollard with PIR sensor.

Benefits:

- LED mains wired.
- Low level height, only 40cm high.
- LED bulbs installed into this pillar lamp are in such a manner that they shine downwards onto cascading reflectors, keeping all light at low level.
- Integrated PIR sensor, keeping light levels low and only on when required.
- Range 2-8metres, set at 5m as shown.
- Lighting duration (5 seconds to 6 minutes) are configurable.
- Detects movement at an angle of 90 degrees.



Date	Description	Rev	By

Revision Description

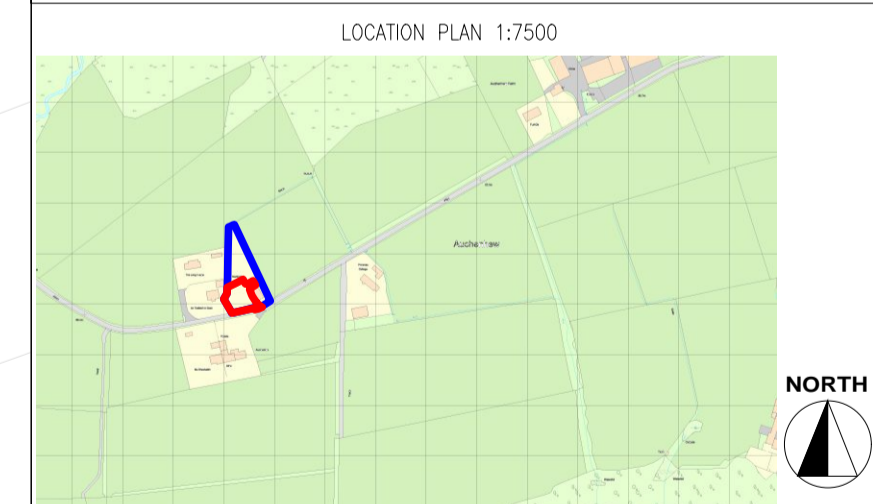

Project:
 Proposed Glamping Site - For Iain Bermingham
 Northern Heights, Kildonan, Isle of Arran
 KA27 8SG

Drawing Title:
 PROPOSED LIGHTING PLAN

Drawing Number:
230830-01-09

Revision: -
Date: 30.10.2023
Scale: 1:100 @ A1
Drawn By: XD
CAD Dwg File: -
Checked By: -

Issue Status:
Full Planning Application



 OWNERSHIP BOUNDARY
 AREA = 2,154 m2

 SITE BOUNDARY
 SITE AREA = 795 m2

