



APPLICATION FOR WORKS TO PROTECTED TREES (INCLUDING TREES IN A CONSERVATION AREA)

PLEASE READ THE ATTACHED NOTES FOR GUIDANCE BEFORE COMPLETING THIS FORM

1. Your Details 2. Agent Details (if applicable) Name, Address, Tel. No, E-mail address

* If you provide an e-mail address, we will undertake all further communication by e-mail, unless otherwise advised; If an agent's details are provided, all correspondence will be undertaken through the agent.

Are you the owner of the trees subject to this application? Yes [] No []

3. Details of Owner of Trees (if different to applicant) Name, Address, Post Code, Tel. No, E-mail address

4. Location of Trees Provide a postal address where possible. If the location is unclear, or there is not a full postal address, describe it as clearly as possible (e.g. Land to the rear of 12 to 18 High Street or Woodland adjoining North Street). EH46 7HA

5. What are you applying for? (a) Works to trees protected by a Tree Preservation Order (b) Works to trees in a Conservation Area

6. Tree Preservation Order Details If you know which Tree Preservation Order protects the trees, enter its number or title below

7. Your application

Please identify the tree(s) and provide a full and clear specification of the works you want to carry out. Continue on a separate sheet if necessary

ONE LARCH FALLING OVER - LEANING ON TREE
ADJACENT. (SEE PHOTO.)
ROOT PLATE & BASE OF TREE MOVING WHEN
WINDY.

FELL TREE

REPLACES WITH TWO BROADLEAF SAPLINGS.

8. Reason for the Work

DANGER OF FALLING - LARCH.

9. Supporting Documentation and Declaration

I hereby apply for consent and declare that, to the best of my knowledge, the information contained in this application and in the submitted information is correct.

I attach:

- A plan identifying the location of the trees and any other documentation setting out the works applied for
- Copies of photographs/plans and/or sketches to support my application
- Copies of any letters or other correspondence, including any referred to in this application

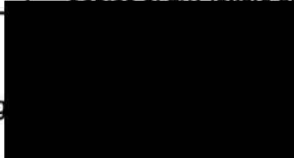
Signature  PRINT NAME C. Murray Date 10/12/23

Please send the completed form to:

Development Standards Division
Regulatory Services Department
Scottish Borders Council
Newtown St. Boswells
TD6 0SA

NOTES

THIS DRAWING MUST BE READ IN CONJUNCTION WITH STRUCTURAL ENGINEERING DRAWINGS BY SOC LTD.

17/01257/FUL
11/10/2017

Scottish Borders Council
Town And Country
Planning (Scotland) Act
1997

APPROVED

subject to the requirements of the associated Decision Notice

GARAGES-

Rev	Description	Date	Author

David J. Casey MCAT
Architectural Technologist
Professional Technologist
Registration No. 124

MR R. W. C. McLeod
Member and Examiner in Drawing Office

David J. Casey MCAT
Architectural Technologist
Professional Technologist
Registration No. 124

Date: 11/10/2017
Scale: 1:500
Drawing No: A/17/665/5
Sheet No: 0

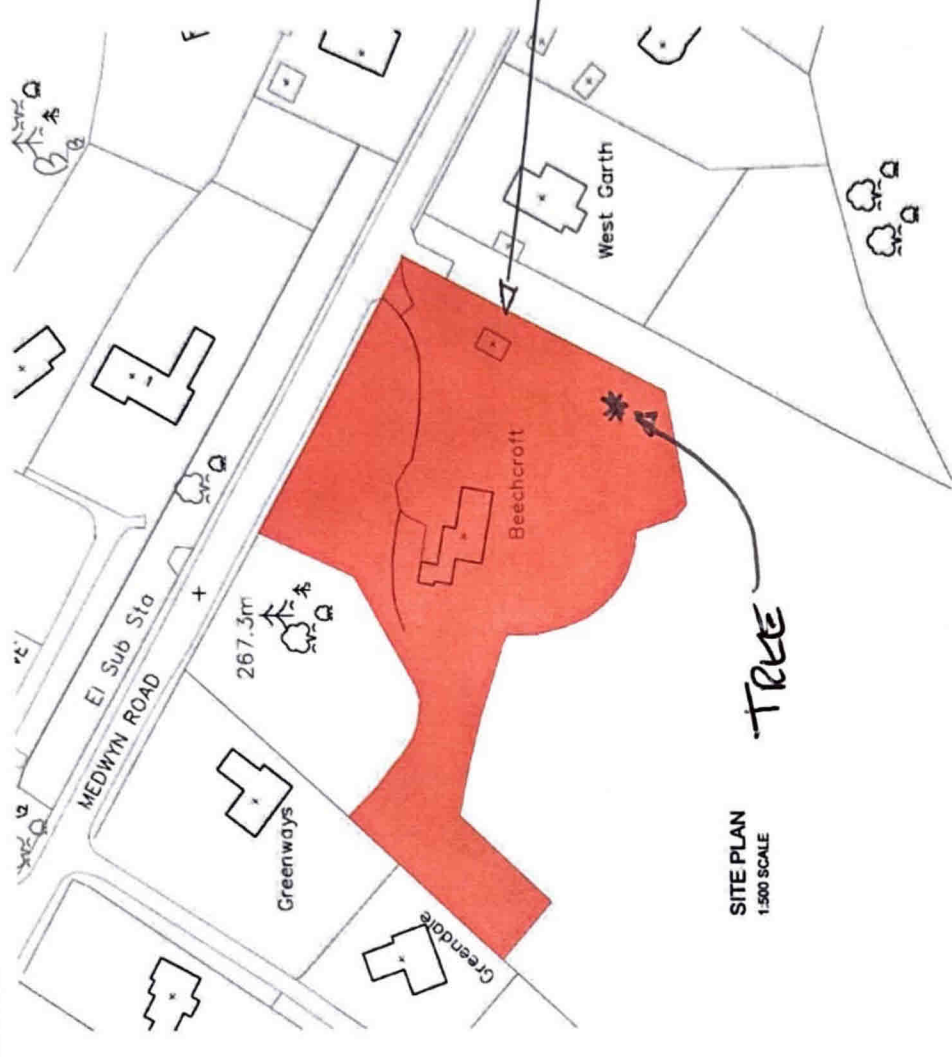

SITE PLAN
1:500 SCALE

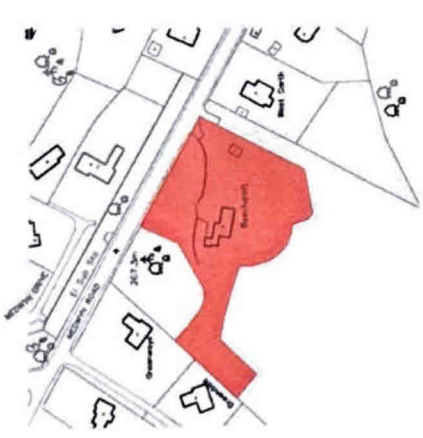

SITE LOCATION PLAN
1:1250 SCALE

