

Proposed Floor Plans inc. Parking and Soft Landscaping

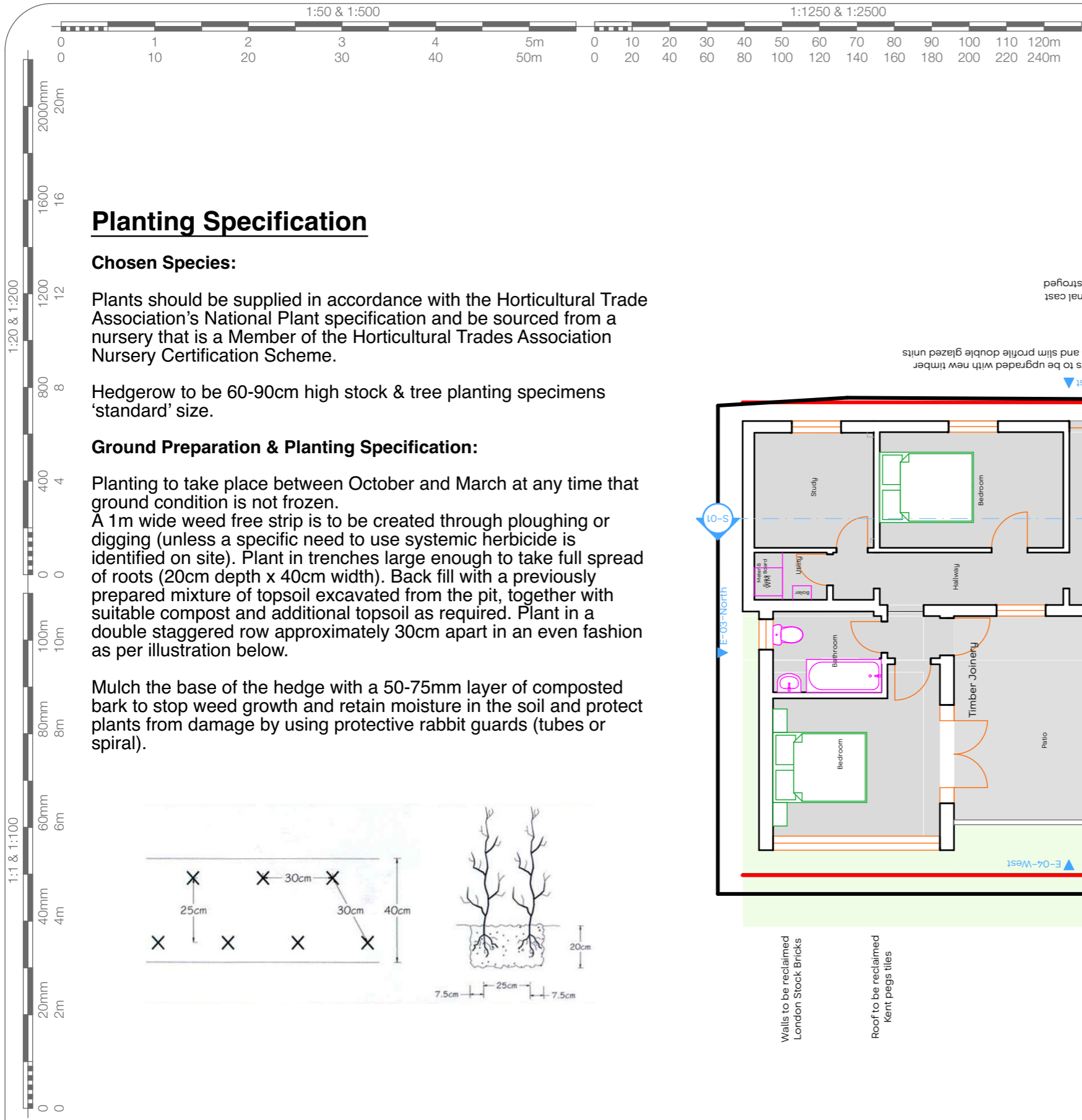

Planting Specification

Chosen Species:

Plants should be supplied in accordance with the Horticultural Trade Association's National Plant specification and be sourced from a nursery that is a Member of the Horticultural Trades Association Nursery Certification Scheme.

Hedgerow to be 60-90cm high stock & tree planting specimens 'standard' size.

Ground Preparation & Planting Specification:

Planting to take place between October and March at any time that ground condition is not frozen. A 1m wide weed free strip is to be created through ploughing or digging (unless a specific need to use systemic herbicide is identified on site). Plant in trenches large enough to take full spread of roots (20cm depth x 40cm width). Back fill with a previously prepared mixture of topsoil excavated from the pit, together with suitable compost and additional topsoil as required. Plant in a double staggered row approximately 30cm apart in an even fashion as per illustration below.

Mulch the base of the hedge with a 50-75mm layer of composted bark to stop weed growth and retain moisture in the soil and protect plants from damage by using protective rabbit guards (tubes or spiral).

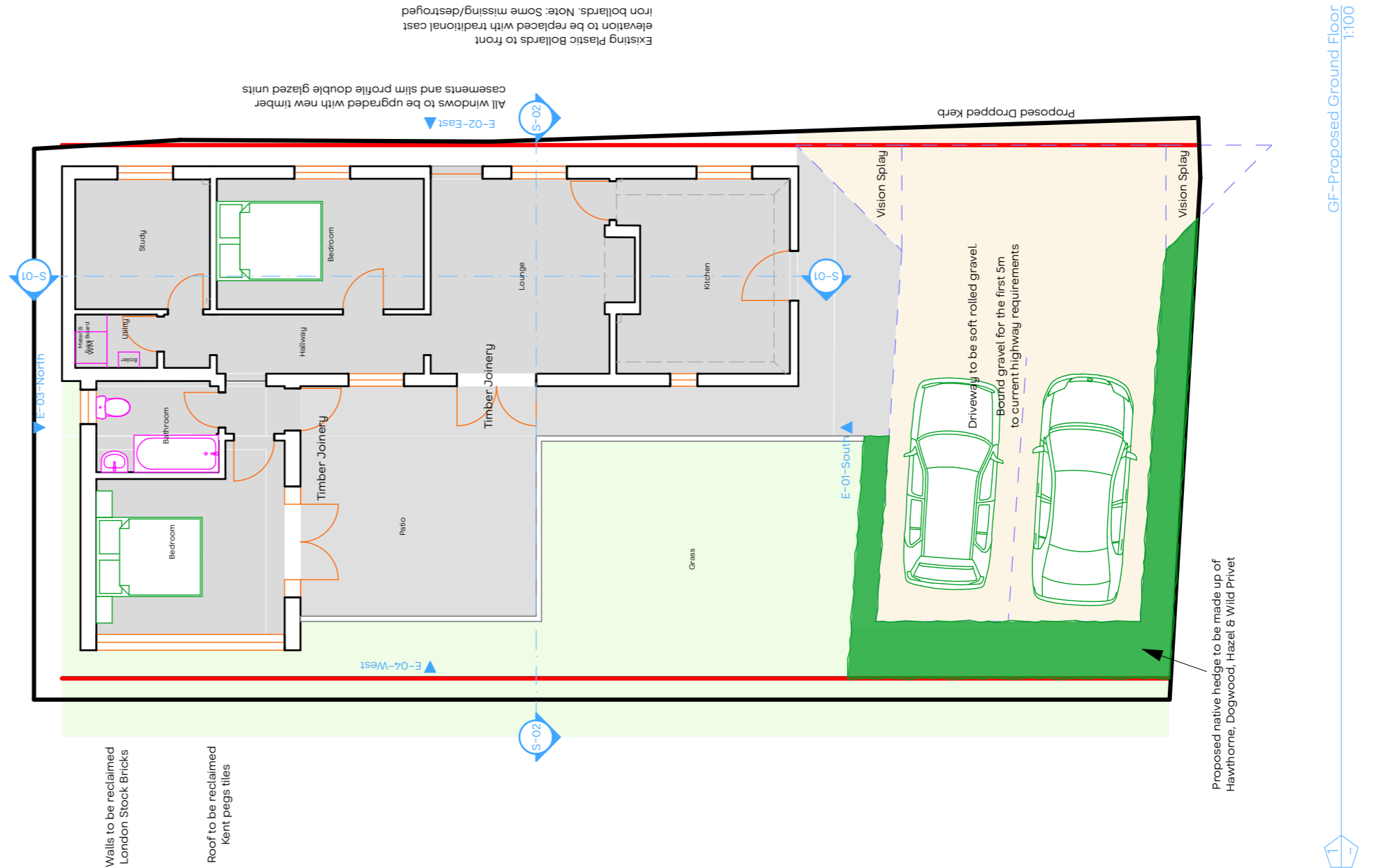
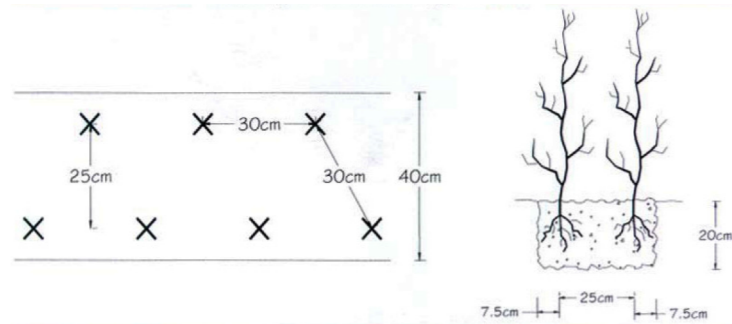

Address :- Tollhouse Cottage, North Street, Faversham, Kent	Scale :- As Marked	Date :- Sept 2023	Drawing No. :- P.03	Revision Notes :-
Project :- Addition of glass link and single storey extension	Paper Size :- A3	Drawn by :- JLRC	Revision No :-	