

Use of this data by the recipient acts as an agreement of the following statements. Do not use this data if you do not agree with any of the following statements:
 Ryder Architecture has co-ordinated relevant information received from third parties, but are not responsible for the content of the information received from others.
 The controlled version of this drawing should be viewed in DWG or PDF format not DWG or other formats. All prints of this drawing must be made in full colour.
 Where this drawing has been based upon Ordnance Survey data, it has been reproduced under the terms of Ryder Licence No. 100000144. Reproduction of this drawing in whole or in part is prohibited without the prior permission of Ordnance Survey.
 Do not scale the drawing. Use figured dimensions in all cases. Check all dimensions on site. Report any discrepancies in writing to Ryder before proceeding.

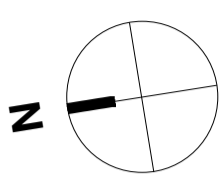

- LEGEND**
- Site Boundary
 - LEVELS**
 - + Existing Level
 - (E)30.000
 - + Proposed Level
 - 30.000
 - 1:40 Proposed Gradient
 - + Proposed Road Levels & Car Park Levels By Curtins Engineers
 - Existing trees to be retained
 - Existing trees to be removed
 - Existing woodland to be removed

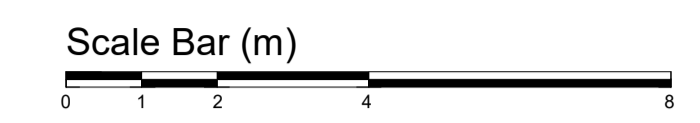
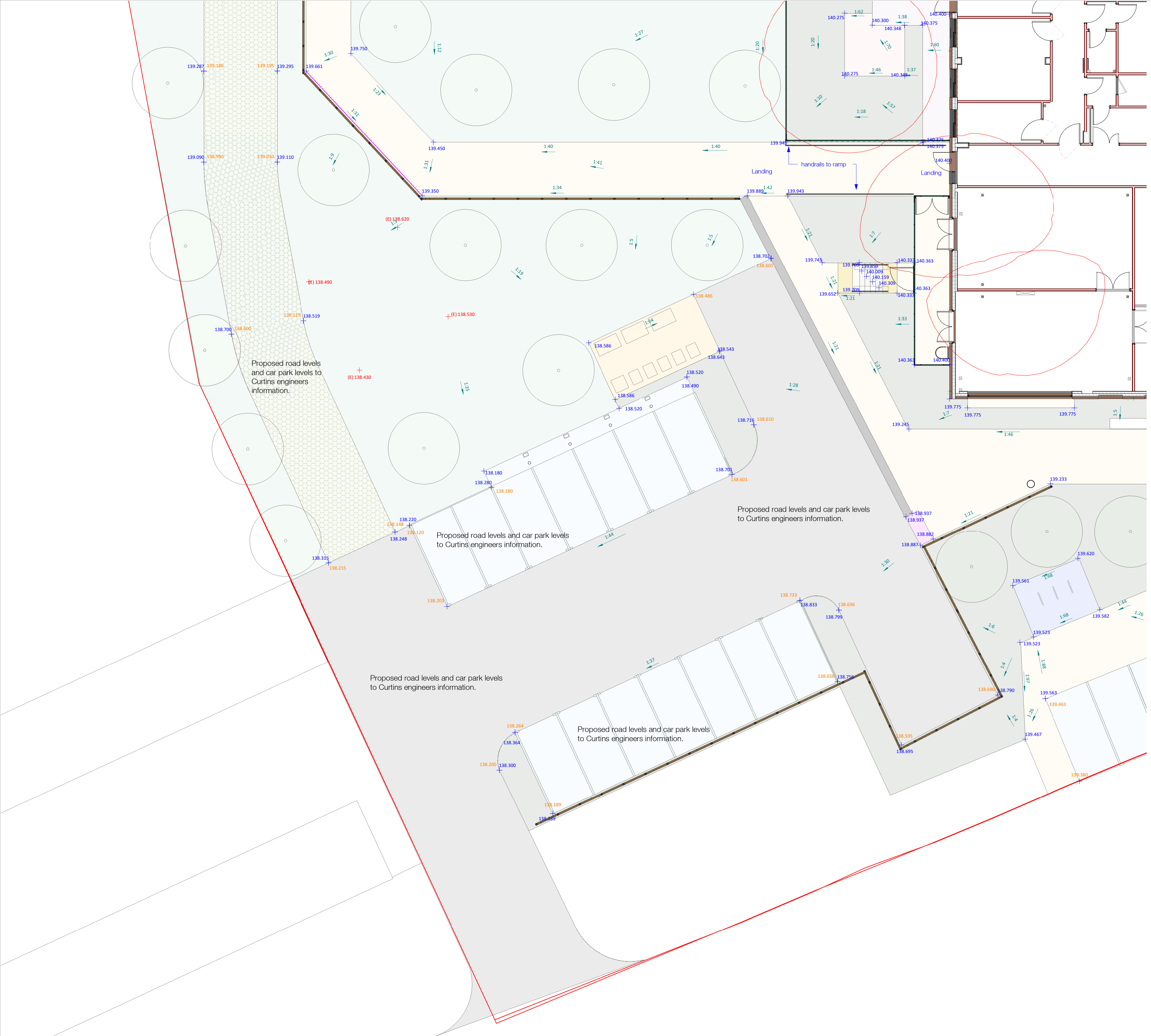

C6	Issued for planning	AOL	AOL	14/12/23
C5	Retaining walls to the east and south orientated and replaced with a Geogrow structure. Position of post and rail fence amended to suit location of Geogrow structure. Layout of maintenance path to the east revised to suit position of Geogrow. Double gate added to Acute garden. External furniture raised planters for acute gardens revised to facilitate drainage. Removal of existing gas house and timber. Facilitate paving indicate for crossings. Levels along easter boundary revised to suit geogrow structure. Artificial grass omitted. Levels, external furniture and softlandscape on courtyards revised to allow drainage into proposed gullies. Surface for courtyard confirmed by I-P to be not permeable.	AOL	AOL	24/10/23
C4	Additional levels and labels added to ramp access	AOL	AOL	13/12/22
C3	Proposed levels updated, following coordination with Curtins drainage engineer	KSHA	AOL	07/12/22
C2	Issued for Stage 5, additional labels and notes added to drawings.	TJ	MG	28/10/22
C1	Issued for Stage 5	TJ	CS	07/10/22
Rev	Description	Drawn	Checked	Date

Suitability
 Construction Approval

Project
 Derbyshire Healthcare NHS Foundation Trust
 New Mental Health Accommodation - Chesterfield (Landscape)
 Chesterfield Hospital, Derbyshire North

Drawing
 Indicative Levels Sheet 4

Project ID	Originator	Zone	Level	Type	Role	Number
RG0004	- RYD	- ZZ	- XX	- DR	- L	- 2144
Project Number	Scale at	Status	Revision			
10443-00	1 : 100	S4	C6 .0			