

The use of this data by the recipient acts as an agreement of the following statements. Do not use this data if you do not agree with any of the following statements:-

Ryder Architecture has co-ordinated relevant information received from third parties, but are not responsible for the content of the information received from others.

The controlled version of this drawing should be viewed in DWG or PDF format not DWG or other formats. All prints of this drawing must be made in full colour.

Where this drawing has been based upon Ordnance Survey data, it has been reproduced under the terms of Ryder Licence No. 100000144. Reproduction of this drawing in whole or in part is prohibited without the prior permission of Ordnance Survey.

Do not scale the drawing. Use figured dimensions in all cases. Check all dimensions on site. Report any discrepancies in writing to Ryder before proceeding.

NOTE:

Design intent only. Manufacturer to provide shop drawings for approval prior to fabrication.

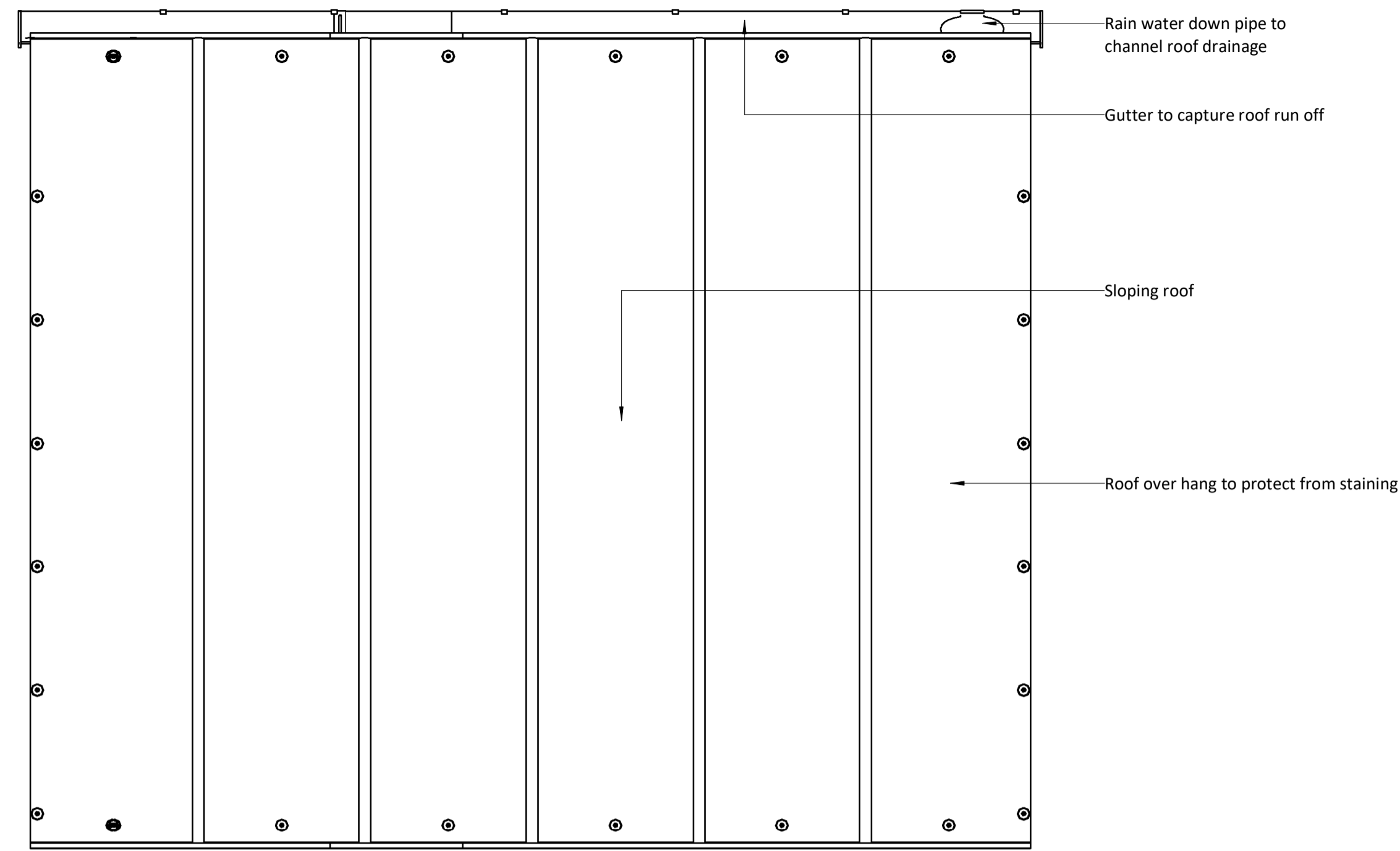

Plan view

Q50 211 Cycle Compound
 Manufacturer: Langley Design or similar approved
 Product reference: Sheldon cycle shelter SCS310
 Type: Semi enclosed cycle parking compound. Three sides clad in timber
 Material:
 Steel structure: galvanised
 Timber: treated redwood
 Finish: as manufactured
 Size: 4m long x 3.1m deep x 2.6m high. Bespoke size to suit number of cycle spaces
 Capacity: 3 cycle hoops to hold 4 bikes
 Fixing: Below ground foundation fixed to manufacturers specification and foundation to engineers detail.

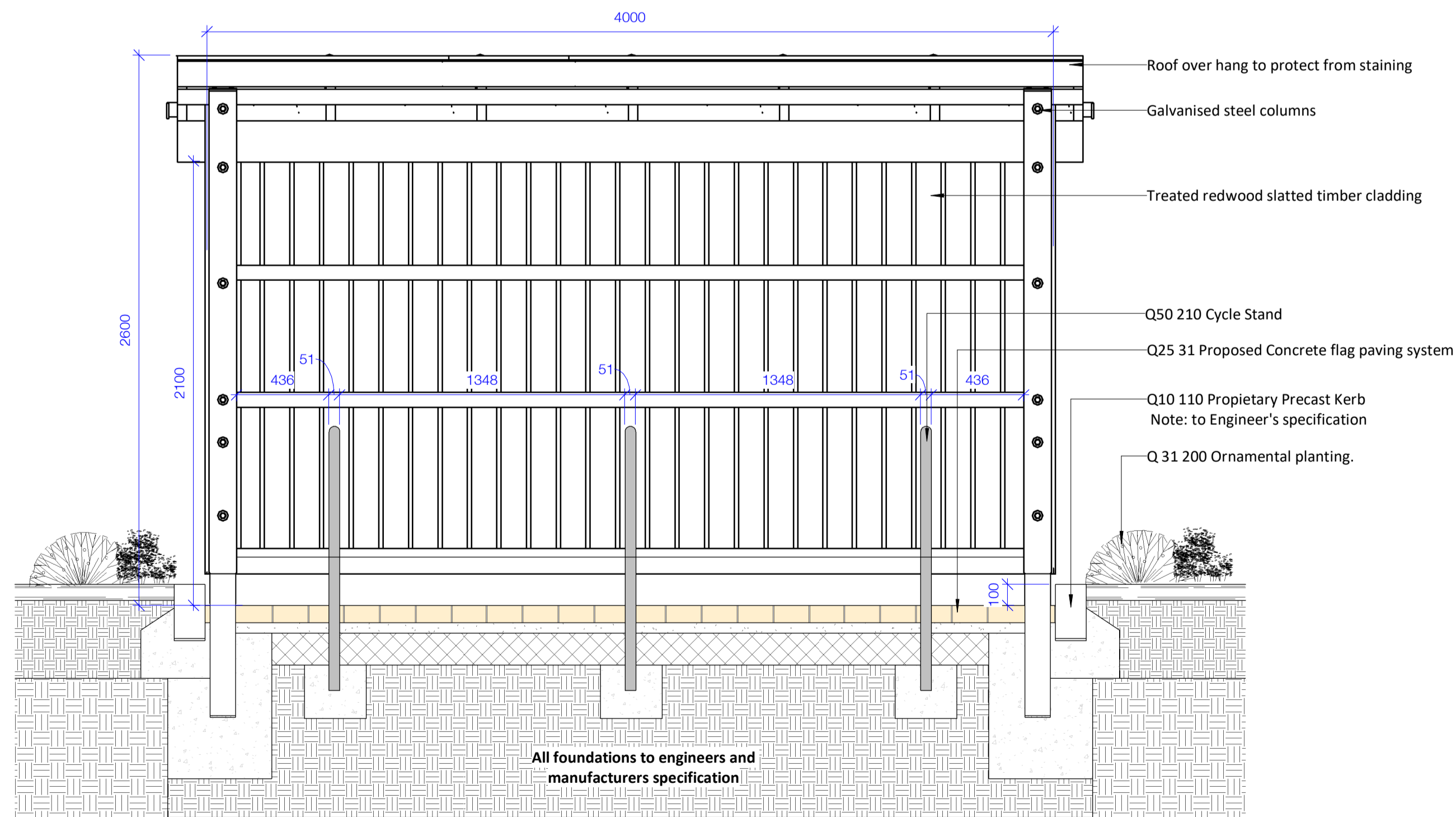

Front view

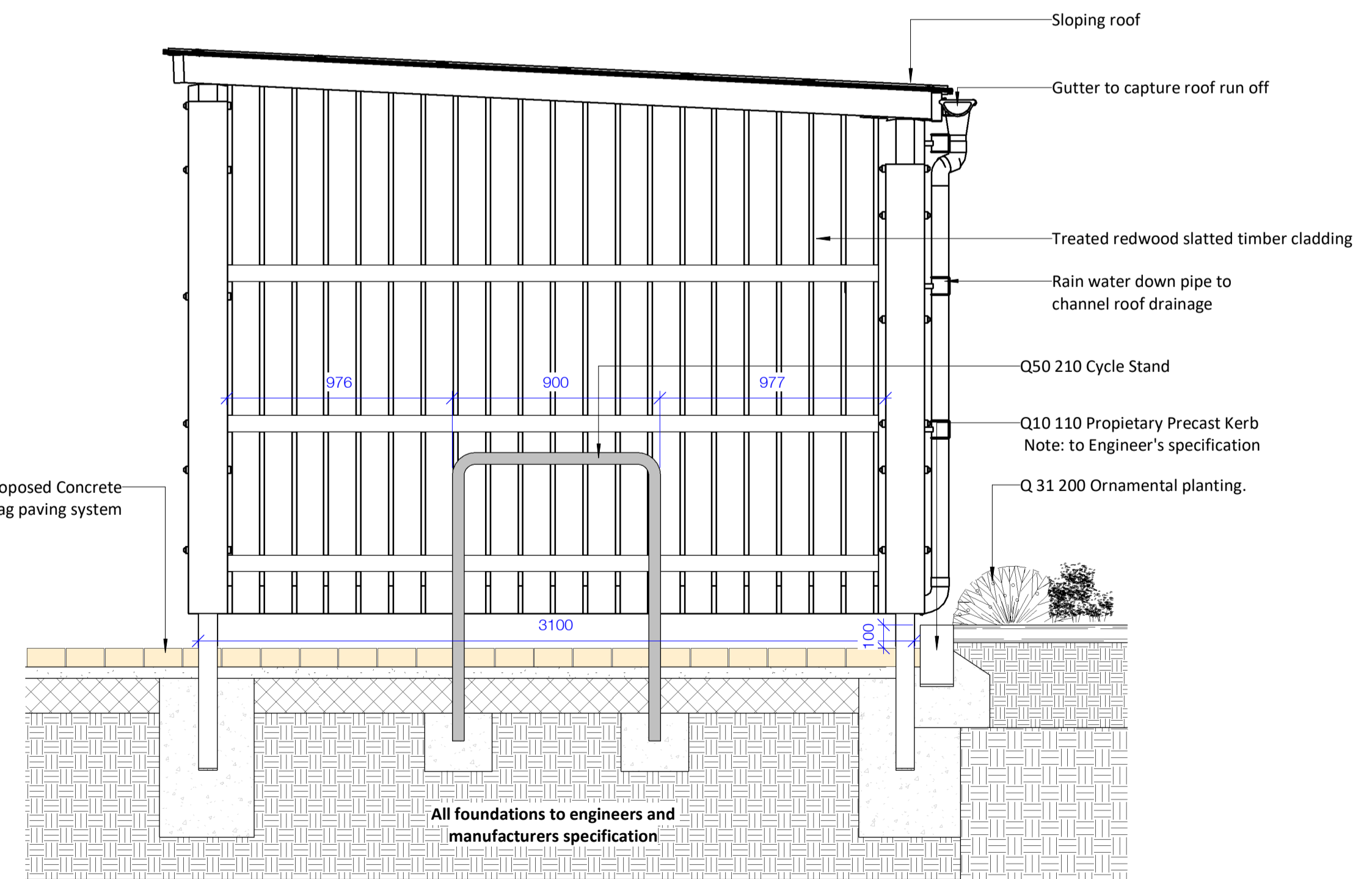

Section

C2	Issued for planning	AOL	AOL	14/12/23
C1	Issued for Stage 5	TJ	GS	07/10/22
Rev	Description	Drawn	Checked	Date

Suability
 Construction Approval
 Project
 Derbyshire Healthcare NHS Foundation Trust
 New Mental Health Accommodation - Chesterfield (Landscape)
 Chesterfield Hospital, Derbyshire North

Drawing Cycle Shelter Detail					
Project ID	Originator	Zone	Level	Type	Role
RG0004	- RYD	- ZZ	- XX	- DR	- L
Project Number	Scale at	Status	Revision		
10443-00	1 : 20	S4	C2	.0	