

EXISTING SITE PLAN  
0 2 4 6 8 10 1:200

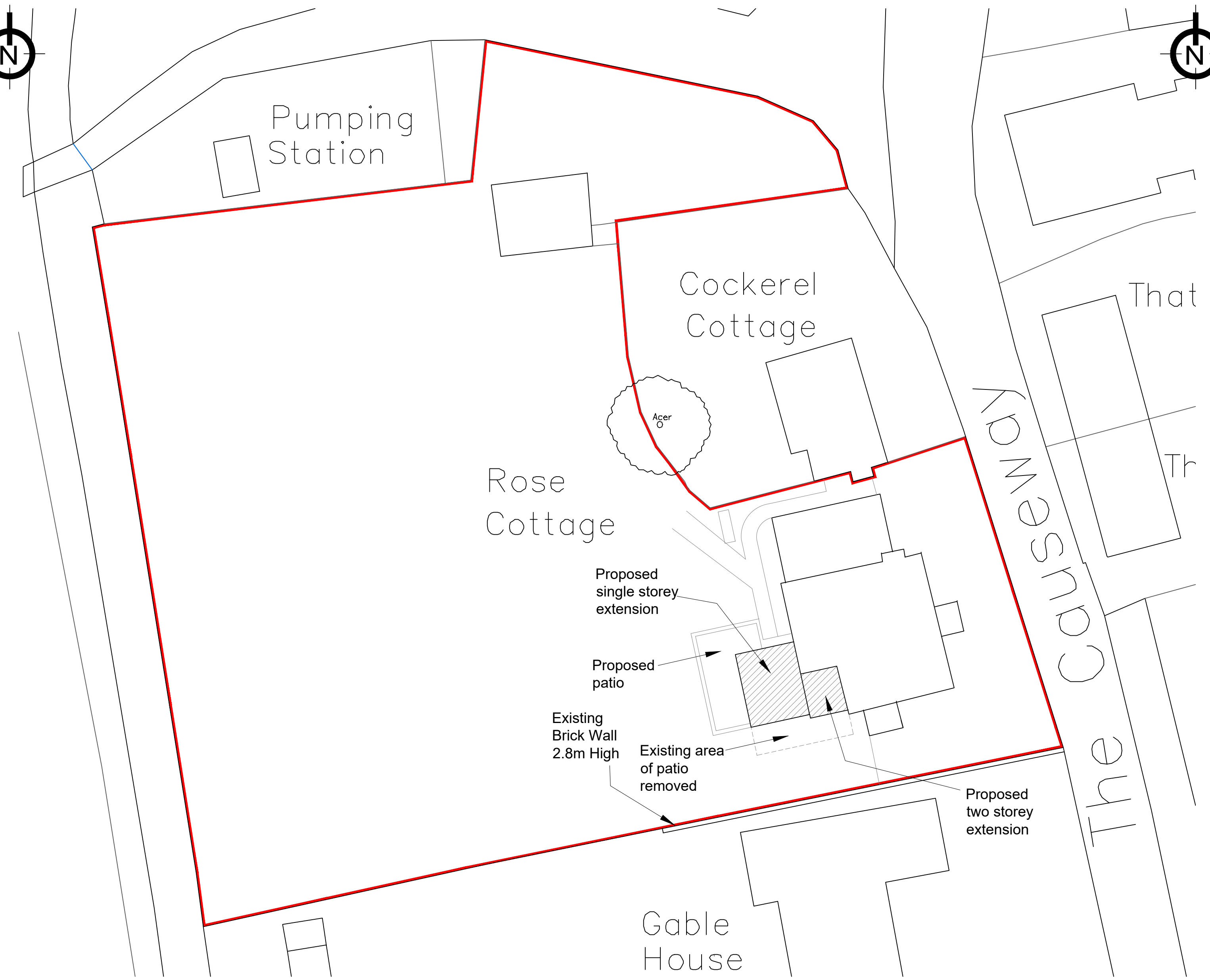

PROPOSED SITE PLAN  
0 2 4 6 8 10 1:200

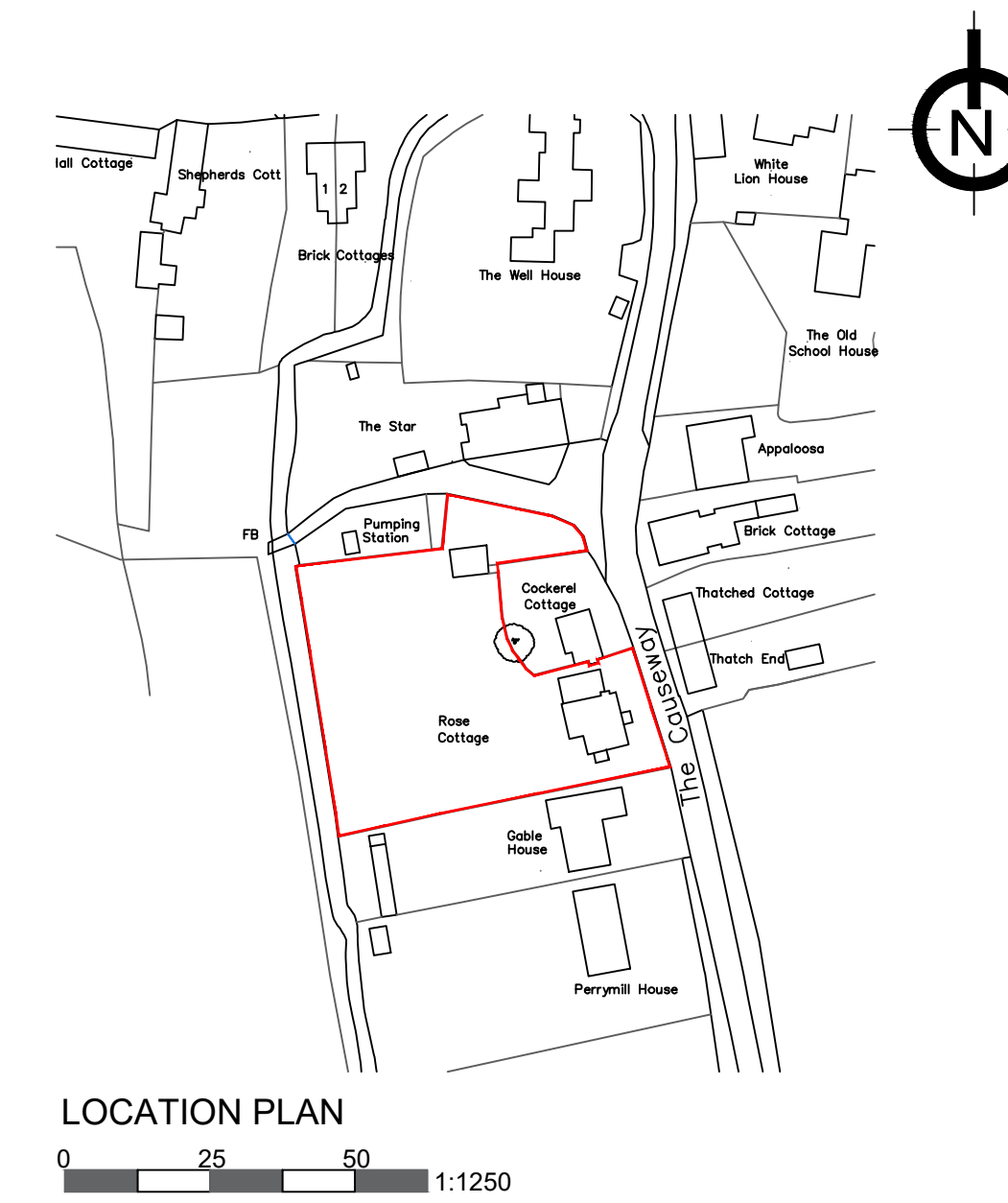

LOCATION PLAN  
0 25 50 1:1250

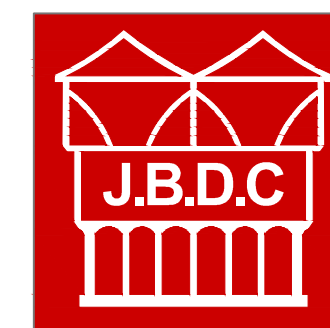

**jbell design and conservation ltd**  
 Suite G2, Holly House Business Centre  
 220-224 New London Road, Chelmsford, CM2 9AE  
 T: 07484 701704  
 E: jbell@designandconservation.co.uk  
 www.designandconservation.co.uk

Client :	-	Scale :	1:200/1:1250 @ A1
Project :	Rose Cottage, The Causeway Furneux Pelham, Hertfordshire, SG9 0LN	Status :	Planning
Drawing :	Existing and Proposed Site plan	Dwg No :	2023-733-002

© THIS DRAWING IS THE COPYRIGHT OF J BELL DESIGN AND CONSERVATION LTD. It shall not be in any way used or reproduced without their prior written consent. All dimensions are to be checked on site or in the workshop prior to commencing any work. Work only to figured dimensions. Any discrepancies are to be reported to the Architect.