

HEAD DETAIL
1:2 AT A1

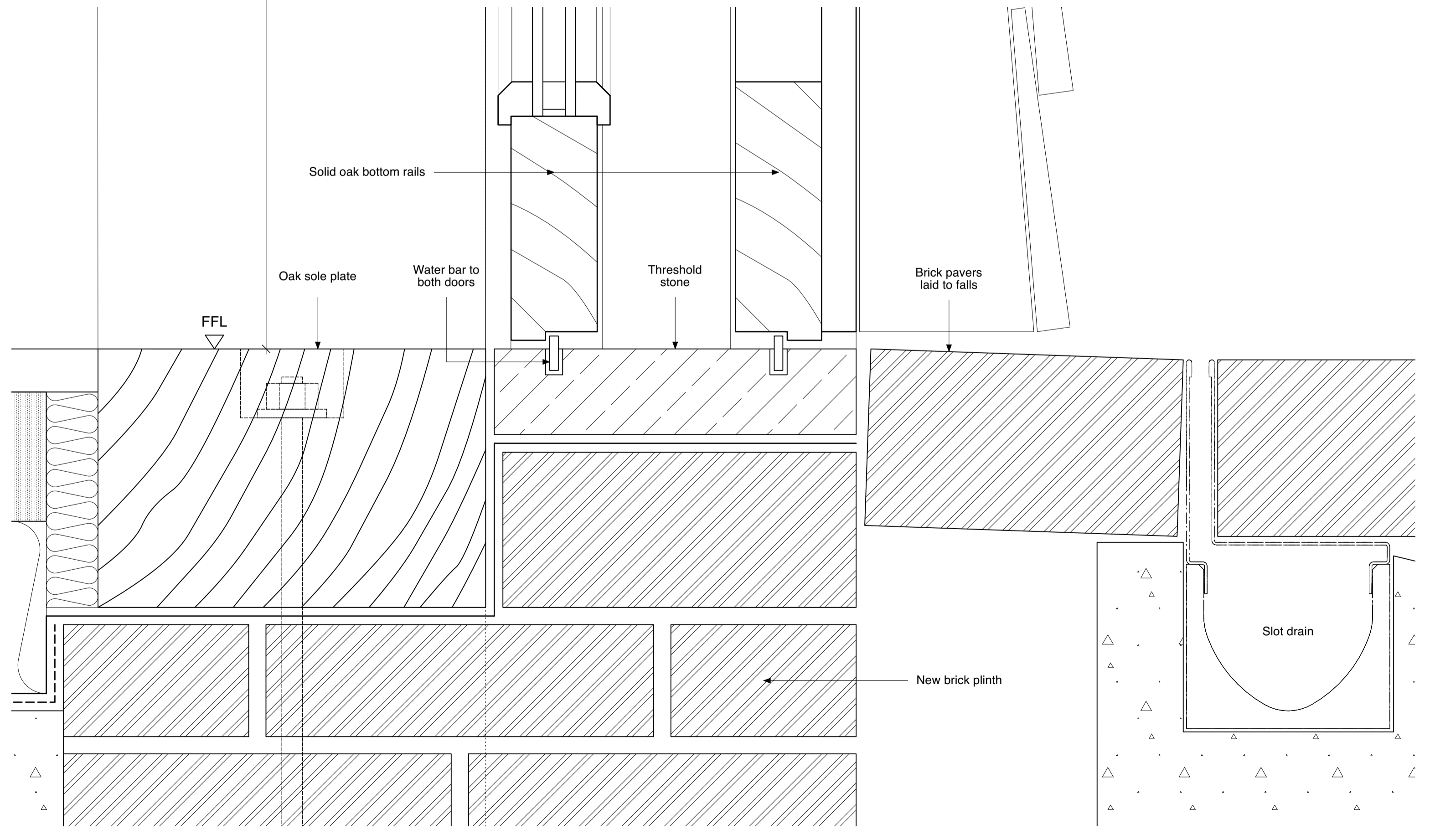

THRESHOLD DETAIL
1:2 AT A1

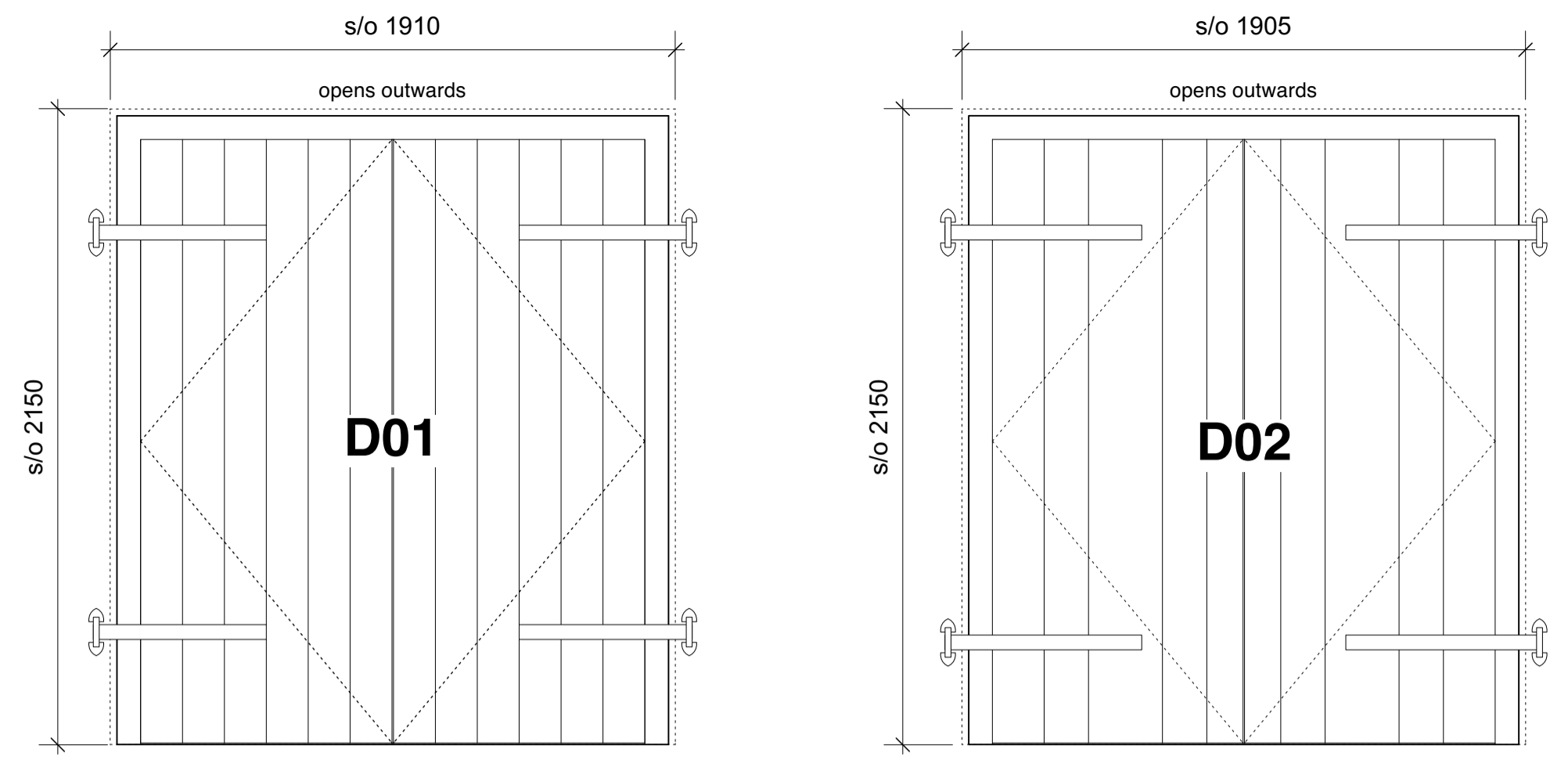

ELEVATIONS
1:20 AT A1

DOOR SPECIFICATION:

SYSTEM: BOARDED OUTER TIMBER DOORS AND GLAZED INNER DOORS
DEPTH OF REVEAL: 125 MM
METHOD OF OPENING: SIDE HUNG
MATERIAL:
SOLID OAK FRAME, STILES AND BOARDING TO OUTER DOOR.
DOUBLE GLAZED INNER DOOR.
FINISH:
OILED OAK

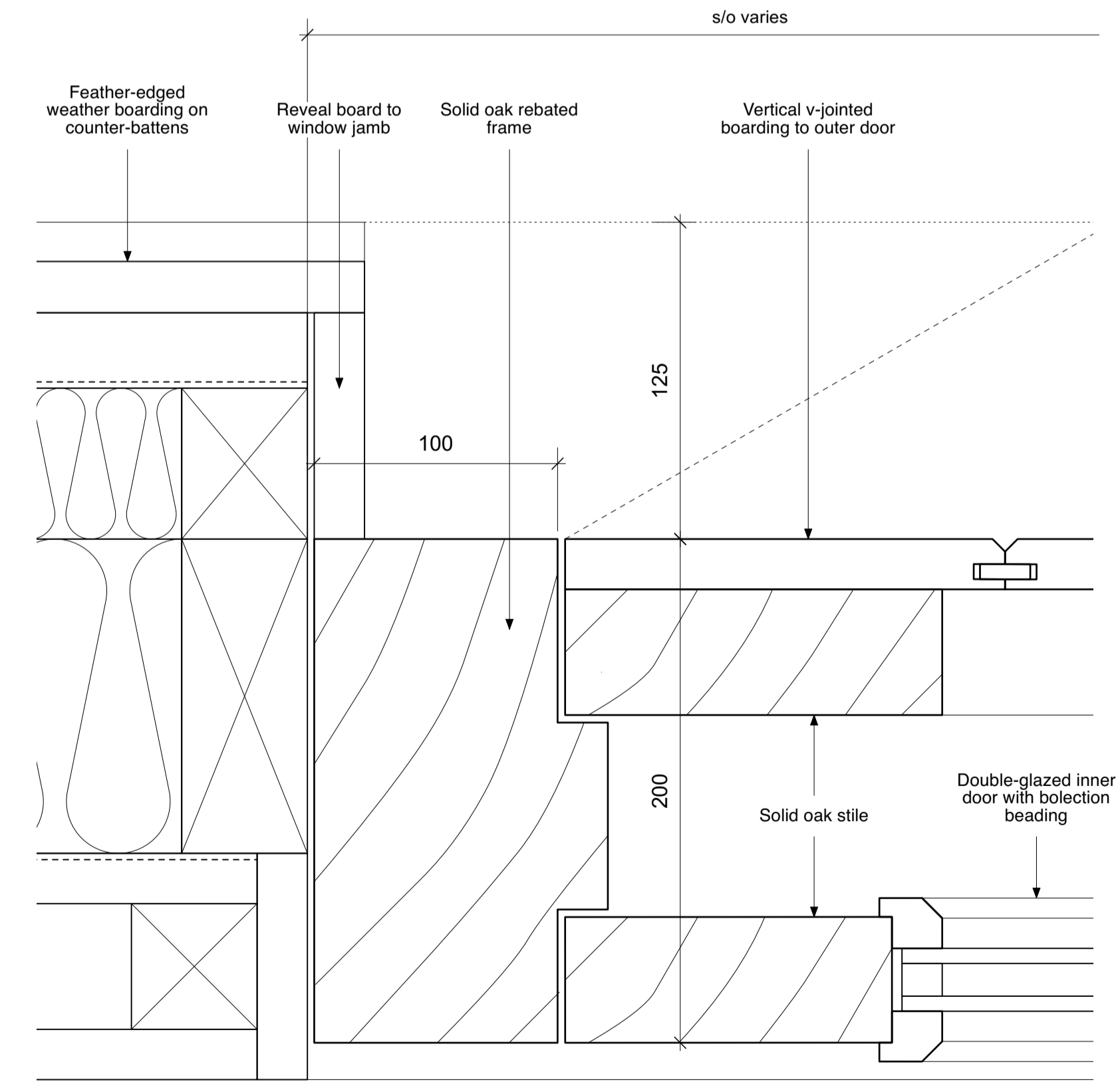

JAMB DETAIL
1:2 AT A1



DO NOT SCALE FROM THIS DRAWING.

All critical dimensions not noted are to be measured on site or referred to architect.

Notes

Revisions

P1	10.01.22	Preliminary issue.
P2	23.02.22	S/O information added.
T1	05.04.22	Tender Issue
C1	05.12.22	Construction Issue

Drawing Number 1022-36-C1

Content
TYPICAL EXTERNAL
DOOR DETAILS

Scale 1:20 & 1:2 at A1 Date DEC 2021

**THE OLD RECTORY,
ALBURY - BARN**

OLIVER WEST & JOHN SCOTT ARCHITECTS
The Studio, 3A Bath Road,
Bedford Park W4 1LL
E-mail: studio@westscottarchitects.co.uk

Tel 020 8995 4275
Fax 020 8742 7186

Key

Drawing Number 1022-36-C1