

Key Plan

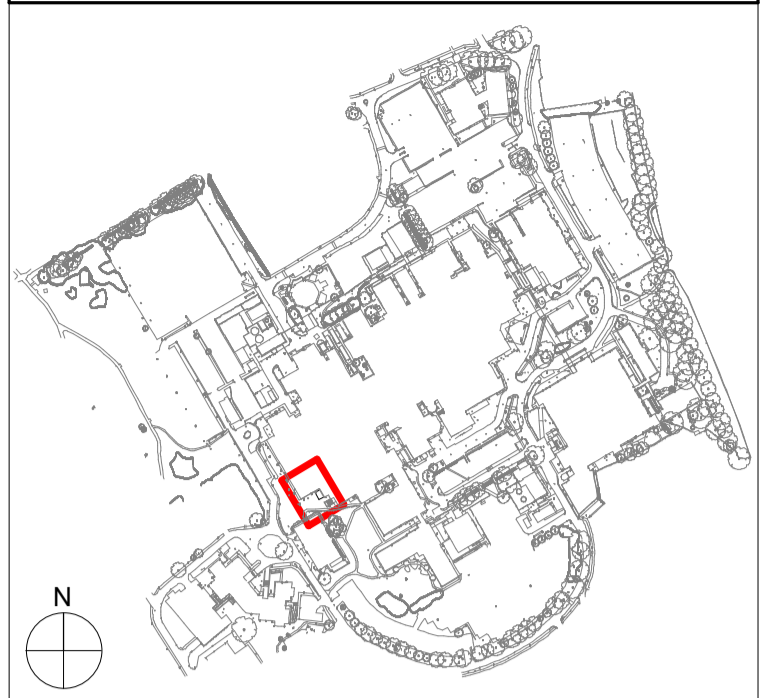

General Notes

SCALE 1 : 200
 0 4 8 12

- Existing Haygarth Building.
 - Existing wider estate.

Rev	Description	Date	Dr by	App by
P1	First Issue for Planning	17.11.2023	IMS	RB

original by
I Miteva-Sawyer

date created
09/13/23

approved by
RB

AHR AHR Architects Ltd
 First Floor
 Victoria House
 Victoria Quay
 Shrewsbury
 SY1 1HH
 United Kingdom

T +44(0)1743 283000
 F +44(0)1743 232717
 E shrewsbury@ahr.co.uk
 www.ahr.co.uk

client name	NHS Countess of Chester		
project	Countess of Chester Hospital: Proposed Blue Skies Balcony		
drawing	Site Plan (Existing)		
computer file	W:\projects\AS_S\2021\00740.000 - CoCH Blue Skies\23_BM\220		plot date
2021.00740.000	WF:\DWG\CCBS-AHR-ZZ-ZZ-DR-A-084000 (Haygarth Building Model.rvt		17.11.2023
drawing number	project number	scale	As indicated@A1
CCBS-AHR-ZZ-ZZ-DR-A-08101	2021.00740.000	As indicated@A1	
drawing number	rev	issue status	
CCBS-AHR-ZZ-ZZ-DR-A-08101	P1	S2	

This drawing is to be read in conjunction with all related drawings. All dimensions must be checked and verified on site before commencing any work or producing shop drawings. The originator should be notified immediately of any discrepancy. This drawing is copyright and remains the property of AHR.