

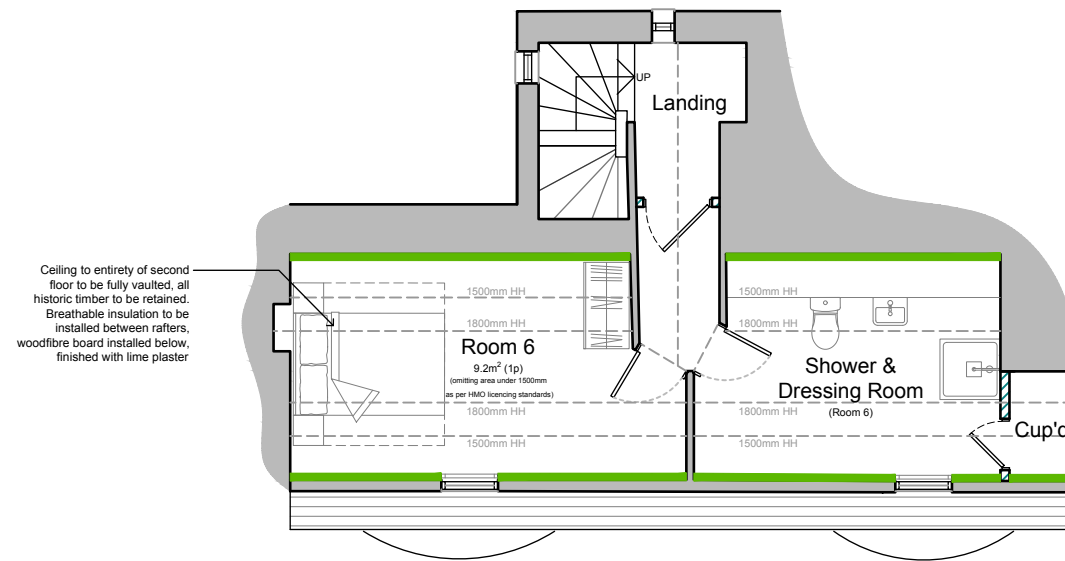





FIRST FLOOR PLAN



SECOND FLOOR PLAN

Key:

-  - Existing wall
-  - Proposed wall
-  - Acoustic insulation over existing structure (in line with Syntegra - Sound Insulation Assessment)
-  - Breathable thermal insulation over existing structure (Steico internal woodfibre board)
-  - Ceiling type A - upgraded with suspended ceiling system (in line with Syntegra - Sound Insulation Assessment)\*
-  - Ceiling type B - upgraded with ceiling liner system (in line with Syntegra - Sound Insulation Assessment)\*

\* NB. Particle board to be installed to intermediate floors over existing floorboards, doors to be altered/replaced on a case-by-case basis to accommodate acoustic upgrade

NOTES:

Report all discrepancies, errors and omissions.

Verify all dimensions on site before commencing any work on site or preparing shop drawings.

All materials, components and workmanship are to comply with the relevant British Standards, Codes of Practice and appropriate manufacturers recommendations.

See relevant drawings for all specialist work.

This drawing and design are copyright of James Clague Architects Ltd, company registration number 8664802

Rev	Date	Description
-----	------	-------------

**PLANNING**

NOT FOR CONSTRUCTION

Project Title  
 Alterations and Change of Use for  
 Conversion to an HMO  
 Mr Hare  
 104 High Street  
 Sittingbourne  
 Kent  
 ME10 2AN

Drawing Description  
 Proposed Insulation Diagram  
 First Floor and Second Floor Plan

Scale  
 1:100 at A3

Date  
 October 2023

Drawn By  
 KT

**JAMES CLAGUE**  
 ARCHITECTS

40 / 41 Castle Row  
 Canterbury, Kent CT1 2QY  
 T: 01227 649 073  
 E: info@jamesclague.co.uk  
 W: jamesclague.co.uk

Drawing Number	Revision
25350_PL_36	-



1:100 Scale Bar

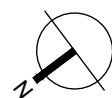

NOTE:  
 Exact dimensions to be measured on site.