

# Proposed Floor Plans

Existing floor area (not including rear extension) = 113.195m<sup>2</sup>

Proposed floor area = 49.174m<sup>2</sup>

Proposed floor area equates to an increase of 43.44%

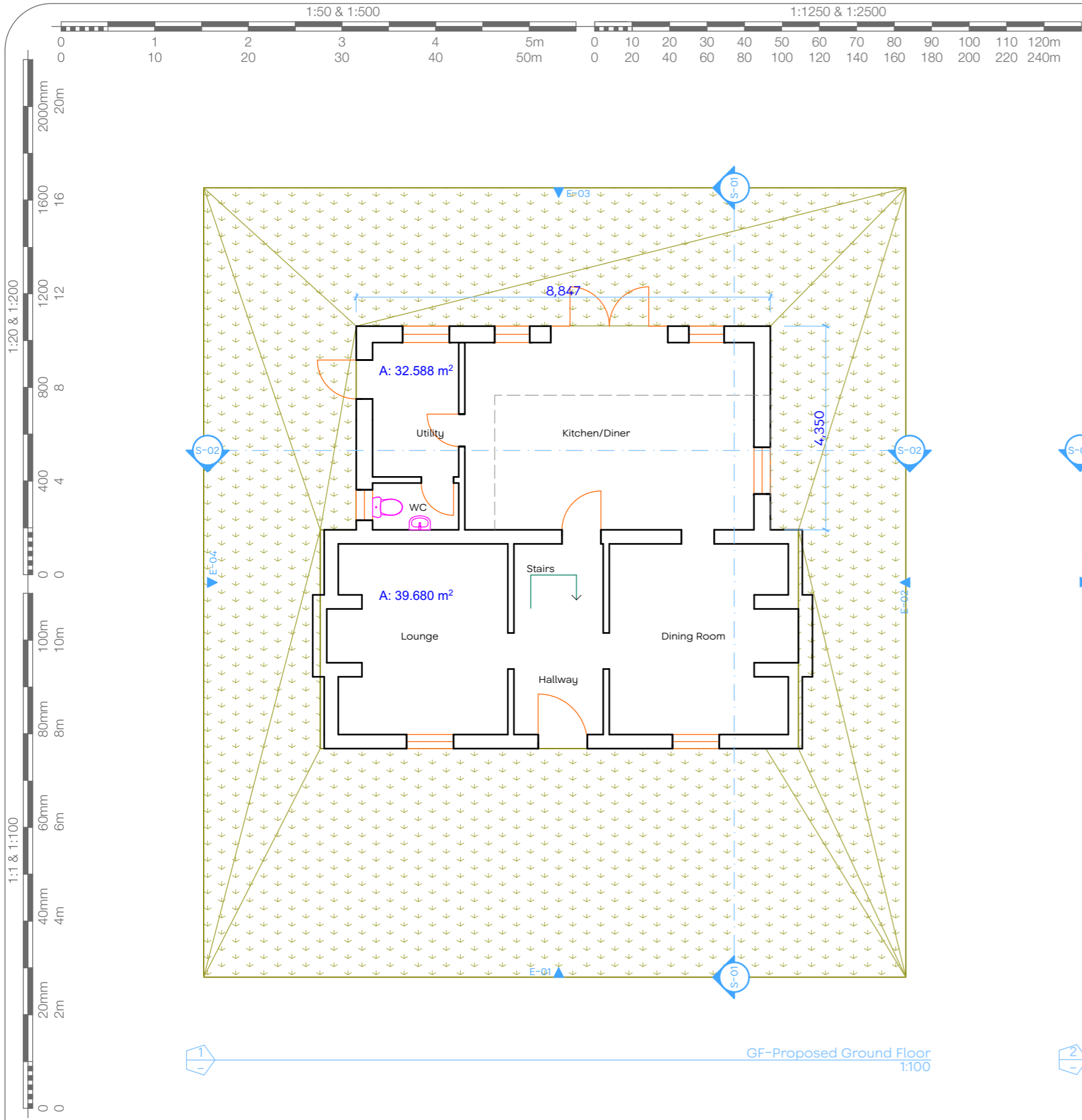

GF-Proposed Ground Floor  
1:100

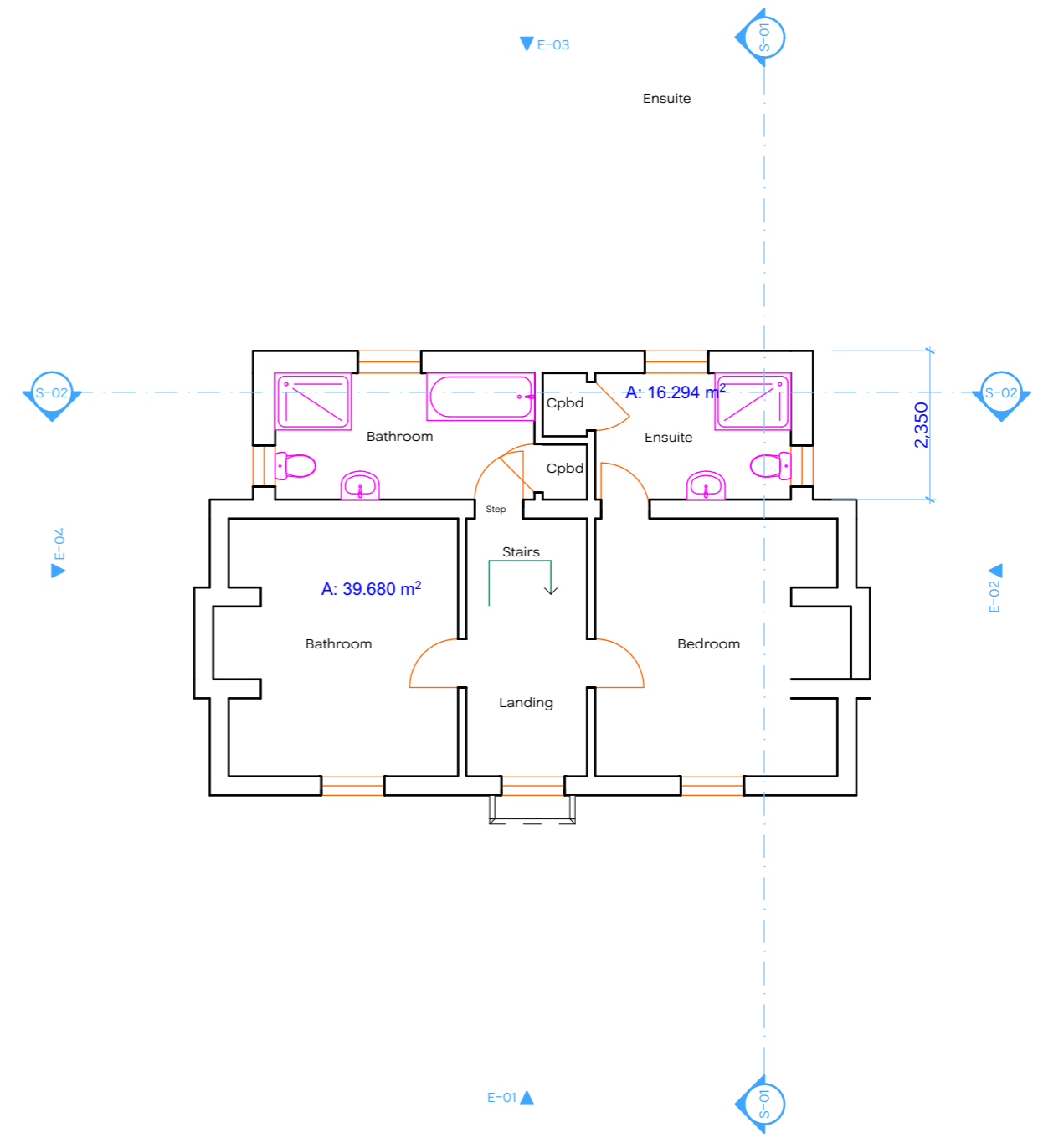

01-Proposed First Floor



Address :-  
Cheesemans House, Luddenham,  
Nr Faversham, Kent, ME13 0TQ

Project :-  
Extension to the rear

Scale :-  
As Marked

Paper Size :-  
A3

Date :-  
Oct 2023

Drawn by :-  
JLRC

Drawing No. :-  
P.03

Revision No :-

Revision Notes :-