

- GENERAL NOTES:
1. Before construction commences, the setting out Engineer shall ensure that all setting out information is mutually compatible with all the drawings and documents provided by the designers. Where information is apparently contradictory or ambiguous, the design Engineer and/or the Architect is to be informed immediately. Thomas Consulting will accept no liability for setting out errors where work is constructed to incorrect information.
 2. All drawings and documents are to be read in conjunction with one another, are mutually compatible and shall be read as such. All documents shall be checked to ensure that they are compatible by the contractor before construction commences. In the event of apparent ambiguity or contradiction the engineer and/or architect shall be notified immediately. Thomas Consulting accept no liability in the event of not being so notified and where construction work has commenced.
 3. In accordance with CDM regulations 2015 this drawing has been prepared with due attention to identifying any unusual design hazards that may exist. Unusual design hazards are hazards that a reasonably competent contractor, experienced in this type of work may not be expected to identify. In dealing with unusual design hazards we have adopted the "ERIC" principle and where possible eliminated (E) the hazard at design stage, if it has not been possible to eliminate the hazard we have endeavoured to reduce (R) it. Where it has not been possible to eliminate these hazards, the hazard is noted on the drawing with appropriate information (I) in order that the hazard can be controlled (C) during construction. It is the contractor's responsibility to fully acquaint themselves with all construction drawings before commencing construction and if in doubt about any matter to ask for clarification from the designer.
 4. All drawings issued electronically for this scheme are provided for the sole purpose of assisting the design, procurement or construction of the structures for which Thomas Consulting has been appointed as Design Engineers/Consultants. They may not be used for any other purpose, nor may they be amended, copied, redistributed or issued to third parties without the written agreement of Thomas Consulting. All drawings remain under copyright to, and the intellectual property of, Thomas Consulting. Upon completion of the project, all drawings are to be deleted from your computer systems and all other electronic copies destroyed. Where electronic copies of final drawings are to be issued, these will be provided in a digital only format by Thomas Consulting (no other copies may be retained). By opening and using this drawing, it is assumed that you agree to abide by these Terms and Conditions.
 5. Unless expressly agreed with a director of Thomas Consulting Ltd, for the purposes of the CDM regulations 2015 Thomas Consulting are not the Principal Designer. The client has been advised that they are required to appoint a Principal Designer. For further information see <http://www.hse.gov.uk/>.

Road 1				
Chainage (m)	Easting (m)	Northing (m)	Level (m)	Curve/Straight
0.000	360168.808	299081.017	234.207	Start
10.000	360169.287	299086.249	234.385	Straight
20.000	360151.754	299091.481	234.340	Straight
30.000	360143.242	299096.712	234.295	Straight
40.000	360134.729	299101.944	234.286	Straight
50.000	360126.218	299107.176	234.326	Straight
60.000	360117.705	299112.408	234.421	Straight
70.000	360109.193	299117.639	234.507	Straight
80.000	360100.681	299122.871	234.610	Straight
81.378	360099.456	299123.562	234.617	Tangent Point
90.000	360100.677	299122.911	234.610	Curve
100.000	360094.945	299130.880	234.524	Curve Radius 13.000
101.655	360095.208	299141.520	234.524	Tangent Point
110.000	360099.469	299148.443	234.792	Straight
120.000	360104.768	299156.943	234.675	Straight
130.000	360110.036	299165.545	234.524	Straight
130.121	360110.100	299165.545	234.586	Tangent Point
140.000	360115.856	299171.175	234.524	Curve
150.000	360122.532	299170.021	234.605	Curve
152.440	360127.912	299169.789	234.609	Tangent Point
160.000	360136.077	299184.425	234.709	Straight
170.000	360144.617	299193.923	234.814	Straight
180.000	360153.157	299154.421	234.818	Straight
181.782	360154.679	299153.494	234.507	End

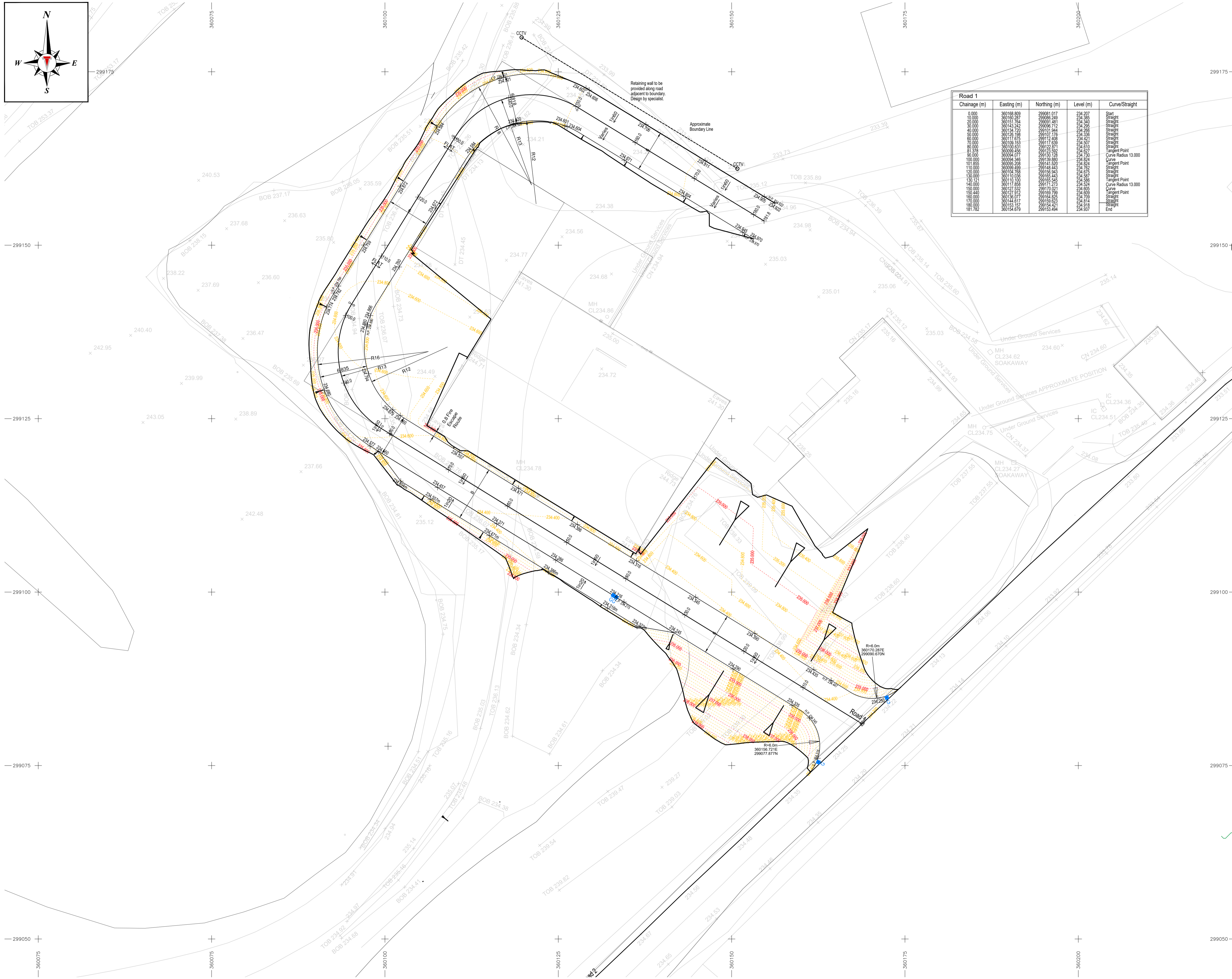

REVISIONS				
REV	DATE	DESCRIPTION	DRAWN BY	CHECKED BY
-	19/10/23	Original Issue	MWJ	-
A	09/11/23	Amending road alignment to suit proposed extent of factory	MWJ	cf
B	15/11/23	Setting out details added.	MWJ	cf
C	16/11/23	CCTV Columns added	MWJ	cf
D	16/11/23	Layby reduced in width. Embankment steepened adjacent to boundary.	MWJ	cf
E	30/11/23	Road levels and crossfalls amended	MWJ	cf
F	01/12/23	Road widened around bends	MWJ	cf
G	05/12/23	Spot levels added in lay-bys	MWJ	cf

DRAWING STATUS:
FOR BUILDING REGULATION APPROVAL

Offices in **Charley, Lancaster, Shrewsbury & London**
Tel: 01743 237940
e-mail: info@thomasconsulting.co.uk

CLIENT:
LIME GREEN PRODUCTS LTD

PROJECT:
NEW ACCESS ROAD AND DRAINAGE

DRAWING TITLE:
ACCESS ROAD GENERAL ARRANGEMENT

DATE CREATED:	DRAWING SCALE:	DRAWN BY:	CHECKED BY:	QA CATEGORY:
19/10/2023	1:250	MWJ	-	1

DRAWING REF:	REV:
TC / T20775 / 23 / 120	G

© Thomas Consulting Ltd 2013. Thomas Consulting is a registered company in England & Wales. Registered Office: 15, The Old Rectory, Church Lane, Charley, Lancaster, LA4 4JG. Thomas Consulting Ltd. Registered in England & Wales. Company No. 07025927